

Art. 982 Cast iron beam clamp "C"

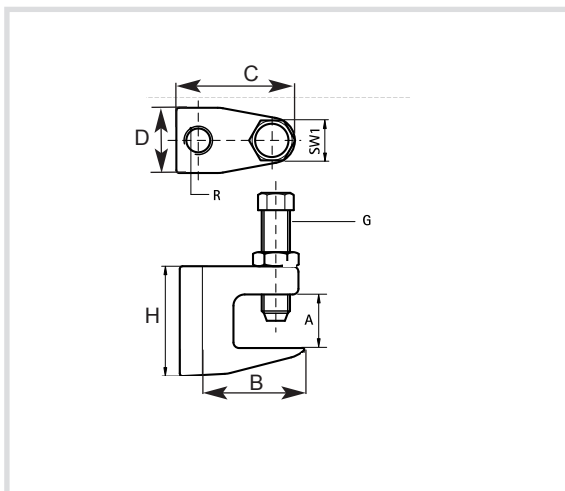

Technical specifications and advantages

- Certificate
- For solid fastening to steel structures without welding or drilling
- Bolt with hexagonal head according to the DIN933, class 8.8, pointed screw with ring according to EN ISO 4753
- Hardened steel screw with hexagonal head, cone point, DIN 439 hexagonal nut, galvanised
- Material: clamp in cast iron, screw in hardened steel, nut in galvanised steel



Code	A [mm]	C [mm]	R	G	B [mm]	H [mm]	D [mm]	Payload [N]
982008	18	38	M8	M8	21	35	19	1200
982010	20	44	M10	M10	23	42	21	2500
982012	26	58	M12	M10	32	54	23,5	3500
982016	28	58	M16	M12	26	58	29,5	5500
982908	18	38	9mm	M8	21	35	19	1200
982910	20	44	11mm	M10	23	42	21	2500
982912	26	58	13mm	M10	32	54	23,5	3500

