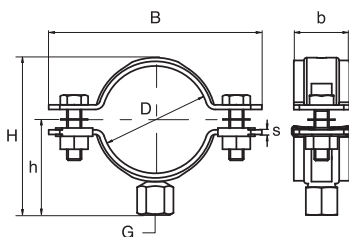

Art. 648N Stovepipe clamp - black

Technical specifications and advantages

- Material: steel
- Galvanised and painted
- M8 nut
- LDPE packs, 2 pieces per pack
- 10x60 anchor
- Hanger bolt M8x180

Code	Measure. Ø [mm]	B [mm]	H [mm]	h [mm]	b x s [mm]	Payload [N]
648N060	60	-	-	-	24 x 1,5	255
648N080	76 - 80	101	78	42	24 x 1,5	255
648N100	100	150	98	52	24 x 1,5	255

Art. 647 Clamp for telescopic smoke pipe

Technical specifications and advantages

- Suitable for all diameters up to 200
- Material: steel
- Galvanised, painted white

Code	Measurements Ø [mm]	Tie rod Ø x L	Anchor Ø x L
647200	80 - 140	18 x 0,5	8 x 40
647240	140 - 200	18 x 0,5	8 x 40