

Art. 827 CorSTRUT cantilever arm

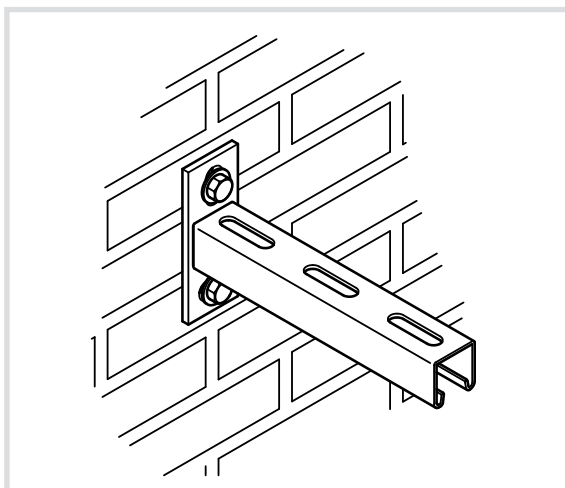

Technical characteristics and advantages

- Made of S235JR steel
- Galvanised
- CO₂ welding
- Slots on the plate at 90° to simplify assembly
- They can also be supplied hot-dip galvanised

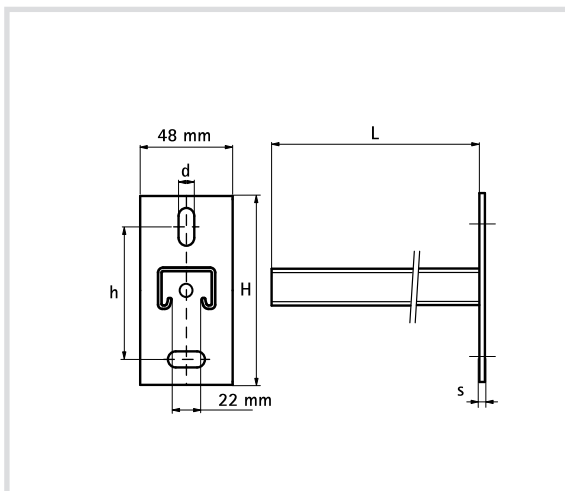

| Code | L [mm] | H [mm] | h [mm] | Fixing rail | s [mm] | Holes [mm] |
|---------------|--------|--------|--------|-------------|--------|------------|
| 827220 | 200 | 110 | 70,0 | 41x21x2,5 | 5,0 | 25x11 |
| 827230 | 300 | 110 | 70,0 | 41x21x2,5 | 5,0 | 25x11 |
| 827330 | 300 | 130 | 87,5 | 41x41x2,0 | 7,0 | 30x13 |
| 827345 | 450 | 130 | 87,5 | 41x41x2,0 | 7,0 | 30x13 |
| 827360 | 600 | 130 | 87,5 | 41x41x2,0 | 7,0 | 30x13 |
| 827020 | 200 | 130 | 87,5 | 41x41x2,5 | 7,0 | 30x13 |
| 827030 | 300 | 130 | 87,5 | 41x41x2,5 | 7,0 | 30x13 |
| 827045 | 450 | 130 | 87,5 | 41x41x2,5 | 7,0 | 30x13 |
| 827060 | 600 | 130 | 87,5 | 41x41x2,5 | 7,0 | 30x13 |
| 827075 | 750 | 130 | 87,5 | 41x41x2,5 | 7,0 | 30x13 |
| 827100 | 1000 | 130 | 87,5 | 41x41x2,5 | 7,0 | 30x13 |
| 827120 | 1200 | 130 | 87,5 | 41x41x2,5 | 7,0 | 30x13 |