

Art. 8630200 CorSTRUT wall plate, rail 41x62, 41x82 41x(2x41) with pre-assembled bolts

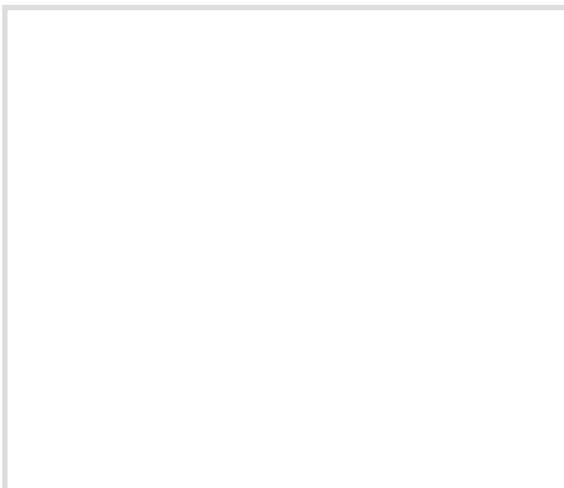

Technical specifications and advantages

- Made with 1.0332 steel
- CO₂ welding
- Hot-dip galvanised
- Suitable for CorSTRUT fixing rail 41x62, 41x82, 41x(2x41)
- With pre-assembled bolts
- Slots on the base at 90° to simplify assembly

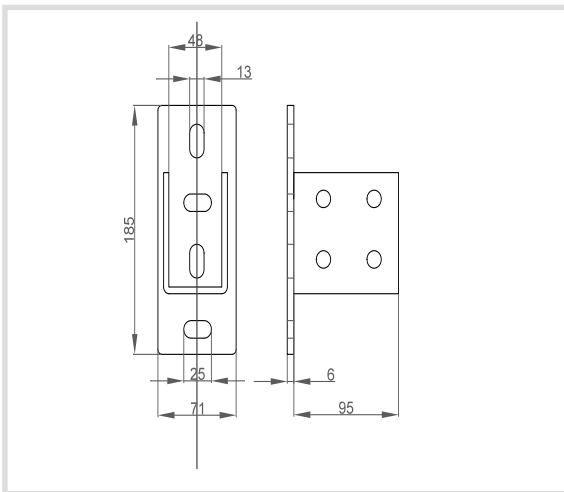

Code	Fixing rails
8630200	4x62, 41x82, 41x(2x41)