

Art. 901R CorSTRUT flat washer - AISI 316

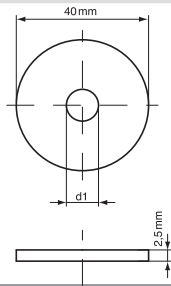

### Technical specifications and advantages

- Flat washer
- For STRUT fixing rail
- In AISI 316 stainless steel
- Tested for fire resistance



Code	For	d1 Ø [mm]
<b>901R508</b>	STRUT	8,5
<b>901R510</b>	STRUT	10,5
<b>901R512</b>	STRUT	13,0
<b>901R516</b>	STRUT	17,0

Art. 9016R C-washer for CorSTRUT fixing rail - AISI 316



### Technical specifications and advantages

- For STRUT fixing rails
- AISI 316
- Adds stability to fixing rail structures

Code	For	d1 [mm]
<b>9016R10</b>	STRUT	11,0
<b>9016R12</b>	STRUT	13,0

