

Art. 901R CorSTRUT flat washer - AISI 316

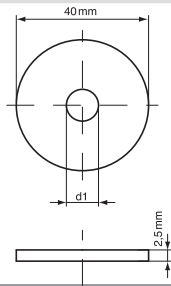

Technical specifications and advantages

- Flat washer
- For STRUT fixing rail
- In AISI 316 stainless steel
- Tested for fire resistance



Code	For	d1 Ø [mm]
901R508	STRUT	8,5
901R510	STRUT	10,5
901R512	STRUT	13,0
901R516	STRUT	17,0

Art. 9016R C-washer for CorSTRUT fixing rail - AISI 316



Technical specifications and advantages

- For STRUT fixing rails
- AISI 316
- Adds stability to fixing rail structures

Code	For	d1 [mm]
9016R10	STRUT	11,0
9016R12	STRUT	13,0

