

Art. 98xxx Sliding saddle without bracket – extra heavy loads

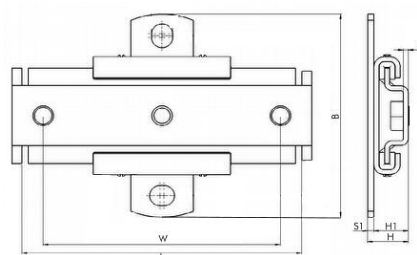

Technical specifications and advantages

- Sliding saddle for thermal expansion
- Material: steel
- Galvanised
- Polyamide sliding guide



With bracket

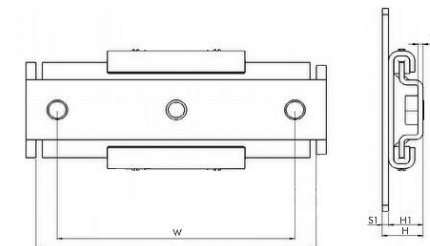

Without bracket

| Code | Ø Holes [mm] | L [mm] | Hole spacing W [mm] | S1 [mm] | S [mm] | H1 [mm] | B [mm] | Max load with floor or ceiling fastening [mm] | Max sliding length [mm] |
|---------------|--------------|--------|---------------------|---------|--------|---------|--------|---|-------------------------|
| 983300 | 12,5 | 170 | 154 | 4 | 2,5 | - | 145 | 1520 | 65 |
| 980300 | 12,5 | 170 | 154 | - | 2,5 | 20 | - | 1520 | 65 |
| 981116 | 16,5 | 240 | 224 | - | 4 | 27,5 | - | 5980 | 110 |