

# Fissaggi 01



## CorSTRUT and components



8125  G 2	812520  G 3	827  G 4	8692  G 5	G 2 CorSTRUT fixing rails G 3 Slotted CorSTRUT fixing rail G 4 CorSTRUT cantilever arm G 5 CorSTRUT double cantilever arm G 6 Hot-dip galvanised CorSTRUT cantilever arm with rail prop G 7 Support for CorSTRUT with side holes G 8 Rail prop for CorSTRUT G 9 Angle bracket G 10 CorSTRUT wall plate with side holes and pre-assembled bolts G 11 CorSTRUT wall plate, rail 41x62, 41x82 41x(2x41) with pre-assembled bolts G 12 CorSTRUT adjustable wall plate G 13 Wall plate for CorSTRUT structures G 13 CorSTRUT wall plate with square base G 14 Wall plate for double CorSTRUT fixing rail G 15 Open fixing rail support for CorSTRUT with pre-assembled bolts G 16 Slide nut for CorSTRUT G 17 Slide nut for CorSTRUT with steel spring and washer G 18 CorSTRUT slide nut with spring G 19 CorSTRUT slide nut with spring on top G 20 Slide nut with threaded pin for CorSTRUT G 21 Slide nut with threaded pin for CorSTRUT G 22 Ball swivel hangers CorSTRUT with height adjuster G 22 Adjustable universal brace G 23 Universal brace for M10/M12 threaded rods G 23 CorSTRUT square slide nut G 24 Washer for CorSTRUT G 24 U-shaped complement (washer) for CorSTRUT G 24 Square washer for CorSTRUT G 25 90° and 45° angle brackets including slide nuts and bolts G 26 90° angle brackets with two holes G 27 90° angle brackets with three holes G 28 Angle brackets with 3 and 4 holes at 90°	
8694  G 6	8693  G 7	8693  G 8	8691200  G 9		
8630000  G 10	8630200  G 11	8691000  G 12	8634  G 13		
8634141  G 13	8633  G 14	86320  8632001 8632002 G 15	861  G 16		
86111  G 17	862  G 18	869  G 19	866  G 20		
6527  G 21	6653  G 22	86351  G 22	86010  G 23	901816  G 23	9015  G 24
9016  G 24	9017  G 24	6658  G 25	8600  G 26	8600903  G 27	8615  G 28

# Fissaggi 01



## CorSTRUT and components

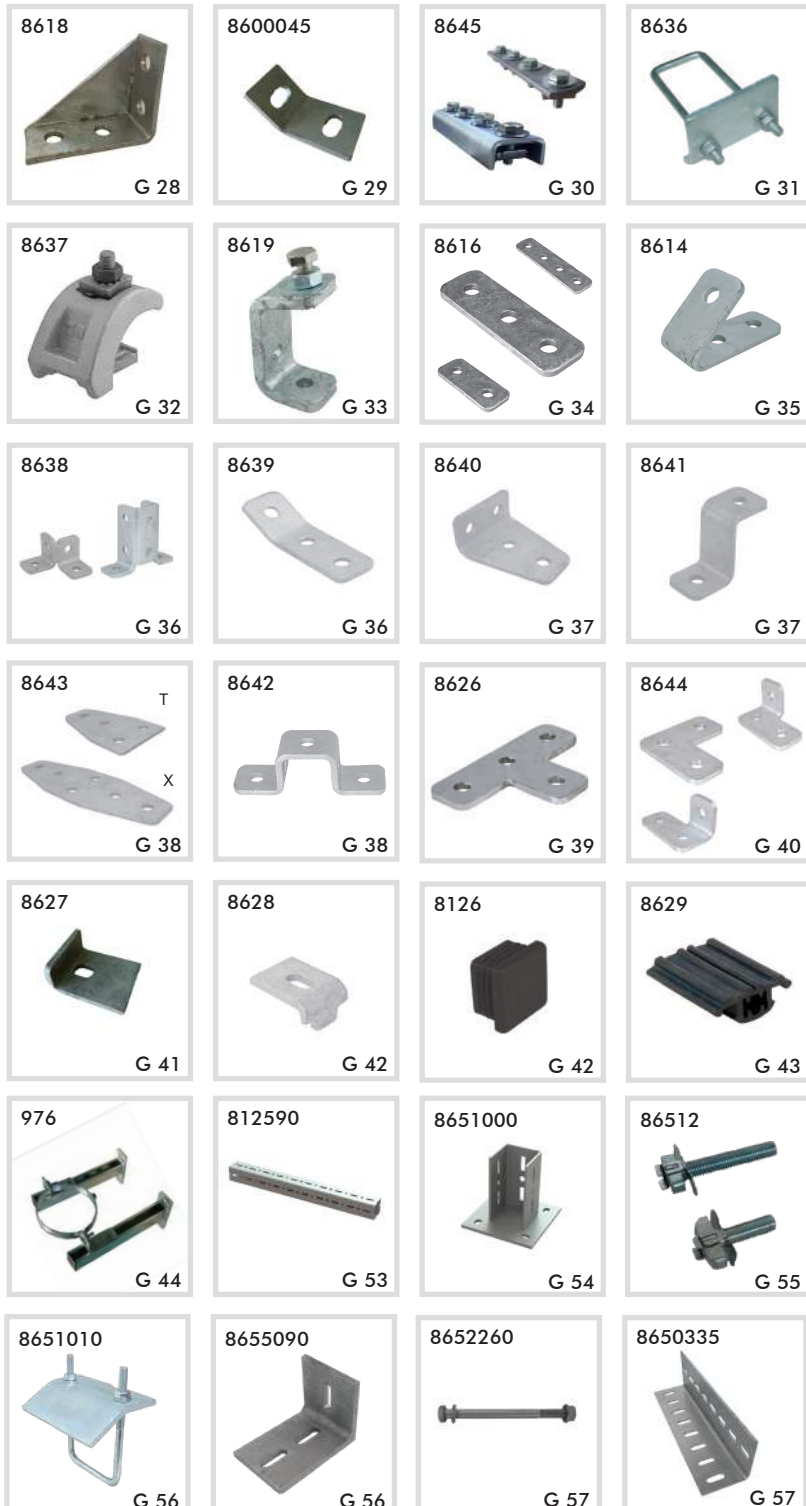

- G 28 Reinforced 90° angle bracket
- G 29 45° slotted angle bracket
- G 30 CorSTRUT rail connector including slide nuts and bolts
- G 31 CorSTRUT rail beam clamp
- G 32 Clamp for fixing to beams
- G 33 CorSTRUT clamp for fixing to beam
- G 34 CorSTRUT straight connection
- G 35 Angle bracket with 3 holes
- G 36 90° connections
- G 36 Open connector
- G 37 135° and 90° angled T-connection
- G 37 Z connection
- G 38 T and X connections
- G 38 Rail connector
- G 39 Angle brackets
- G 40 Rail connectors
- G 41 Fixing for CorSTRUT fixing rails
- G 42 Fixing with insert for CorSTRUT fixing rails
- G 42 End cap for CorSTRUT fixing rails
- G 43 EPDM sheath for soundproofing of fixing rails and threaded rods
- D 44 Downpipe bracket
- G 53 Square fixing rail 100x100
- G 54 Wall plate for square fixing rail
- G 55 Slide nut with pin for square fixing rail
- G 56 Beam clamp for square fixing rail
- G 56 90° angle bracket for square fixing rail
- G 57 Through bolt for square fixing rail
- G 57 Connector for square fixing rail

# CorSTRUT applications



# CorSTRUT applications and expansion components



### CorSTRUT fixing rail technical details

#### Table of properties

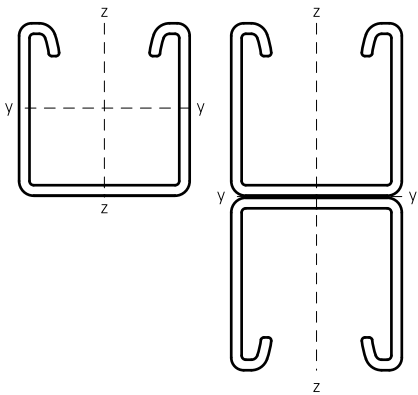

Type (3 m)	Weight [kg/m]	Moment of inertia		Static moment	
		$I_y$	$I_z$	$W_y$	$W_z$
41x21 - 1,5	1,15	0,78	3,70	0,72	1,80
41x41 - 1,5	1,65	4,46	6,20	2,12	3,00
41x21 - 2,0	1,78	1,01	5,40	0,93	2,61
41x41 - 2,0	2,35	5,34	7,79	2,56	3,77
41x41 - 2,5	2,45	6,26	9,30	2,97	4,50
41x62 - 2,5	3,33	18,03	13,20	5,75	6,39
41x82 - 2,5	4,08	37,31	16,89	9,00	8,18

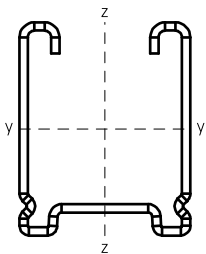

#### CorSTRUT - 1,5 mm

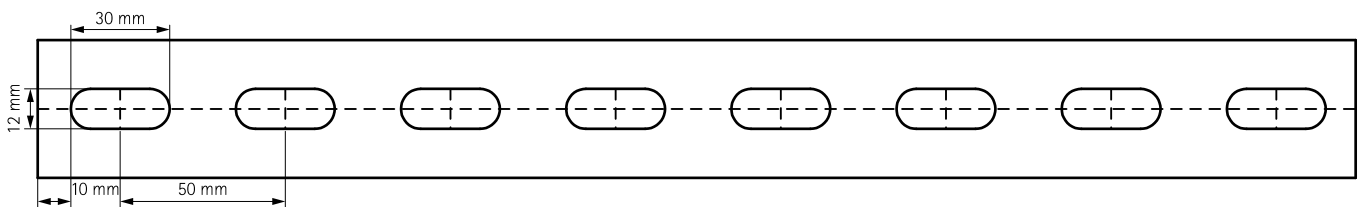

#### CorSTRUT - 2,0 / 2,5 mm

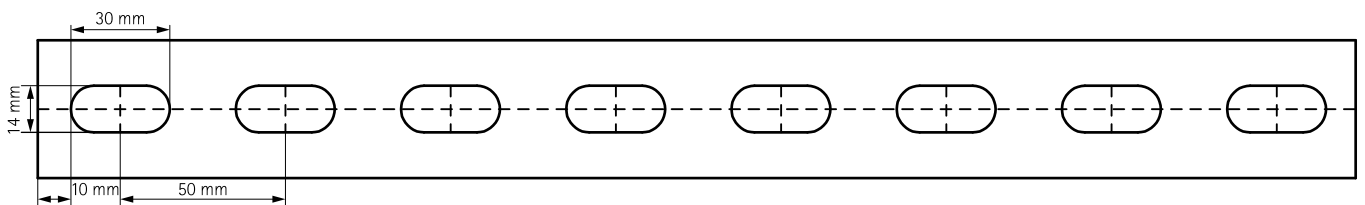

### Art. 8125 CorSTRUT fixing rail



#### Technical specifications and advantages

- Made of pre-galvanised S235JR steel
- The distance between the end of the fixing rail and the first hole is always the same
- Available with hot-dip galvanisation (upon request)
- Tested for safety against fire
- Plasticity load: 240 N/mm<sup>2</sup>
- With notches on the inside for greater adhesion of the components
- For information on the maximum permitted loads, refer to the load tables

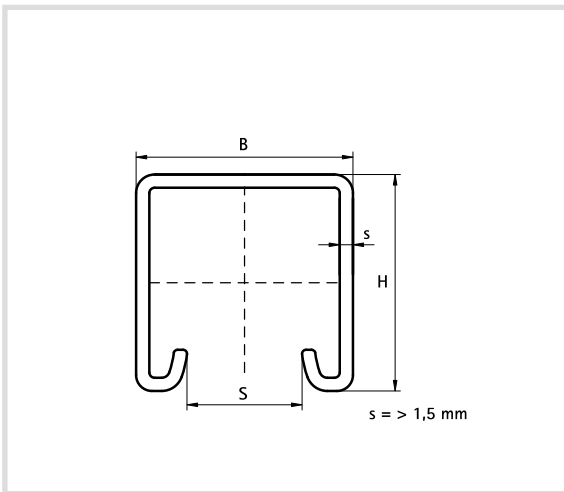

Code	Measurements B x H [mm]	Thickness (s) [mm]	Length [mm]	S [mm]
<b>CorSTRUT Fixing rails</b>				
812501	41 x 21	1,5	3000	22
812502	41 x 21	2,0	3000	22
812504	41 x 41	1,5	3000	22
812505	41 x 41	2,0	3000	22
812508	41 x 41	2,5	3000	22
812509	41 x 41	2,0	6000	22
812511	41 x 62	2,5	3000	22
812512	41 x 62	2,5	6000	22
812514	41 x 82	2,5	3000	22
<b>Double CorSTRUT fixing rails</b>				
812526	41 (2x41)	2,5	3000	22
812528	41 (2x62)	2,5	3000	22

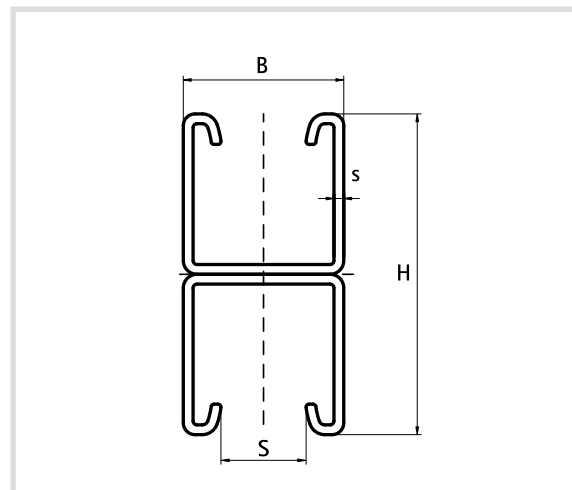

Art. 812520 Slotted CorSTRUT fixing rail



*Technical specifications and advantages*

- Made of pre-galvanised S235JR steel
- The distance between the end of the fixing rail and the first hole is always the same
- Available with hot-dip galvanisation (upon request)
- Tested for safety against fire
- With notches on the inside for greater adhesion of the components
- Slotted on all sides of the fixing rail

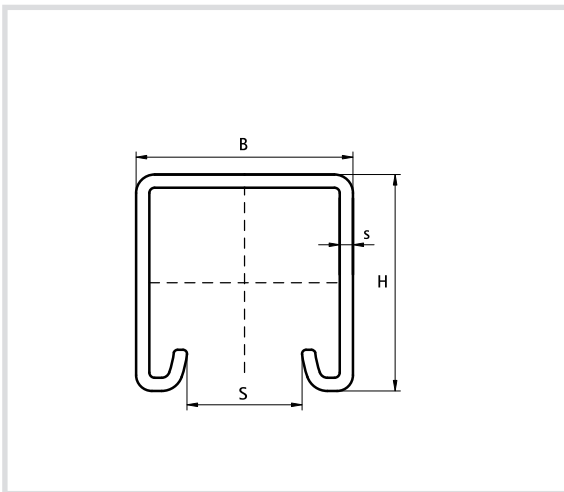

Code	Measurements B x H [mm]	Thickness (s) [mm]	Length [mm]	S [mm]
<b>812520</b>	41 x 41	2,5	3000	22

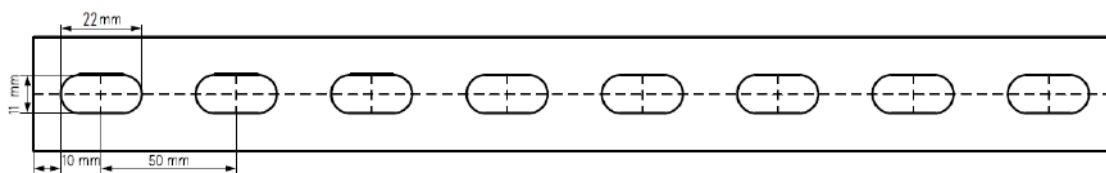

### Art. 827 CorSTRUT cantilever arm



#### Technical characteristics and advantages

- Made of S235JR steel
- Galvanised
- CO<sub>2</sub> welding
- Slots on the plate at 90° to simplify assembly
- They can also be supplied hot-dip galvanised

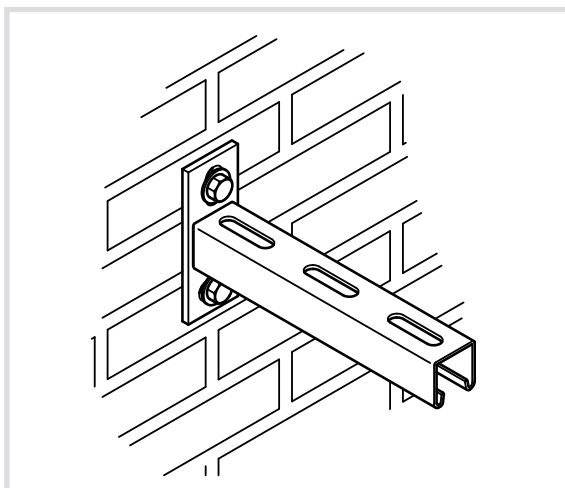
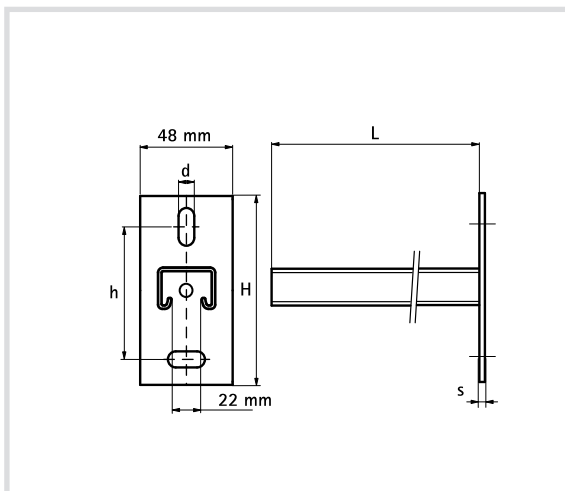

Code	L [mm]	H [mm]	h [mm]	Fixing rail	s [mm]	Holes [mm]
<b>827220</b>	200	110	70,0	41x21x2,5	5,0	25x11
<b>827230</b>	300	110	70,0	41x21x2,5	5,0	25x11
<b>827330</b>	300	130	87,5	41x41x2,0	7,0	30x13
<b>827345</b>	450	130	87,5	41x41x2,0	7,0	30x13
<b>827360</b>	600	130	87,5	41x41x2,0	7,0	30x13
<b>827020</b>	200	130	87,5	41x41x2,5	7,0	30x13
<b>827030</b>	300	130	87,5	41x41x2,5	7,0	30x13
<b>827045</b>	450	130	87,5	41x41x2,5	7,0	30x13
<b>827060</b>	600	130	87,5	41x41x2,5	7,0	30x13
<b>827075</b>	750	130	87,5	41x41x2,5	7,0	30x13
<b>827100</b>	1000	130	87,5	41x41x2,5	7,0	30x13
<b>827120</b>	1200	130	87,5	41x41x2,5	7,0	30x13



Art. 8692 CorSTRUT double cantilever arm



*Technical specifications*

- Made of steel
- Slots at 90° on the plate
- Tested for fire resistance
- Hot galvanised

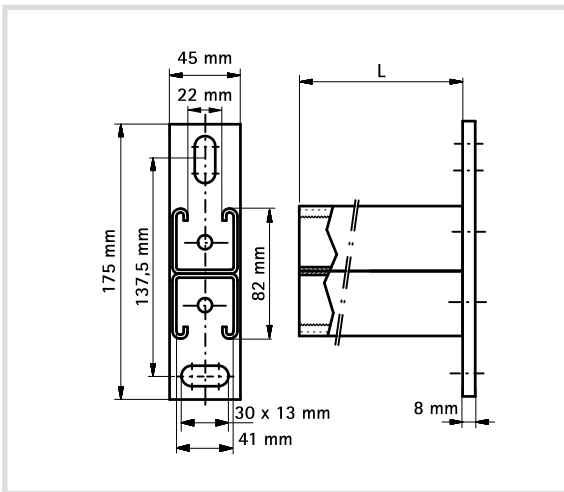

Code	L [mm]	Fixing rail
<b>8692450</b>	450	41 x (2x41) x2,5
<b>8692600</b>	600	41 x (2x41) x2,5
<b>8692750</b>	750	41 x (2x41) x2,5
<b>8692999</b>	1000	41 x (2x41) x2,5



Art. 8694 Hot-dip galvanised CorSTRUT cantilever arm with rail prop



*Caratteristiche tecniche*

- Made of 1.0332 steel
- Hot galvanised
- With CO<sub>2</sub> welded rail prop

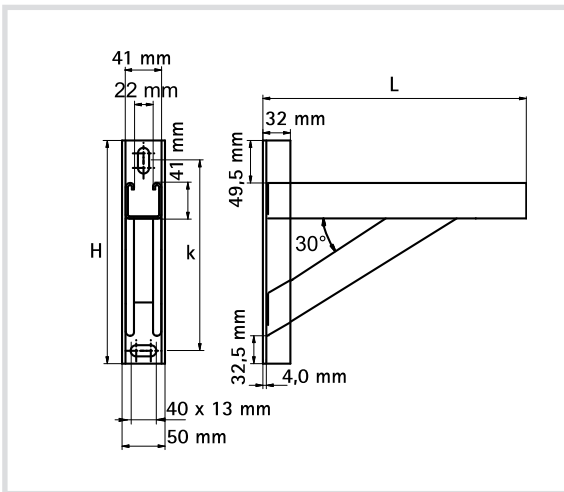

Code	L [mm]	H [mm]	Fixing rail	k [mm]
<b>8694060</b>	600	350	41 x 41	311,5

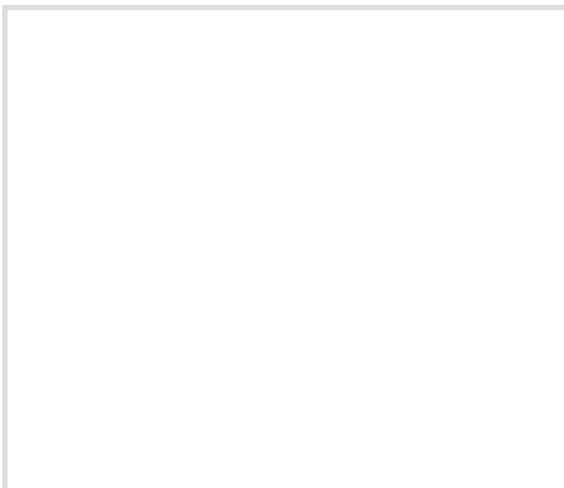

Art. 8693 Support for CorSTRUT with side holes



*Technical specifications*

- Made with 1.0332 steel
- CO<sub>2</sub> welding
- To increase the load by fixing above or below the cantilever arm
- 45° inclination

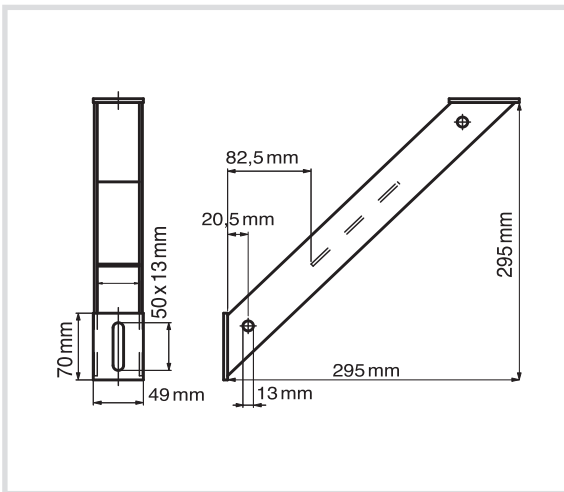

Code	For
<b>8693300</b>	CorSTRUT and CH35 (38x40)

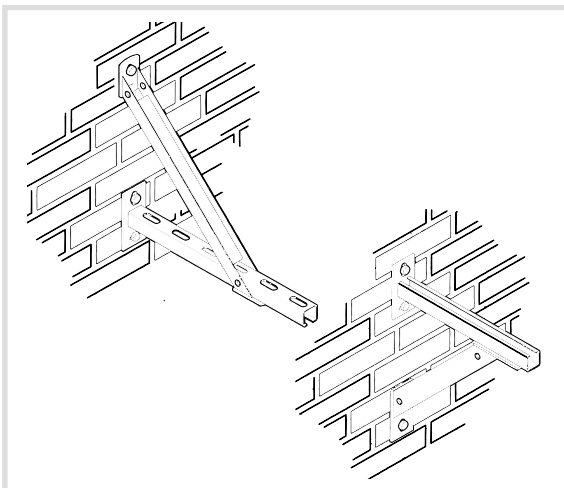

Art. 8693 Rail prop for CorSTRUT



*Technical specifications and advantages*

- Made with S235JR steel
- Galvanised
- CO<sub>2</sub> welding
- Made using Strut fixing rail
- To increase the load by fixing above or below the cantilever arm
- 45° inclination
- Very elongated slot to ensure the correct coupling is used with the holes of the cantilever arm

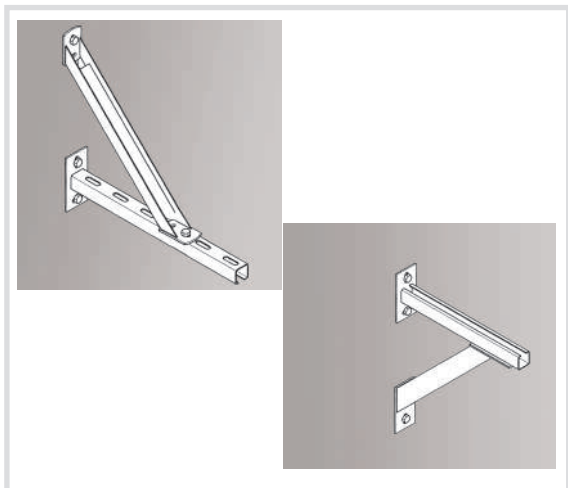
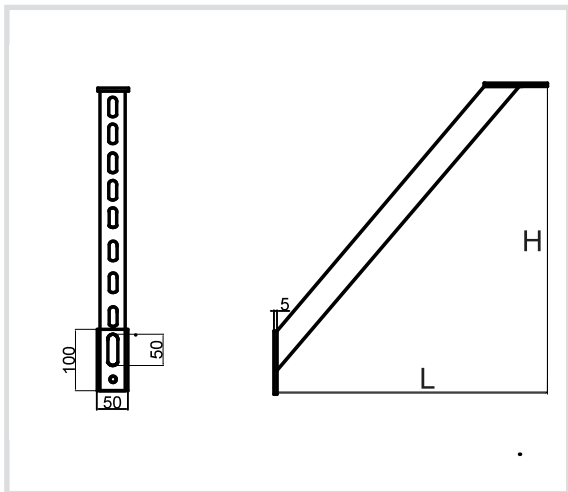

Code	L [mm]	H [mm]	Slotted hole [mm]
<b>8693340</b>	340	340	50x13
<b>8693510</b>	540	540	50x13

Art. 8691200 Angle bracket



*Technical specifications and advantages*

- Support in one piece
- To reinforce a cantilever arm by fixing it from below, above or to the side
- Material: steel, 1.0332

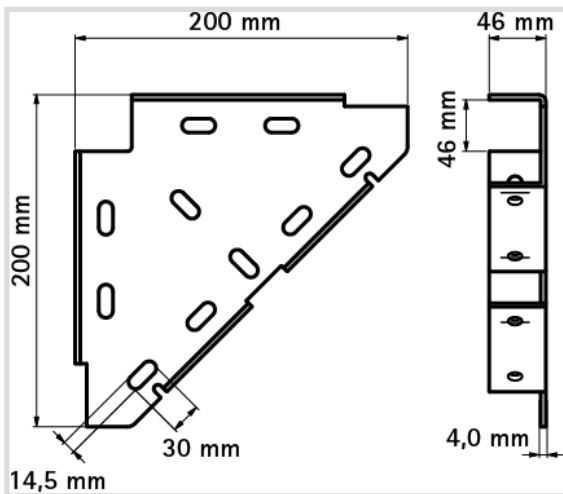

Code	Fixing rail	Dimensions [mm]
8691200	CorSTRUT and CH35	200x200

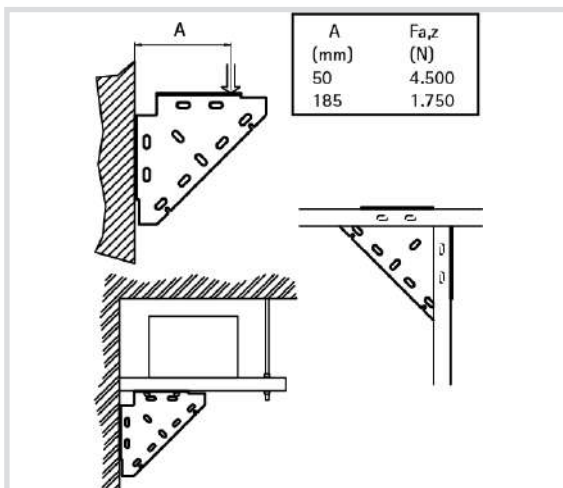

Art. 8630000 CorSTRUT wall plate with side holes and pre-assembled bolts

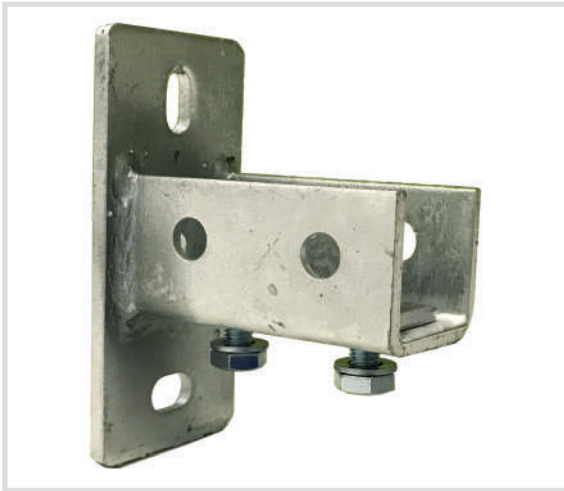

*Technical specifications and advantages*

- Made with 1.0332 steel
- Slots on the base at 90° to simplify assembly
- Hot-dip galvanised
- Tested for fire resistance
- With pre-fitted bolts

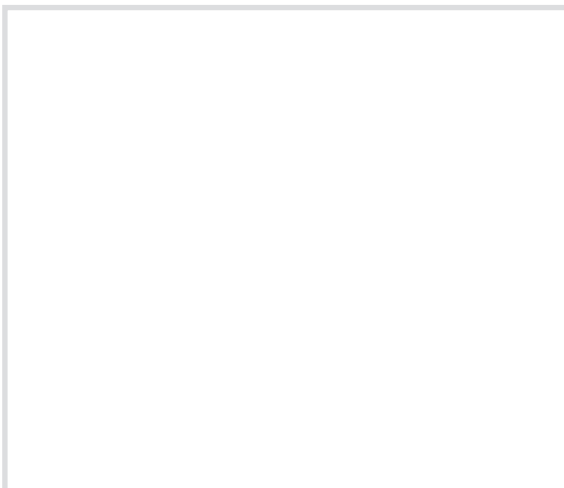
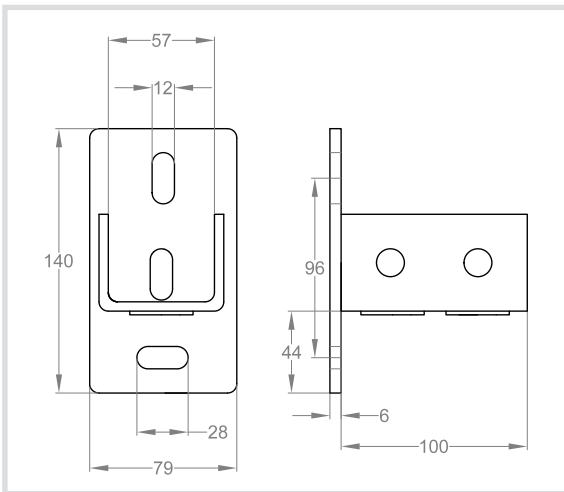

Code	Fixing rails
<b>8630000</b>	41x21 e 41x41

Art. 8630200 CorSTRUT wall plate, rail 41x62, 41x82 41x(2x41) with pre-assembled bolts



*Technical specifications and advantages*

- Made with 1.0332 steel
- CO<sub>2</sub> welding
- Hot-dip galvanised
- Suitable for CorSTRUT fixing rail 41x62, 41x82, 41x(2x41)
- With pre-assembled bolts
- Slots on the base at 90° to simplify assembly

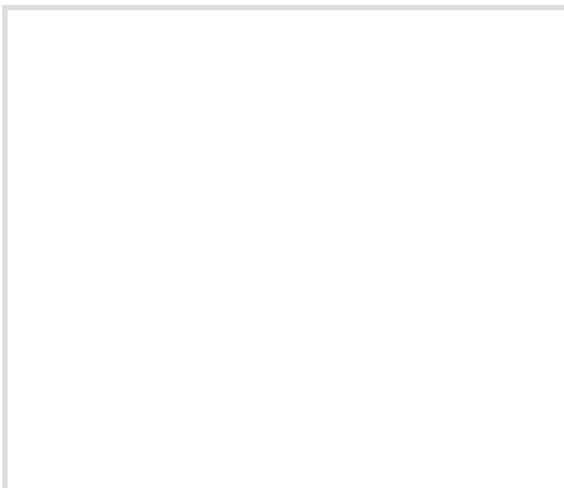
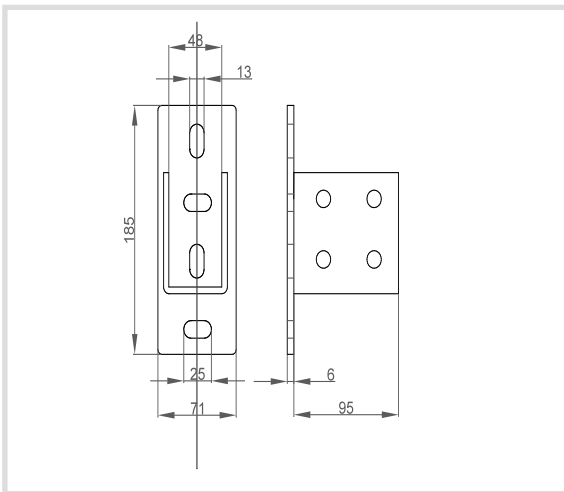

Code	Fixing rails
<b>8630200</b>	4x62, 41x82, 41x(2x41)

Art. 8691000 CorSTRUT adjustable wall plate



### Technical specifications and advantages

- Made with 1.0332 steel
- CO<sub>2</sub> welding
- Adjustable for any fixing rail inclination
- Suitable for any CorSTRUT fixing rail

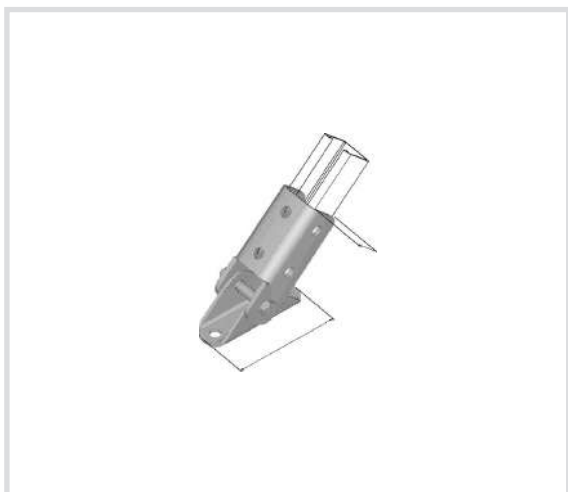
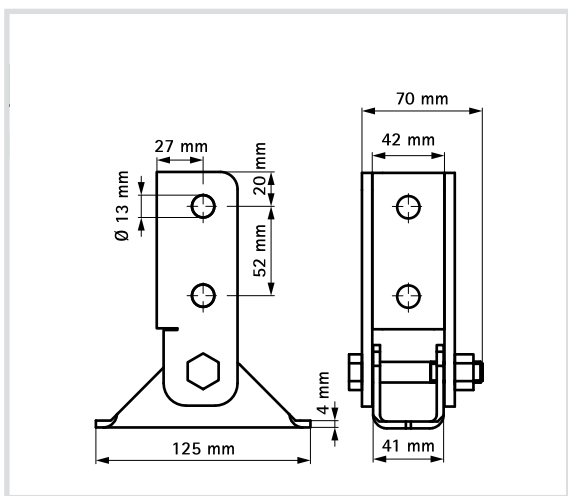

Code	Fixing rails
8691000	CorSTRUT



Art. 8634 Wall plate for CorSTRUT structures



*Technical specifications and advantages*

- Made with 1.0332 steel
- CO<sub>2</sub> welding
- Slots on the base at 90° to simplify assembly
- Hot-dip galvanised

Code	Fixing rail
<b>8634041</b>	41x41
<b>8634062</b>	41x62
<b>8634082</b>	41x82

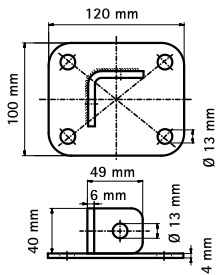

**8634041**

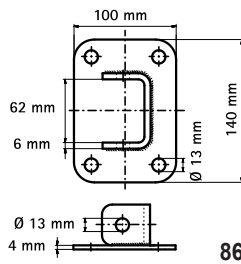

**8634062**

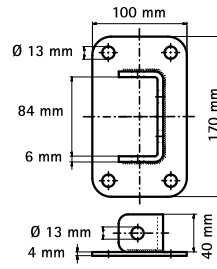

**8634082**

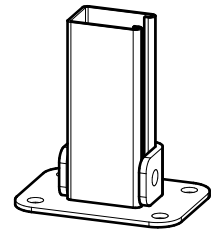

Art. 8634141 CorSTRUT wall plate with square base

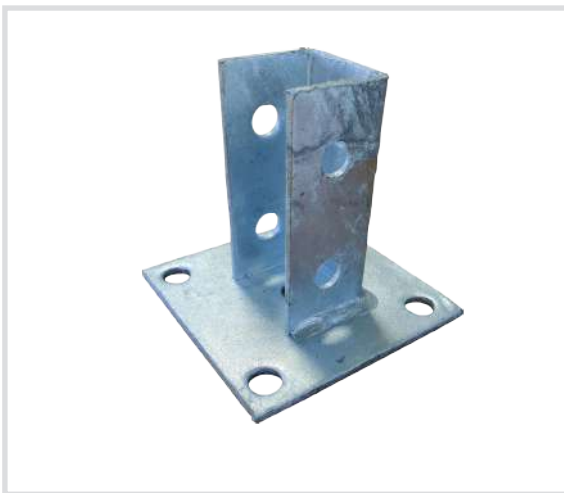

*Technical specifications and advantages*

- Made with 1.0332 steel
- Hot-dip galvanised
- Base with 4 holes
- The lateral holes allow assembly of the CorSTRUT fixing rail in any orientation
- CO<sub>2</sub> welding

Code	Fixing rail
<b>8634141</b>	41x41

Art. 8633 Wall plate for double CorSTRUT fixing rail



*Technical specifications and advantages*

- Made with 1.0332 steel
- Hot-dip galvanised
- CO<sub>2</sub> welding
- Slots on the base at 90° to simplify assembly

Code	Fixing rail
8633041	41x41
8633082	41x82

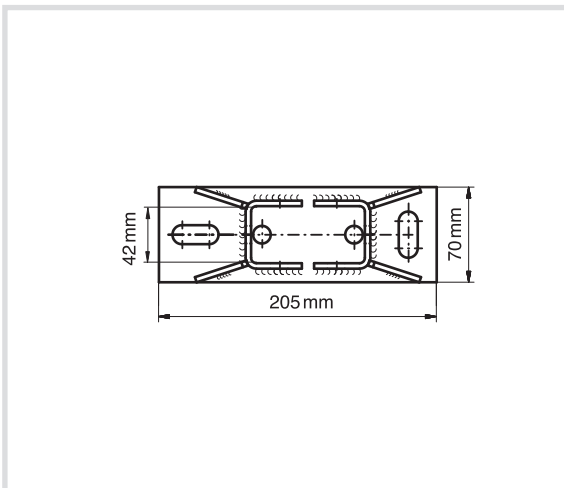
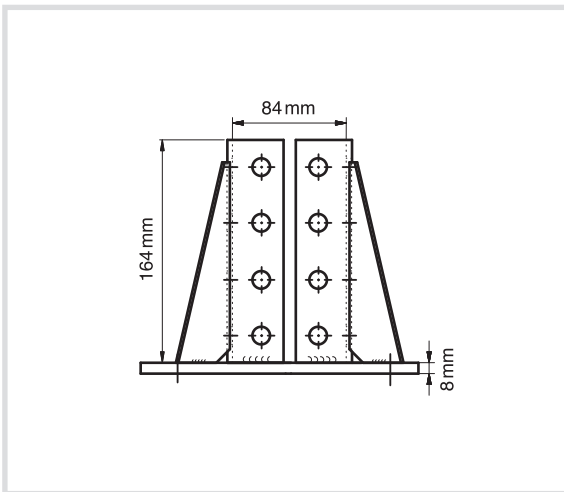

Art. 86320 Open fixing rail support for CorSTRUT with pre-assembled bolts

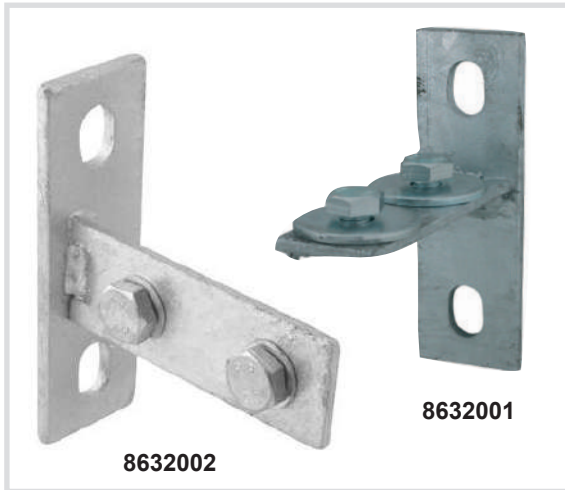

*Technical specifications*

- With pre-assembled nuts
- Material: 1.0332 steel
- Hot-dip galvanised

Code	Fixing rail
<b>8632001</b>	41x41
<b>8632002</b>	41x41

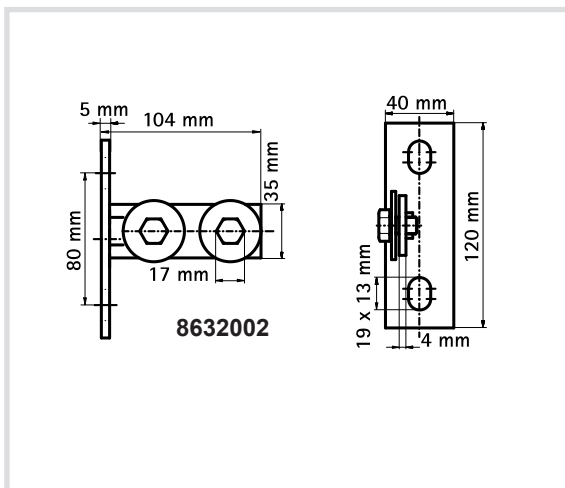
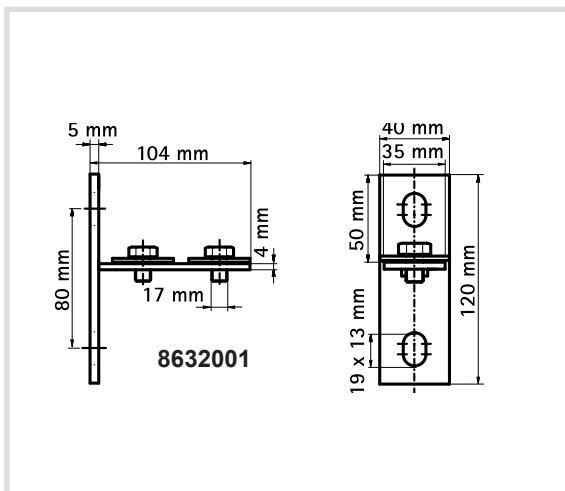

### Art. 861 Slide nut for CorSTRUT

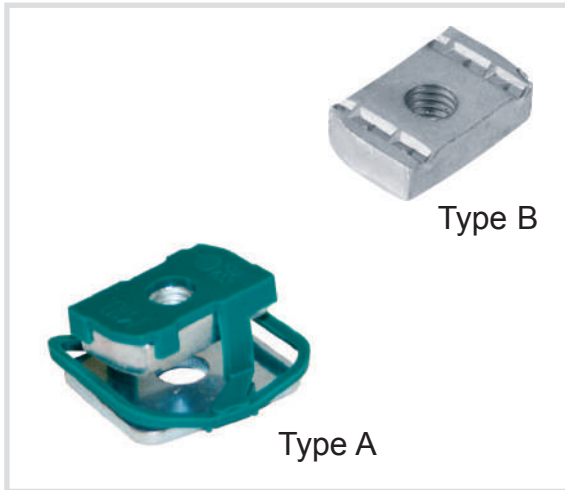

#### Technical specifications and advantages

- Made with 1.0332 steel
- With pre-assembled plastic spring for easy assembly
- Spring in polyoxymethylene (POM), green (RAL 6026)
- Tested for fire resistance

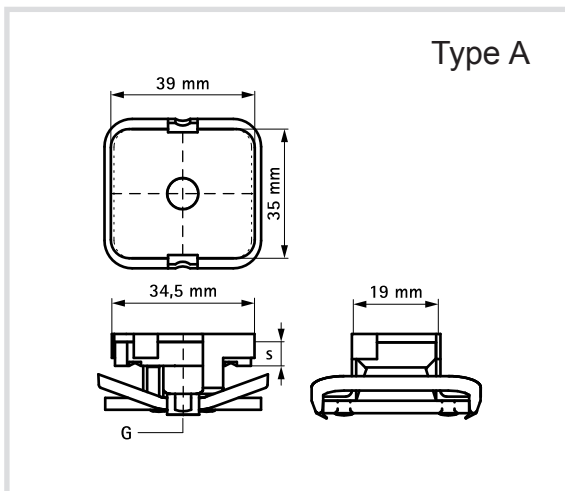

Code	G	Type	s [mm]	Payload [N]
<b>8610006</b>	M6	A	6,0	6000
<b>8610008</b>	M8	A	6,0	6000
<b>8610010</b>	M10	A	8,0	9500
<b>8610012</b>	M12	A	9,0	10000
<b>8611006</b>	M6	B	5,0	5300
<b>8611008</b>	M8	B	6,0	6000
<b>8611010</b>	M10	B	8,0	9500
<b>8611012</b>	M12	B	9,0	10000

#### HOT GALVANISED

<b>8612006</b>	M6	B	5,0	5300
<b>8612008</b>	M8	B	6,0	6000
<b>8612010</b>	M10	B	8,0	9500
<b>8612012</b>	M12	B	9,0	10000

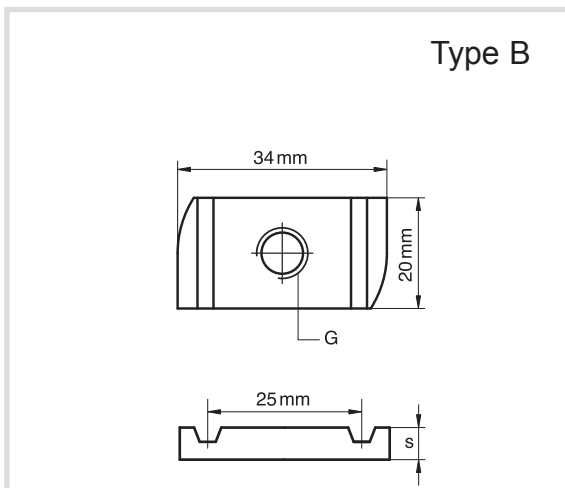

Art. 86111 Slide nut for CorSTRUT with steel spring and washer



*Technical specifications*

- Made with 1.0332 steel
- With pre-assembled steel spring for easy assembly
- Tested for fire resistance

Code	G	H [mm]
<b>8611106</b>	M6	6
<b>8611108</b>	M8	6
<b>8611110</b>	M10	8
<b>8611112</b>	M12	9

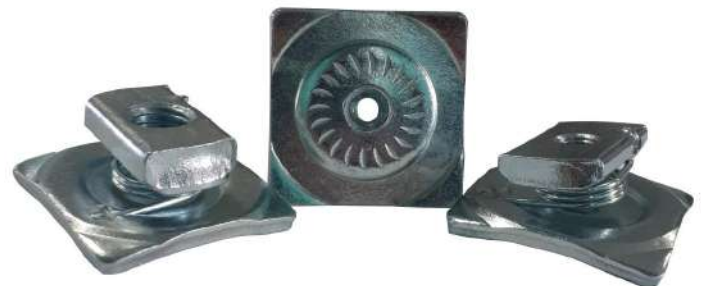
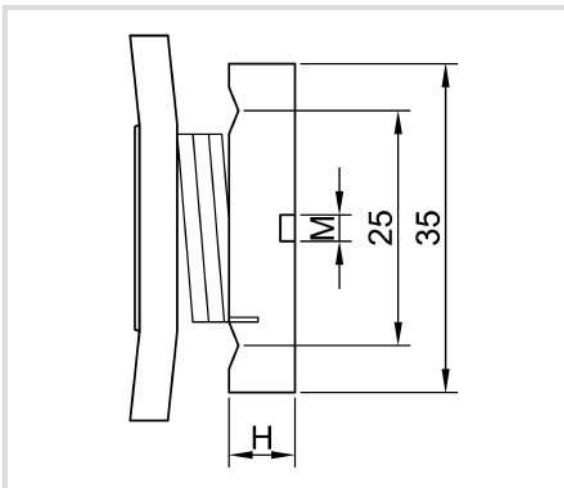
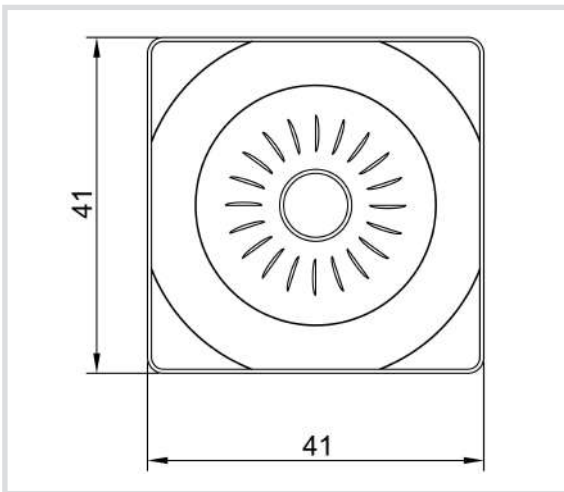

Art. 862 CorSTRUT slide nut with spring



*Technical specifications and advantages*

- Material: steel slide nut 1.0332;  
steel spring DIN 17223 (class A)
- Galvanised

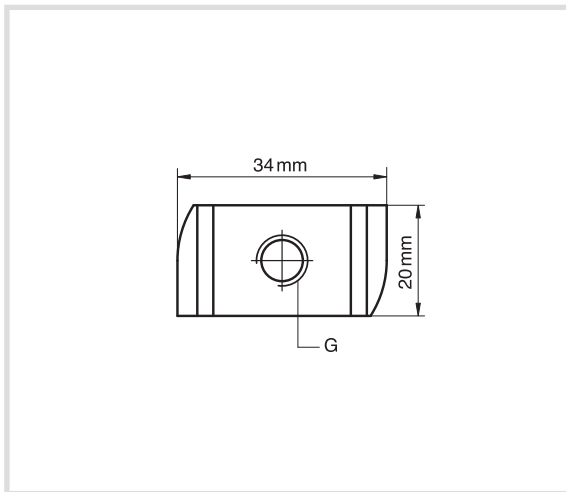

Code	G	For	L [mm]	s [mm]	Payload [N]
<b>8620006</b>	M6	CorSTRUT 41x21	13	5,0	5300
<b>8620008</b>	M8	CorSTRUT 41x21	13	6,0	6000
<b>8620010</b>	M10	CorSTRUT 41x21	13	8,0	9500
<b>8620012</b>	M12	CorSTRUT 41x21	13	9,0	10000
<b>8621006</b>	M6	CorSTRUT 41x41	13	5,0	5300
<b>8621008</b>	M8	CorSTRUT 41x41	33	6,0	6000
<b>8621010</b>	M10	CorSTRUT 41x41	33	8,0	9500
<b>8621012</b>	M12	CorSTRUT 41x41	33	9,0	10000

**HOT GALVANISED**

<b>8622006</b>	M6	CorSTRUT 41x21	13	5,0	5300
<b>8622008</b>	M8	CorSTRUT 41x21	13	6,0	6000
<b>8622010</b>	M10	CorSTRUT 41x21	13	8,0	9500
<b>8622012</b>	M12	CorSTRUT 41x21	13	9,0	10000

**HOT GALVANISED**

<b>8623006</b>	M6	CorSTRUT 41x41	33	5,0	5300
<b>8623008</b>	M8	CorSTRUT 41x41	33	6,0	6000
<b>8623010</b>	M10	CorSTRUT 41x41	33	8,0	9500
<b>8623012</b>	M12	CorSTRUT 41x41	33	9,0	10000

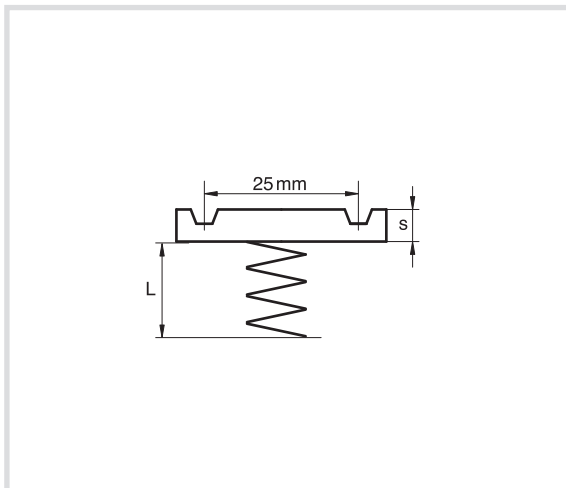

Art. 869 CorSTRUT slide nut with spring on top



*Technical specifications and advantages*

- Material: steel slide nut 1.0332;  
steel spring DIN 17223 (class A)
- Galvanised

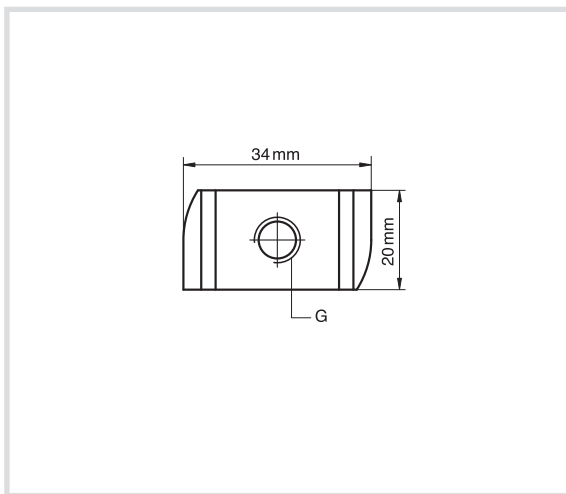

Code	G	For	s [mm]	Payload [N]
<b>8694006</b>	M6	CorSTRUT	5,0	5300
<b>8694008</b>	M8	CorSTRUT	6,0	6000
<b>8694010</b>	M10	CorSTRUT	8,0	9500
<b>8694012</b>	M12	CorSTRUT	9,0	10000

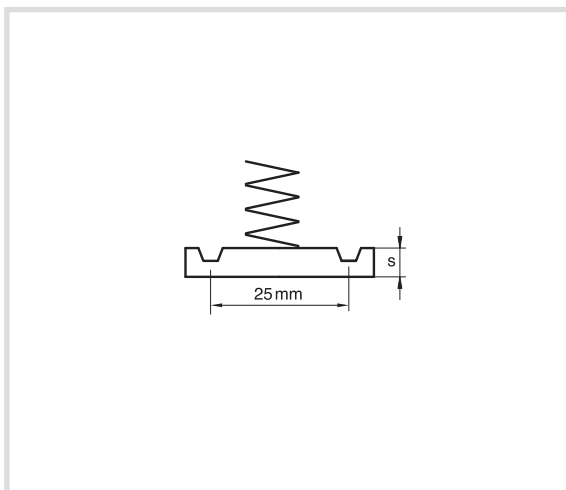

Art. 866 Slide nut with threaded pin for CorSTRUT



*Technical specifications and advantages*

- Slide nut with threaded pin, round washer, pre-assembled
- Made of galvanised steel
- Time-saving thanks to the pre-assembled system of different lengths
- Possibility of height adjustment of the pin
- Only one component for any CorSTRUT 41 fixing rail height

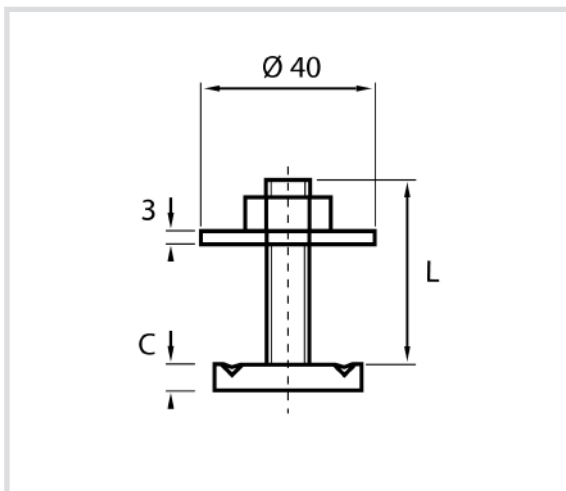

Code	G	L [mm]	C [mm]	Payload [N]
<b>8660840</b>	M8	40	6,0	6000
<b>8660860</b>	M8	60	6,0	6000
<b>8660810</b>	M8	100	6,0	6000
<b>8661040</b>	M10	40	8,0	6000
<b>8661060</b>	M10	60	8,0	6000
<b>8661010</b>	M10	100	8,0	6000
<b>8661240</b>	M12	40	9,0	6000
<b>8661260</b>	M12	60	9,0	6000

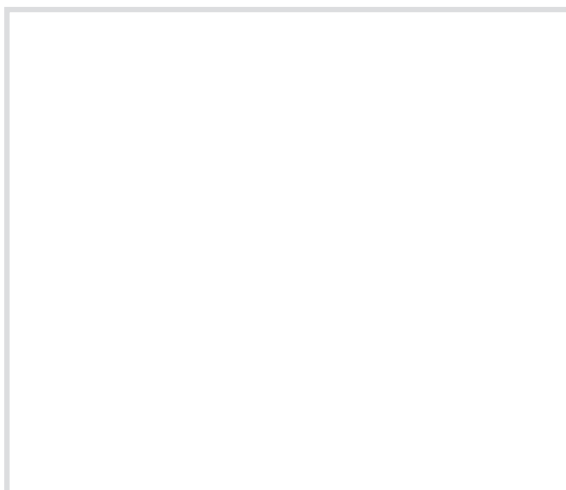



Art. 6527 Slide nut with threaded pin for CorSTRUT

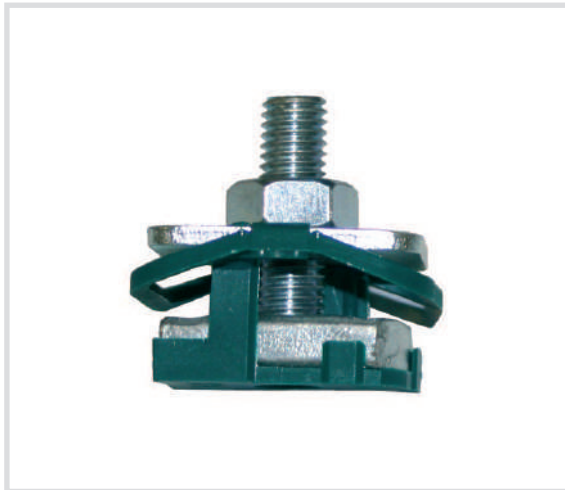

*Technical specifications and advantages*

- Slide nut with threaded pin, square washer and plastic spring
- Made with S235JR steel
- Galvanised
- Spring in POM (polyoxymethylene), green
- With a plastic spring that keeps the piece fixed in the desired position until final tightening
- Possibility of height adjustment of the pin
- Tested for fire resistance

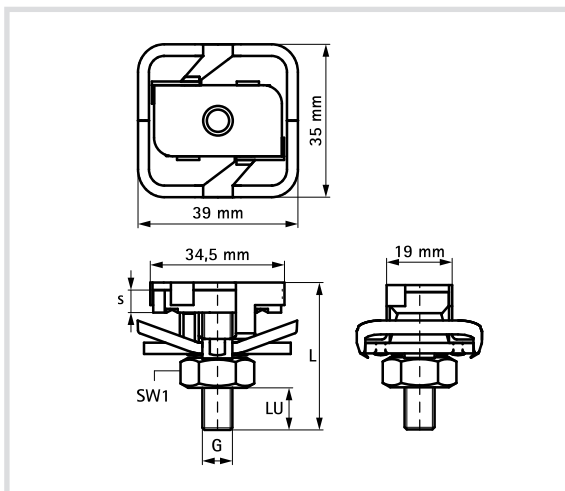

Code	G	L [mm]	s [mm]	SW1 [mm]	LU [mm]	Fa,z [N]
<b>652785804</b>	M8	40	6,0	13	16	6000
<b>652785806</b>	M8	60	6,0	13	36	6000
<b>652785808</b>	M8	80	8,0	13	56	6000
<b>652785810</b>	M8	100	8,0	13	76	6000
<b>652785004</b>	M10	40	8,0	17	12	6000
<b>652785006</b>	M10	60	8,0	17	32	6000
<b>652785008</b>	M10	80	8,0	17	52	6000
<b>652785204</b>	M12	40	10,0	19	10	10000
<b>652785206</b>	M12	60	10,0	19	30	10000
<b>6527208</b>	M12	80	10,0	19	50	10000

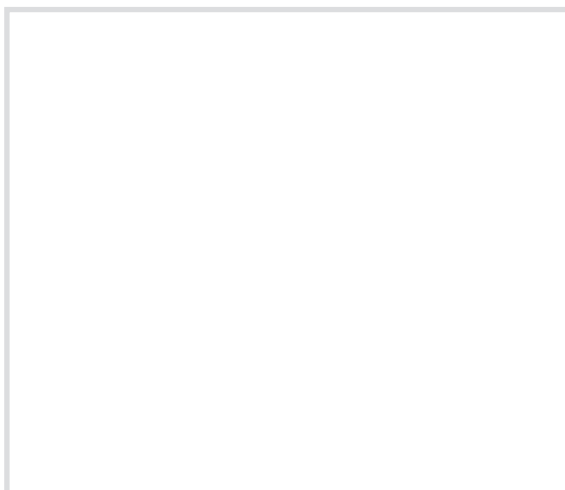

Art. 6653 Ball swivel hangers CorSTRUT with height adjuster



*Technical specifications and advantages*

- Made with 1.0332 galvanised steel
- Spring: POM (polyoxymethylene), green
- With inspection hole to check the adjustment
- With pre-assembled plastic spring
- Recommended for metal pipes up to DN 50, for plastic pipes up to DN 100

Code	G	L [mm]	s [mm]	SW1 [mm]	SW2 [mm]	LU [mm]
66530805	M8	50	6,0	13	10	37,5
66530005	M10	50	8,0	13	12	34,5
66530206	M12	94	10,0	-	-	32,0

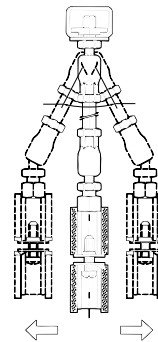
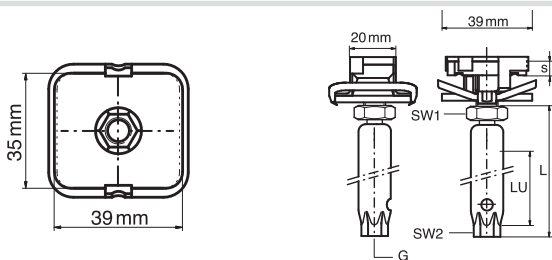

Art. 86351 Adjustable universal brace



*Technical specifications and advantages*

- To create braces, struts, inclined installations up to 180°
- Fully adjustable angle
- With 2 through holes diam. 13 mm
- Material: steel

Code	Diameter of holes [mm]
8635180	13

Art. 86010

Universal brace for M10/M12 threaded rods



*Technical specifications and advantages*

- In galvanised steel
- To reinforce a fixing rail structure with the help of M10-M12 threaded rods
- It is also suitable to reinforce cantilever arms
- Suitable to create seismic fixings

Code	R	Hole [mm]
<b>8601012</b>	M10-M12	13

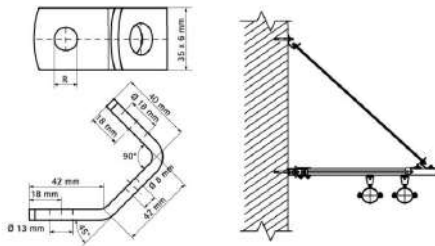

Art. 901816 CorSTRUT square slide nut



*Technical specifications and advantages*

- Material: 1.0332 steel
- Hot-dip galvanised
- Tested for fire resistance



Code	G
<b>901816</b>	M16

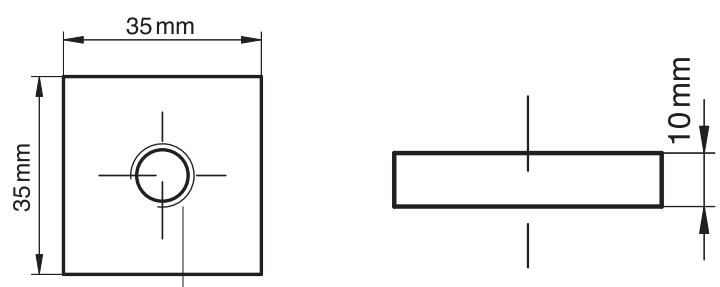

Art. 9015 Washer for CorSTRUT

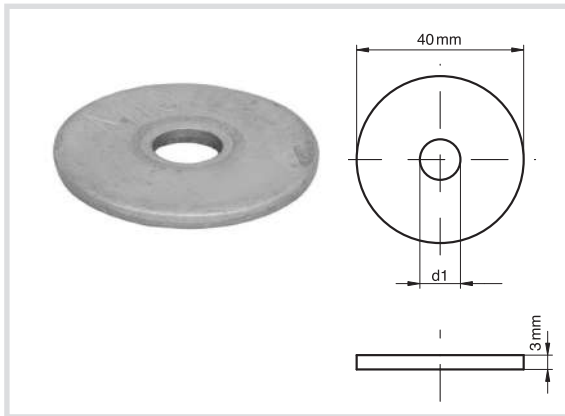

*Technical specifications and advantages*

- Flat washer
- Material: 1.0332 steel
- Hot galvanised

Code	d1 [mm]
<b>901506</b>	Ø 6,5
<b>901508</b>	Ø 8,5
<b>901510</b>	Ø 10,5
<b>901512</b>	Ø 12,5
<b>901516</b>	Ø 17

Art. 9016 U-shaped complement (washer) for CorSTRUT

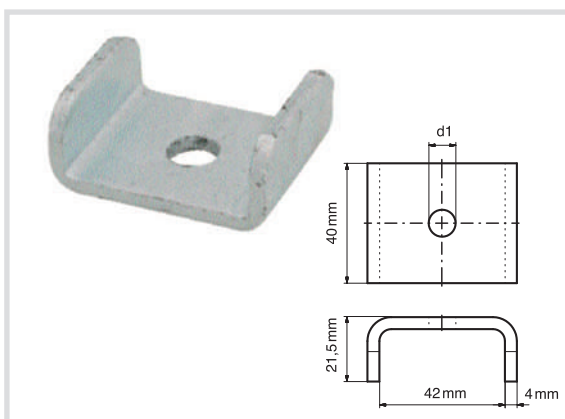

*Technical specifications and advantages*

- Made with 1.0332 steel
- Hot dipped galvanised

Code	Ø Hole [mm]
<b>901608</b>	9,0
<b>901610</b>	11,0
<b>901612</b>	13,0
<b>901616</b>	17,0



Art. 9017 Square washer for CorSTRUT

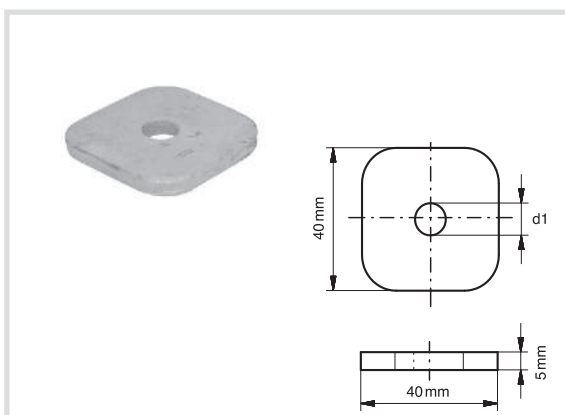

*Technical specifications and advantages*

- Made with 1.0332 steel
- Hot-dip galvanised

Code	d1 [mm]
<b>901708</b>	Ø 9,0
<b>901710</b>	Ø 11,0
<b>901712</b>	Ø 13,0

Art. 6658 90° and 45° angle brackets including slide nuts and bolts



### Technical specifications and advantages

- Made with 1.0332 galvanised steel
- Spring: POM (polyoxymethylene), green
- To build supports or suspension elements
- Includes pre-assembled slide nuts to hold the piece in place until tightened
- Guaranteed adjustment



Code	Type	$\alpha$ (°)	Nuts
<b>665885205</b>	long / long	90	4
<b>665885235</b>	long / long	135	4
<b>665885203</b>	short / long	90	3

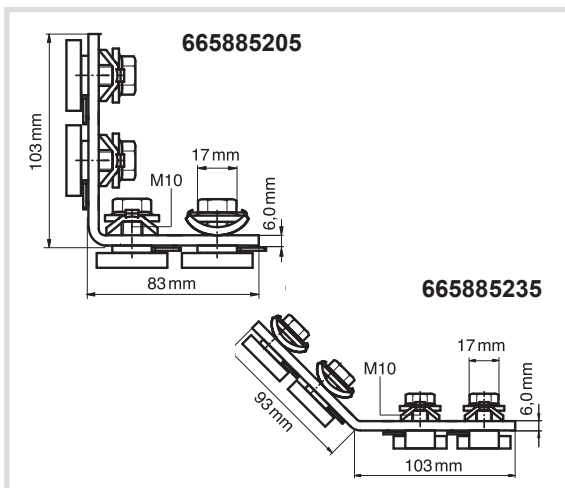

Art. 8600 90° angle brackets with two holes



*Technical specifications and advantages*

- Made with S235JR steel
- Hot-dip galvanised

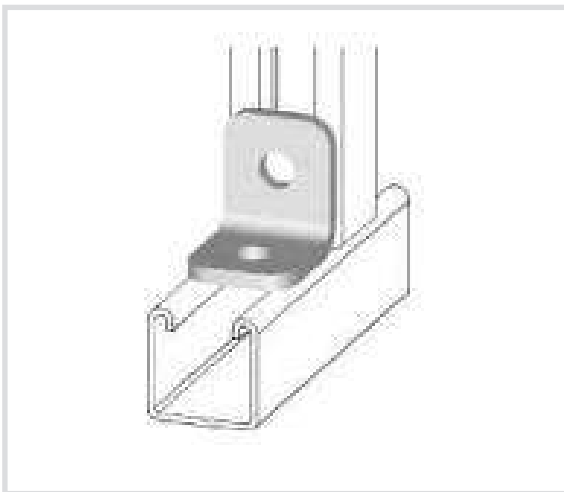

Code	Dimensions [mm]	Thickness S [mm]	Diameter of holes [mm]
<b>8600049</b>	49x49	6,0	13
<b>8600057</b>	57x41	6,0	13

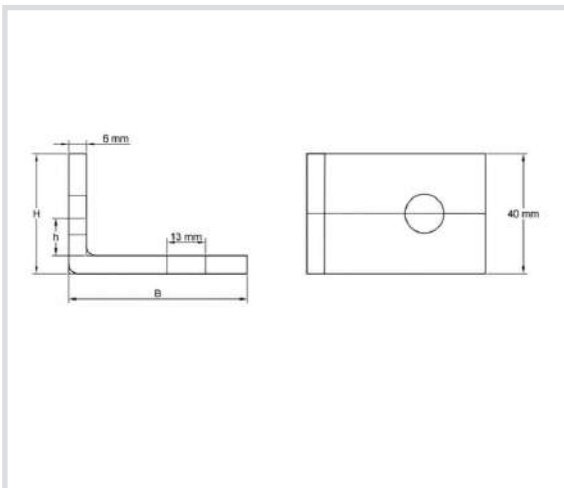

Art. 8600903 90° angle brackets with three holes



*Caratteristiche tecniche e vantaggi*

- Made with S235JR steel
- Hot-dip galvanised
- Slotted hole to simplify attachment

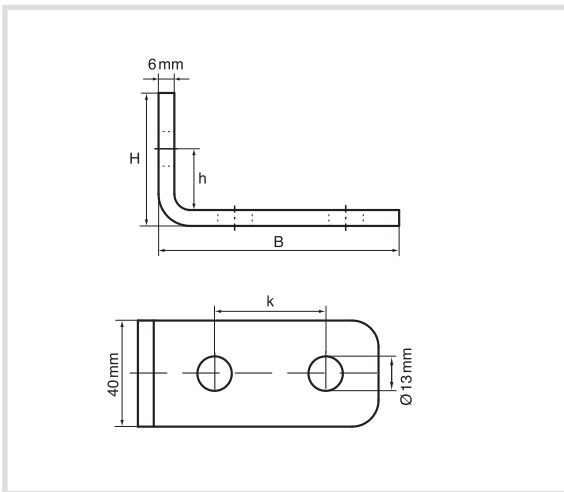

Code	BxH [mm]	Thickness S [mm]	Diameter of holes [mm]	Slotted hole [mm]
<b>8600903</b>	95x57	6,0	13	22x10

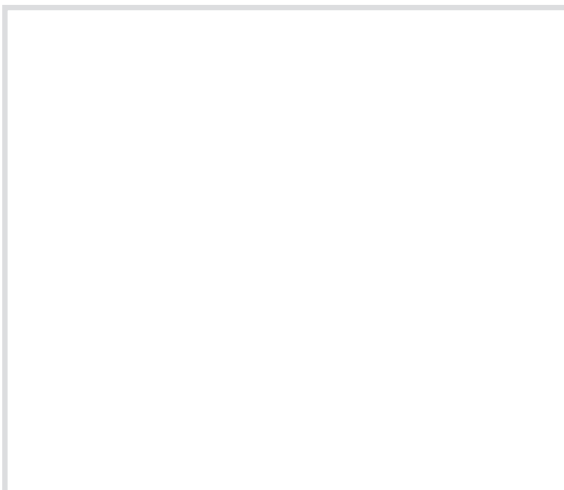

Art. 8615 Angle brackets with 3 and 4 holes at 90°



*Technical specifications and advantages*

- Made with S235JR steel
- Hot-dip galvanised

Code	Holes	B [mm]	H [mm]	k [mm]	h [mm]	$\alpha$ [°]	s [mm]
<b>8615041</b>	3	99	41	41	15	90	6
<b>8615049</b>	3	91	49	41	23	90	6
<b>8615091</b>	4	100	100	50	29	90	7

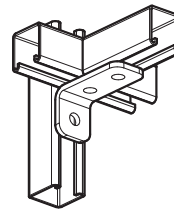
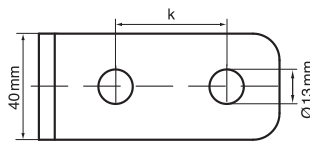
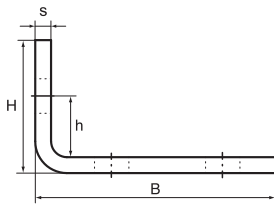

Art. 8618 Reinforced 90° angle bracket



*Technical specifications*

- Material: S235JR steel
- Hot-dip galvanised

Code	Measurements [mm]
<b>8618090</b>	102 x 86

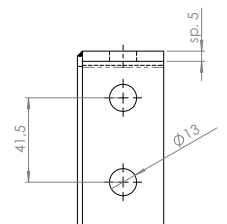
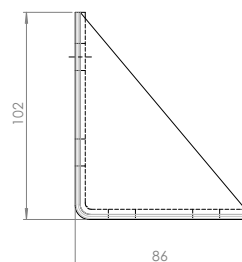
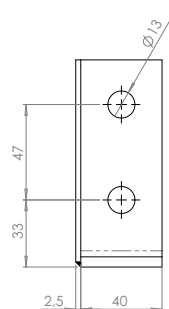
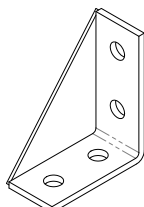



Art. 8600045 45° slotted angle bracket



*Technical specifications and advantages*

- Made with S235JR steel
- Hot-dip galvanised
- To create connections between fixing rails

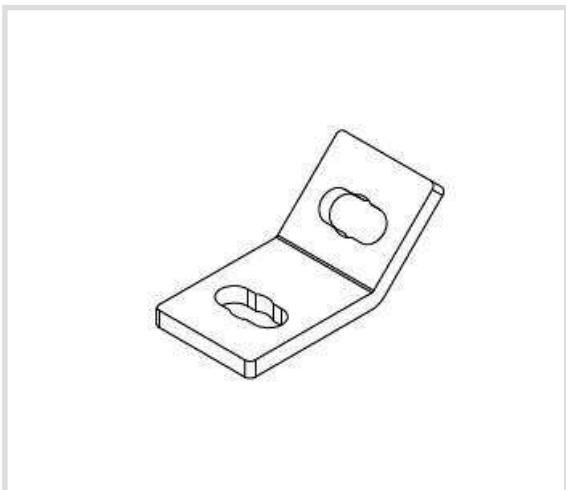
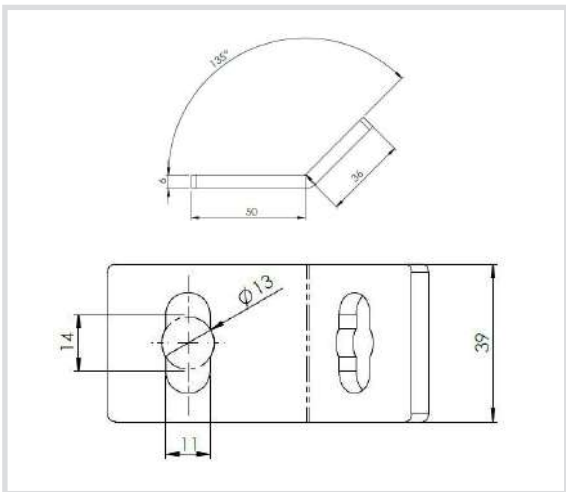

Code	Dimensions [mm]	Thickness S [mm]	Ø Holes [mm]
<b>8600045</b>	50x36	6,0	13

### Art. 8645 CorSTRUT rail connector including slide nuts and bolts



#### Technical specifications and advantages

- Made with 1.0332 steel
- Includes pre-assembled slide nuts to hold the piece in place before final tightening
- Spring: POM (polyoxymethylene), green

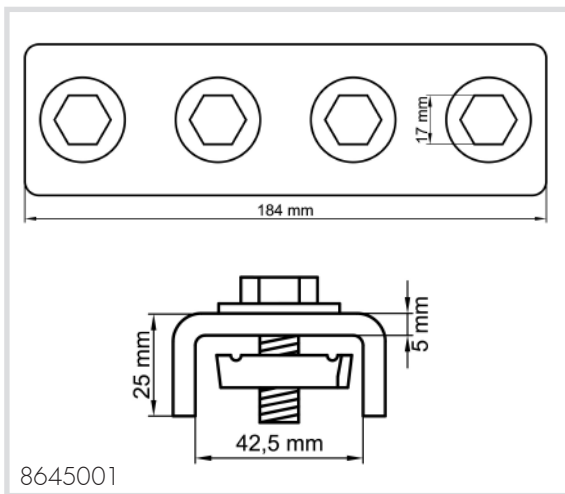

Code	L [mm]	Thickness S [mm]	Bolts
<b>8645001</b>	184	5,0	M10 x 20
<b>8645002</b>	188	6,0	M10x20

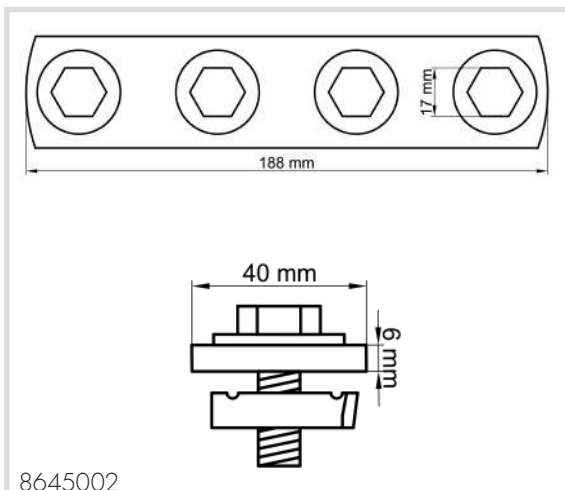

Art. 8636 CorSTRUT rail beam clamp



*Technical specifications and advantages*

- Made with S235JR steel
- Hot galvanised
- Always use 2 plates for each beam
- To attach fixing rails to a beam without welding or drilling

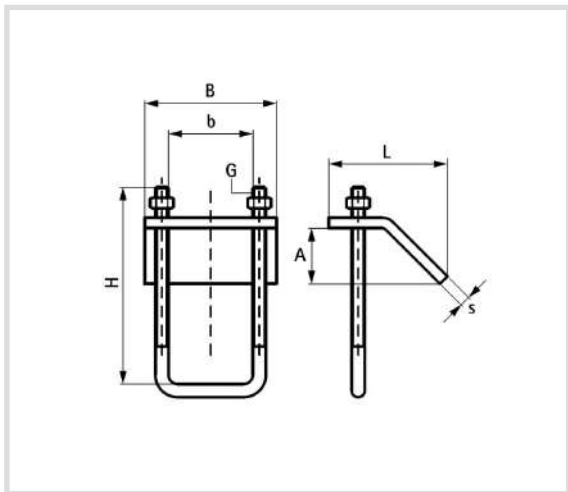

Code	A [mm]	H [mm]	B [mm]	L [mm]	G	S [mm]	Fixing rails	Payload [N]
<b>8636001</b>	<20	85	80	83	M10	5	41x21 e 41x41	5700
<b>8636002</b>	<20	115	80	83	M10	6	41x62 e 41x82	5700

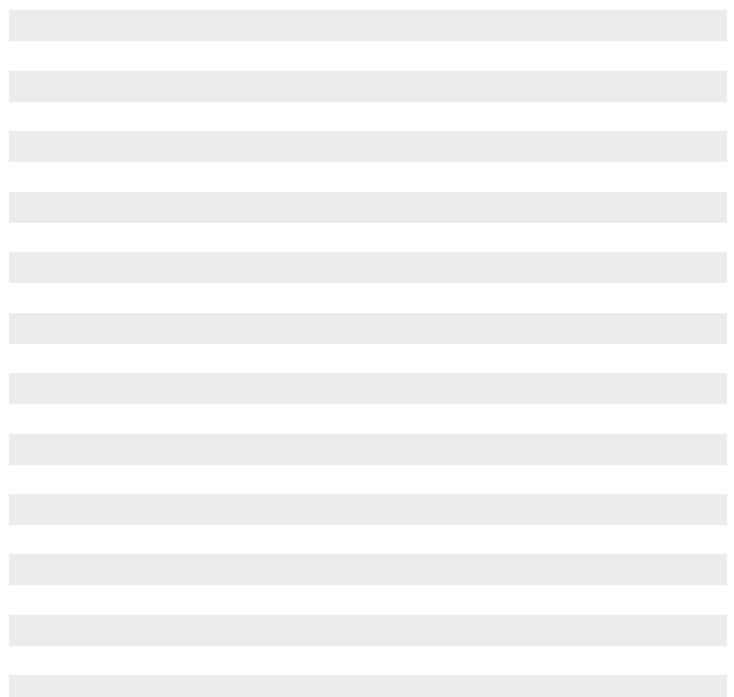
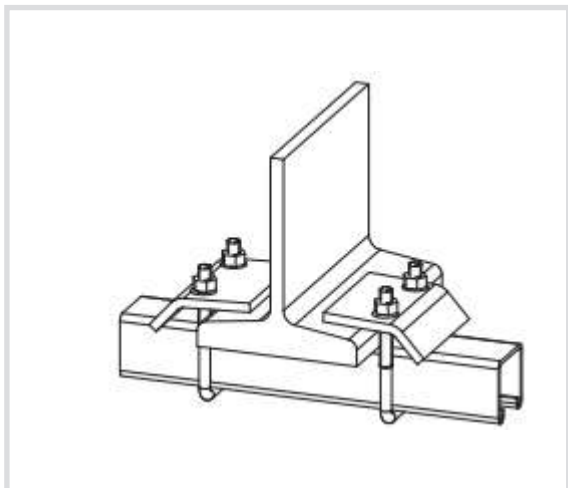

Art. 8637 Clamp for fixing to beams



*Technical specifications and advantages*

- To connect heavy components
- Material: hot-dip galvanised steel
- For fixing of double Strut 41x(2x21) and 41x(2x41) to beams of up to 35mm thick

Code	T [Nm]	Fa,z [N]	Fa,x [N]
<b>8637000</b>	15	8000	1500

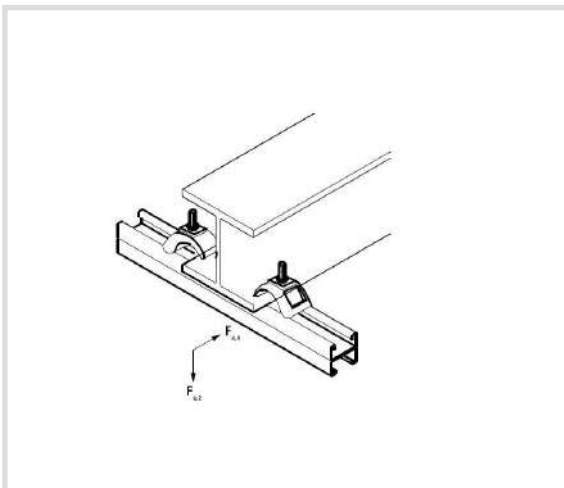
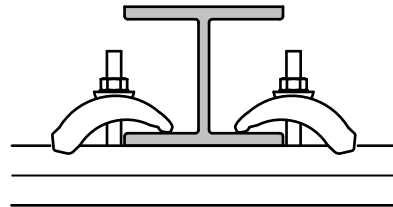
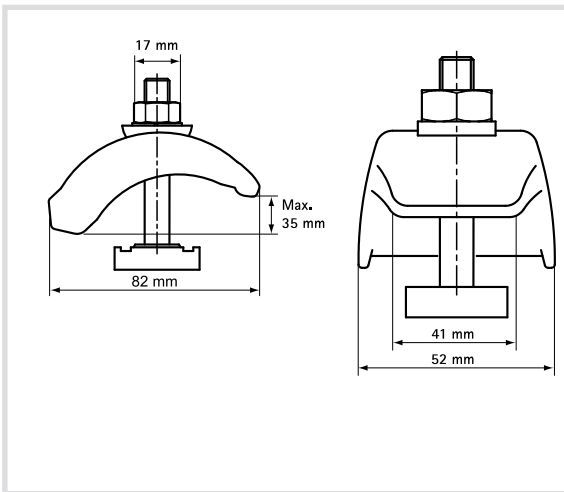

Art. 8619 Clamp for fixing to beams



*Technical specifications and advantages*

- For fixing to beam without drilling or welding
- Always use 2 clamps to fix
- Material: 1.0332 steel
- Hot-dip galvanized

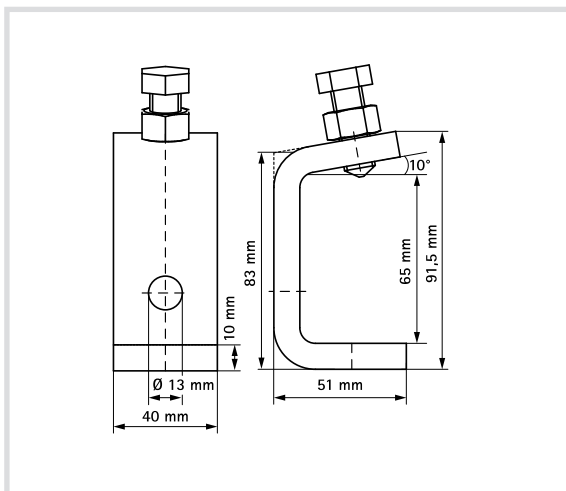

Code	Fixing rail
<b>8619000</b>	41x41

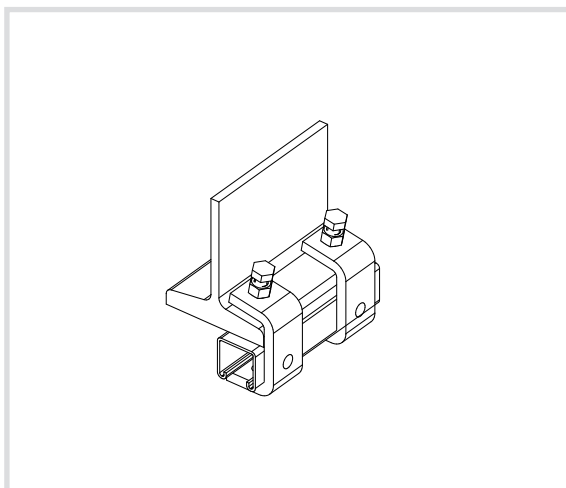

Art. 8616 CorSTRUT straight connection

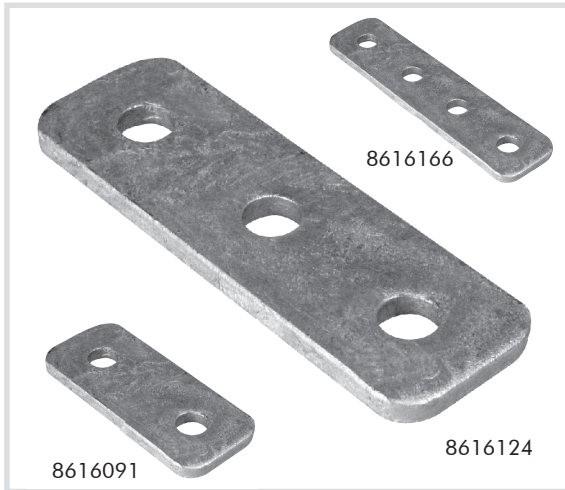

*Technical specifications and advantages*

- Flat connection
- Material: S235JR steel
- Hot galvanised

Code	L [mm]	Holes
<b>8616091</b>	91	2
<b>8616124</b>	140	3
<b>8616166</b>	166	4

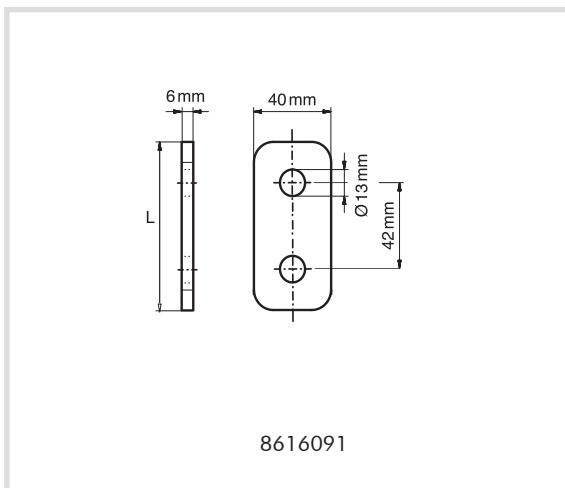
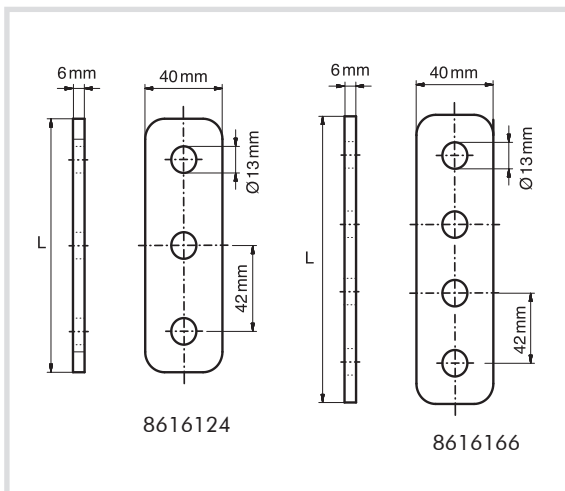

Art. 8614 Angle bracket with 3 holes



*Caratteristiche tecniche e vantaggi*

- Made with S235JR steel
- Hot-dip galvanised

Code	$\alpha$ (°)
<b>8614030</b>	30
<b>8614045</b>	45
<b>8614060</b>	60

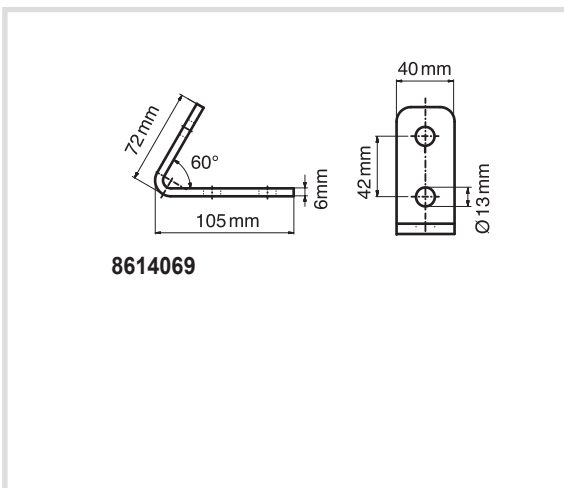
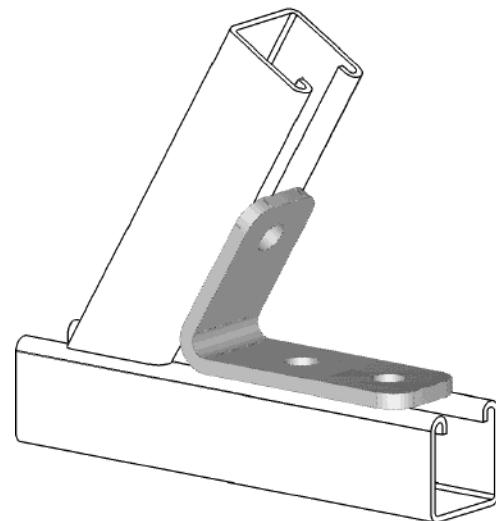
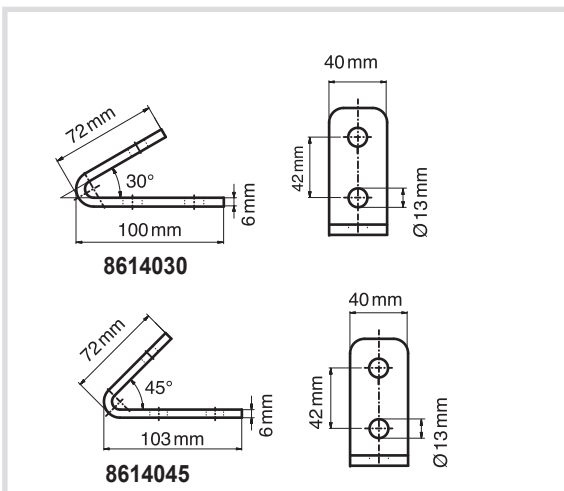

### Art. 8638 90° connections



#### Technical specifications and advantages

- To build structures in CorSTRUT fixing rail
- Easy to assemble, rounded corners
- Material: S235JR steel
- Hot-dip galvanised

Code	Type
8638001	90°
8638002	90°

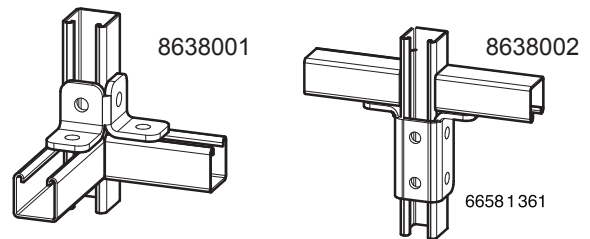
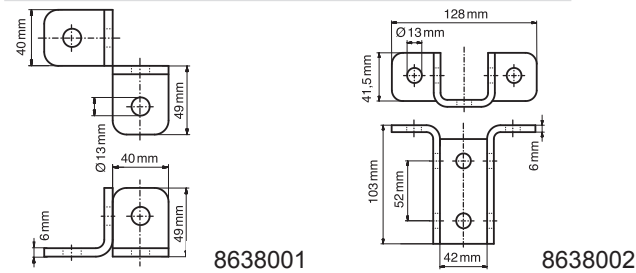

### Art. 8639 Open connector



#### Technical specifications and advantages

- To build structures in CorSTRUT fixing rail
- Material: S235JR steel
- Hot-dip galvanised

Code	Type	
8639150	150°	3 fori
8639151	135°	3 fori
8639152	120°	4 fori
8639153	135°	4 fori

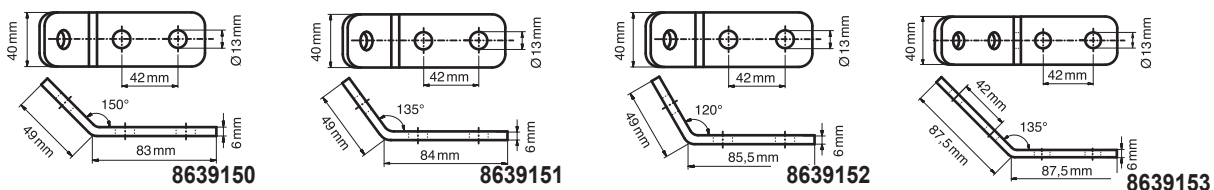



### Art. 8640 135° and 90° angled T-connection



#### Technical specifications and advantages

- To build structures in CorSTRUT fixing rail
- Material: steel
- Hot-dip galvanised

Code	Type
<b>8640135</b>	135°
<b>8640090</b>	90°

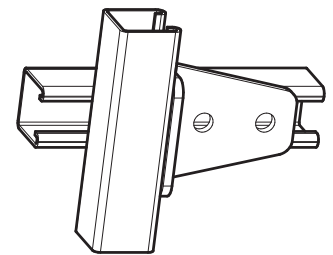
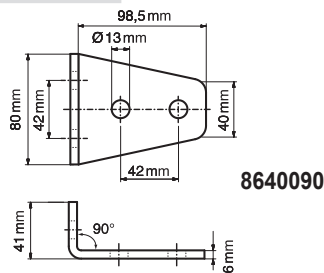
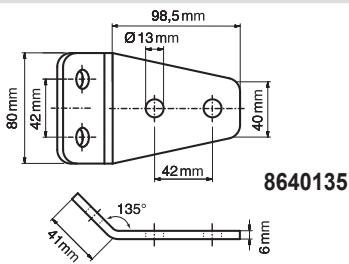

### Art. 8641 Z connection



#### Technical specifications and advantages

- To build structures in CorSTRUT fixing rail
- Material: steel
- Hot-dip galvanised

Code	Fixing rail	H [mm]	h [mm]
<b>8641027</b>	41x21	27,5	21,5
<b>8641047</b>	41x41	47,0	41,0
<b>8641068</b>	41x62	68,0	62,0
<b>8641089</b>	41x82	89,0	83,0

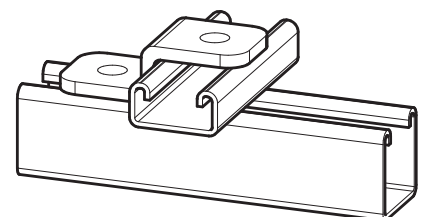
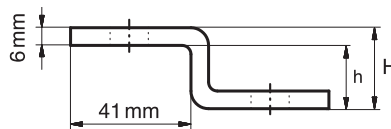
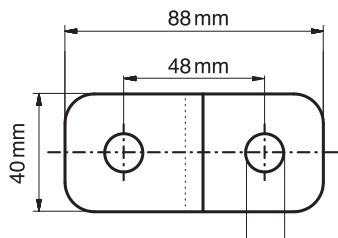

### Art. 8643 T and X connections

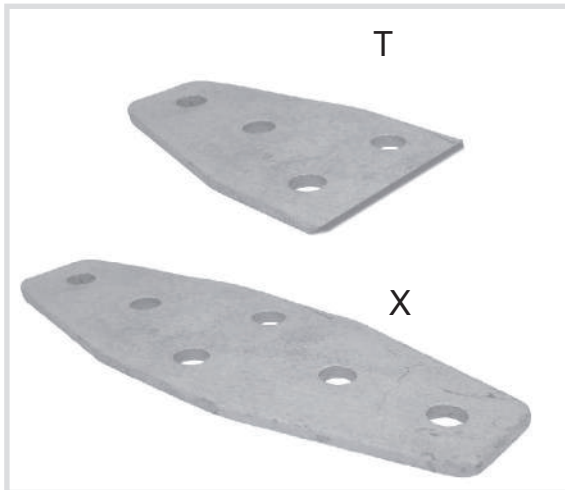

#### Technical specifications and advantages

- To build structures in CorSTRUT fixing rail
- Material: steel
- Hot-dip galvanised

Code	Type	For
8643001	T	CorSTRUT
8643002	X	CorSTRUT

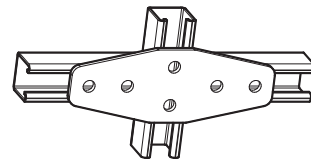
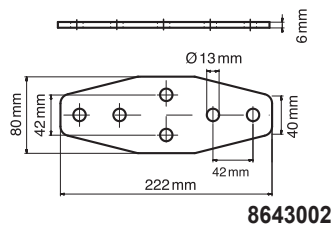
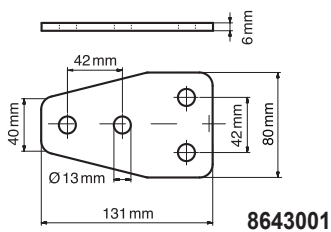

### Art. 8642 Rail connector

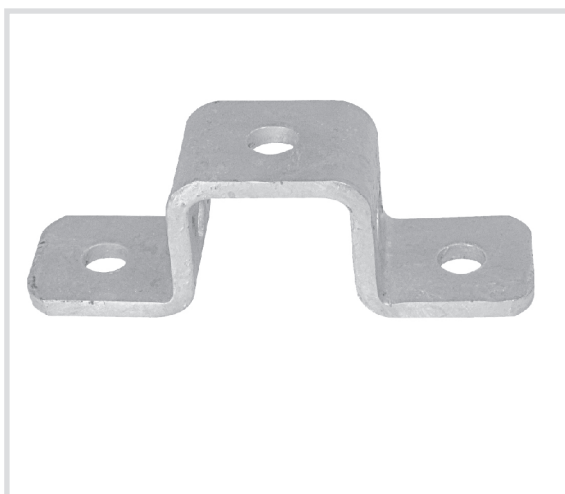

#### Technical specifications and advantages

- To build structures in CorSTRUT fixing rail
- Material: S235JR steel
- Hot-dip galvanised

Code	Type	H [mm]	h [mm]
8642021	To CorSTRUT 41x21	26	20
8642041	To CorSTRUT 41x41	46	40
8642062	To CorSTRUT 41x62	66	60
8642082	To CorSTRUT 41x82	87	81

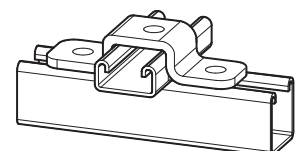
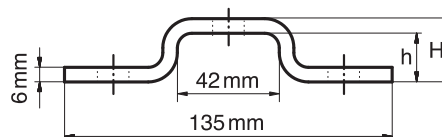
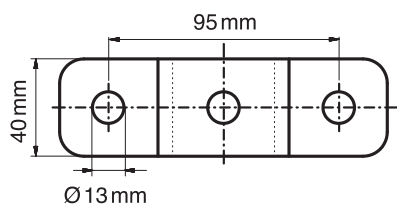

Art. 8626 Angle brackets



*Technical specifications and advantages*

- To build structures in CorSTRUT fixing rail
- Material: steel
- Hot-dip galvanized

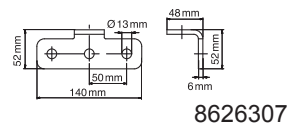
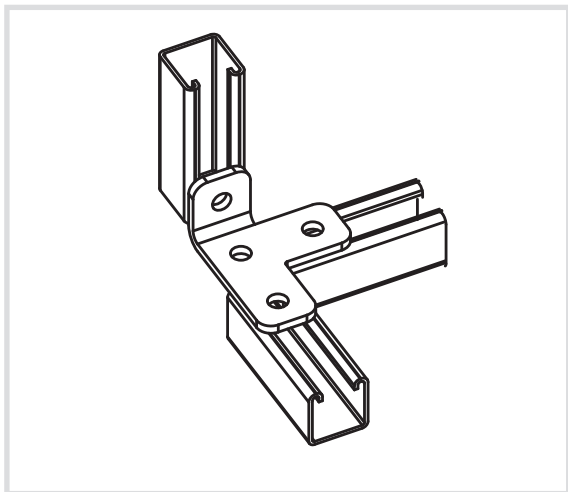
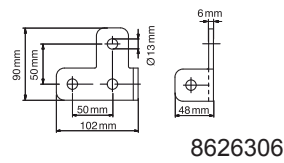

Code	For	$\alpha$ [°]
8626300	CorSTRUT	-
8626305	CorSTRUT	90
8626306	CorSTRUT	90
8626307	CorSTRUT	90

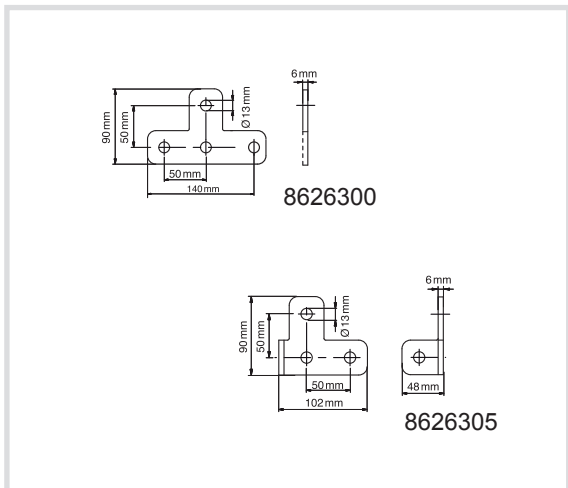

Art. 8644 Rail connectors



*Technical specifications and advantages*

- To build structures in CorSTRUT fixing rail
- Material: steel
- Hot-dip galvanised



Code	For	$\alpha$ [°]
<b>8644001</b>	CorSTRUT	-
<b>8644002</b>	CorSTRUT	90°
<b>8644003</b>	CorSTRUT	90°

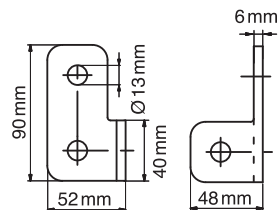

8644002

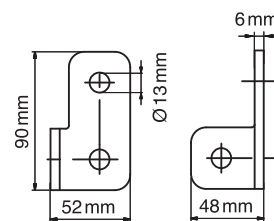

8644003

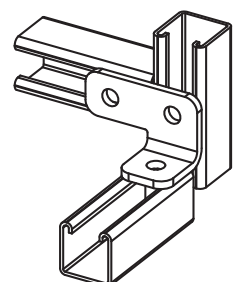

Art. 8627 Fixing for CorSTRUT fixing rails



*Technical specifications and advantages*

- For connection to a steel structure without drilling or welding
- Material: S235JR steel
- Hot-dip galvanised

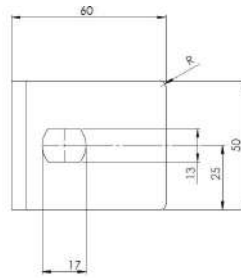
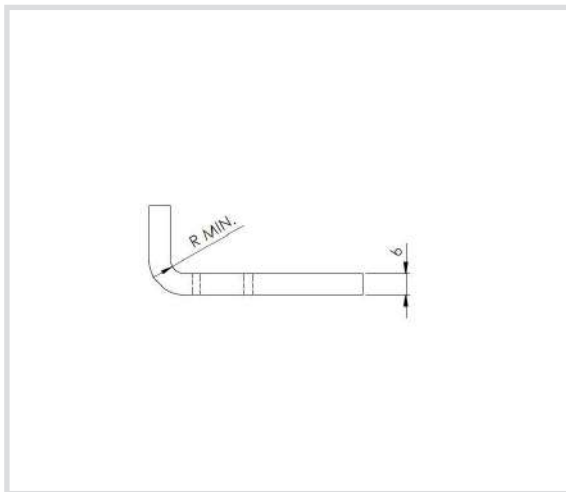

Code	A [mm]
8627001	< 10
8627002	< 15

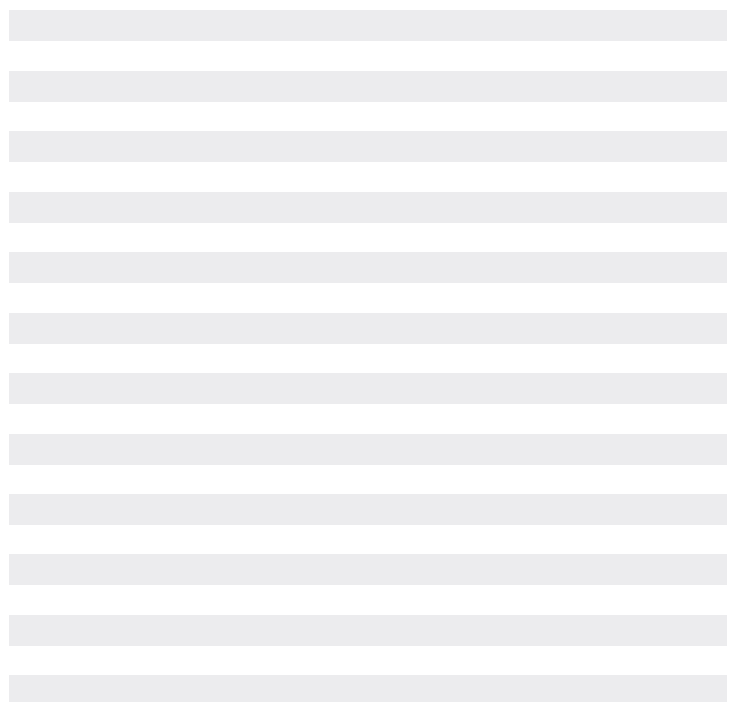
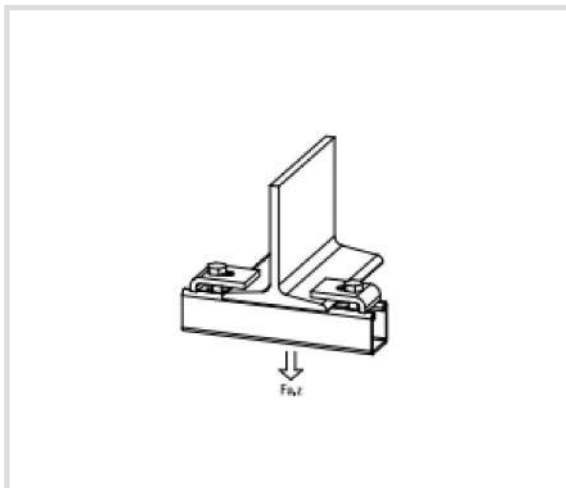

Art. 8628 Fixing with insert for CorSTRUT fixing rails



*Technical specifications and advantages*

- For connection to a steel structure without drilling or welding
- Material: 1.0332 steel
- Hot-dip galvanised

Code	A [mm]	Payload [N]
<b>8628001</b>	< 10	8000
<b>8628002</b>	< 15	8300

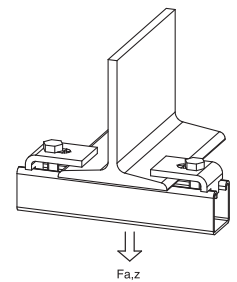
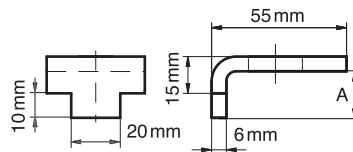
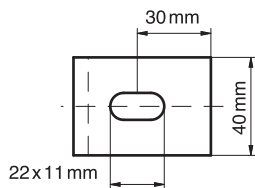

Art. 8126 End cap for CorSTRUT fixing rails



*Technical specifications and advantages*

- Made with PE (polyethylene)
- Colour: Black
- The function of the cap is decorative and protective: the sharp edges generated by the fixing rail cut are completely covered

Code	Depth [mm]	For fixing rail	Fixing rail
<b>812621</b>	6	CorSTRUT	41 x 21
<b>812641</b>	12	CorSTRUT	41 x 41

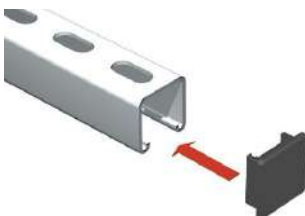

Art. 8629 EPDM sheath for soundproofing of fixing rails and threaded rods



*Technical specifications and advantages*

- Made of EPDM rubber, black
- Also suitable for M6, M8, M10 threaded rods
- Noise insulation according to DIN 4109
- Resistant to ageing

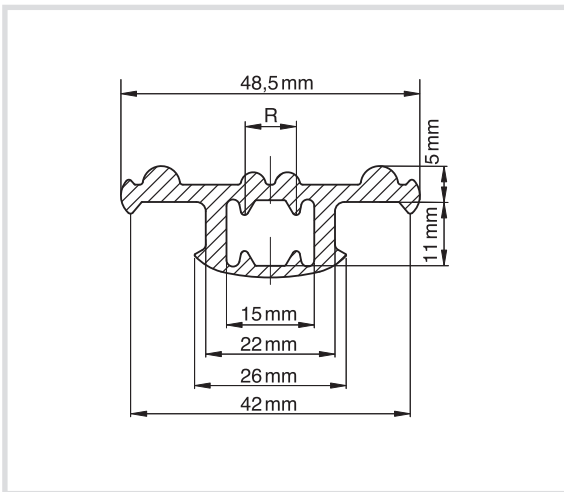

Code	R	Length [m]	Fixing rails
<b>8629000</b>	M6-M10	30	CorSTRUT



Art. 976 Downpipe bracket



*Technical specifications and advantages*

- Possibility of adjusting the distance
- It is possible to insert bracing to increase the axial resistance
- In galvanised steel
- Components for standard downpipe bracket:  
 2 CorSTRUT cantilever arms, 2 special 90° angle brackets, 1 heavy clamp
- In case of downpipe, a heavy clamp may be sufficient as the structure has a guiding function
- Clamp, with or without rubber, not included in the package

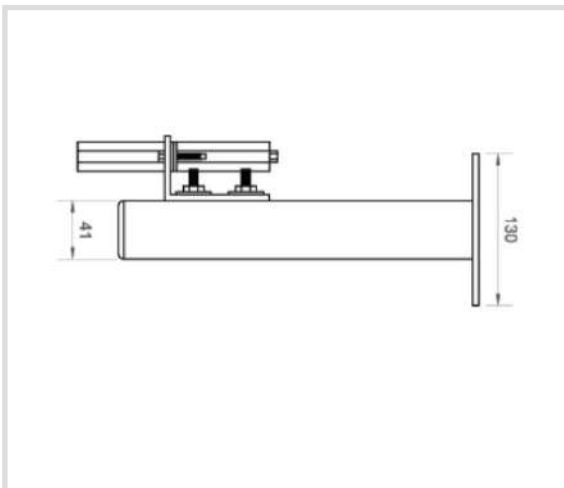
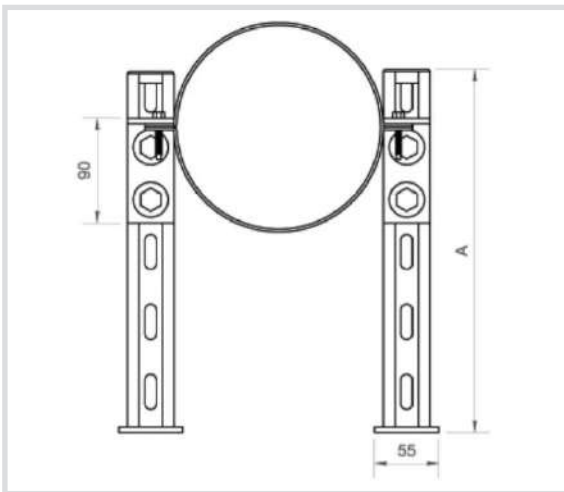

Code	A [mm]
976300	300
976450	450
976600	600



### Calculation method

The published payloads are based on tests with perforated fixing rails. For non-perforated fixing rails, the payload is 20% higher than reported.

The loads are calculated considering a maximum deflection (f) of a value equal to  $1/200 \times L$  and a maximum bending load of 160 N/mm<sup>2</sup>.

Example: for a length of 500 mm the maximum payload is 1400 N;  
 the maximum deflection will be  $(1/200 \times 500 \text{ mm}) = 2.5 \text{ mm}$   
 1 N (Newton) = 0.102 kg      1 kg = 9.8 N (Newton)

### Attaching of the fixing rail to walls or partitions

The anchoring force of the fixing rail has not been taken into consideration.

The installer must check that the screws and anchors used to attach the fixing rail to the wall or ceiling are suitable for the maximum load permitted by the fixing rail.

### Loading methods

Where loads are suspended on the fixing rails, the load must not exceed the safe payload of the attachment to the fixing rail. To increase the rigidity of the installation we recommend the use of pre-shaped U washers.

When loading is from above the fixing rail, the possible load is greater than that shown in the tables.

### How to read load tables

Where the box is empty, the fixing rail selected for that application cannot be used but one with a higher range must be used.

### Special conditions

In case of uncertainty or special conditions not shown in the load tables, do not hesitate to contact our technical department for suggestions and advice.

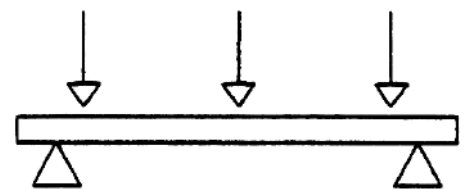
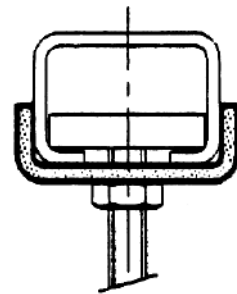
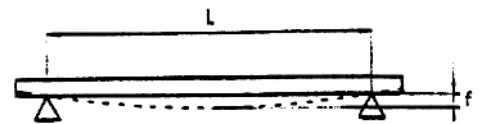

Top loading

# CorSTRUT fixing rail

## 1 point suspension

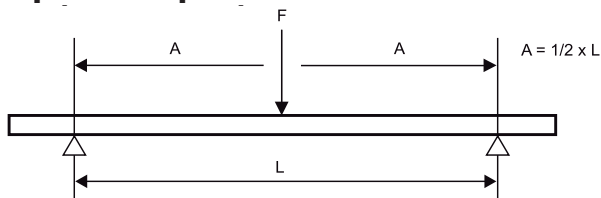

L (mm)	single						
	41x21 1,5	41x21 2,0	41x41 1,5	41x41 2,0	41x41 2,5	41x62 2,5	41x82 2,5
250	1.848	2.381	5.427	6.556	7.611	14.730	23.035
300	1.540	1.984	4.523	5.463	6.342	12.275	19.196
350	1.320	1.701	3.877	4.683	5.436	10.522	16.453
400	1.155	1.488	3.392	4.098	4.757	9.206	14.397
450	1.027	1.323	3.015	3.642	4.228	8.183	12.797
500	924	1.190	2.714	3.278	3.805	7.365	11.517
600	770	992	2.261	2.732	3.171	6.138	9.598
700	660	850	1.938	2.341	2.718	5.261	8.227
800	557	719	1.696	2.049	2.378	4.603	7.198
900	440	568	1.508	1.821	2.114	4.092	6.399
1.000	356	460	1.357	1.639	1.903	3.683	5.759
1.200	247	320	1.131	1.366	1.586	3.069	4.799
1.400	182	235	969	1.171	1.359	2.630	4.113
1.600	139	180	794	952	1.114	2.302	3.599
1.800	110	142	628	752	881	2.046	3.199
2.000	89	115	508	609	713	1.841	2.879
2.250	70	91	402	481	564	1.624	2.559
2.500	57	74	325	390	456	1.315	2.303
2.750	47	61	269	322	377	1.087	2.094
3.000	40	51	226	271	317	913	1.890
3.250	34	44	193	231	270	778	1.611
3.500	29	38	166	199	233	671	1.389
3.750	25	33	145	173	203	584	1.210
4.000	22	29	127	152	178	514	1.063
4.250	20	25	113	135	158	455	942
4.500	18	23	100	120	141	406	840
4.750	16	20	90	108	126	364	754
5.000	14	18	81	97	114	329	680
5.250	13	17	74	88	104	298	617
5.500	12	15	67	81	94	272	562
5.750	11	14	62	74	86	249	515
6.000	-	13	56	68	79	228	473

double			
41x21D	41x41D	41x62D	41x82D
7.081	22.804	32.686	42.030
5.901	19.004	27.238	35.025
5.058	16.289	23.347	30.021
4.426	14.253	20.429	26.269
3.934	12.669	18.159	23.350
3.540	11.402	16.343	21.015
2.950	9.502	13.619	17.513
2.529	8.144	11.674	15.011
2.213	7.126	10.214	13.134
1.967	6.335	9.079	11.675
1.770	5.701	8.172	10.508
1.475	4.751	6.810	8.756
1.264	4.072	5.837	7.505
1.015	3.563	5.107	6.567
802	3.167	4.540	5.838
650	2.851	-	-
513	2.534	-	-
416	2.280	-	-
344	2.073	-	-
289	1.864	-	-
246	1.588	-	-
212	1.370	-	-
185	1.193	-	-
162	1.049	-	-
144	929	-	-
128	828	-	-
115	744	-	-
104	671	-	-
94	609	-	-
86	555	-	-
79	507	-	-
72	466	-	-

**Maximum payload in N.**

**The values reported are only valid for the fixing rail.  
The maximum payload of all the other construction parts must be verified.**

# CorSTRUT fixing rail

## 2 equal loads

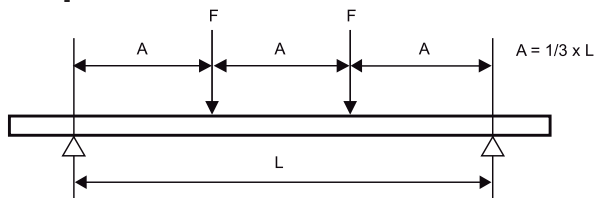

L (mm)	single						
	41x21 1,5	41x21 2,0	41x41 1,5	41x41 2,0	41x41 2,5	41x62 2,5	41x82 2,5
250	1.386	1.786	4.070	4.917	5.708	11.048	17.276
300	1.155	1.488	3.392	4.098	4.757	9.206	14.397
350	990	1.275	2.907	3.512	4.077	7.891	12.340
400	866	1.116	2.544	3.073	3.568	6.905	10.798
450	770	992	2.261	2.732	3.171	6.138	9.598
500	693	893	2.035	2.459	2.854	5.524	8.638
600	578	744	1.696	2.049	2.378	4.603	7.198
700	427	552	1.454	1.756	2.039	3.946	6.170
800	327	422	1.272	1.537	1.784	3.452	5.399
900	258	334	1.131	1.366	1.586	3.069	4.799
1.000	209	270	1.018	1.229	1.427	2.762	4.319
1.200	145	188	829	993	1.163	2.302	3.599
1.400	107	138	609	730	854	1.973	3.085
1.600	82	106	466	559	654	1.726	2.699
1.800	65	83	368	442	517	1.489	2.399
2.000	52	68	298	358	419	1.206	2.160
2.250	41	53	236	283	331	953	1.920
2.500	33	43	191	229	268	772	1.598
2.750	28	36	158	189	221	638	1.320
3.000	23	30	133	159	186	536	1.109
3.250	20	26	113	135	159	457	945
3.500	17	22	97	117	137	394	815
3.750	15	19	85	102	119	343	710
4.000	13	17	75	89	105	302	624
4.250	12	15	66	79	93	267	553
4.500	10	13	59	71	83	238	493
4.750	-	12	53	63	74	214	443
5.000	-	11	48	57	67	193	399
5.250	-	-	43	52	61	175	362
5.500	-	-	39	47	55	159	330
5.750	-	-	36	43	51	146	302
6.000	-	-	33	40	47	134	277

double			
41x21D	41x41D	41x62D	41x82D
5.311	17.103	24.515	31.523
4.426	14.253	20.429	26.269
3.793	12.217	17.510	22.516
3.319	10.690	15.322	19.702
2.950	9.502	13.619	17.513
2.655	8.552	12.257	15.761
2.213	7.126	10.214	13.134
1.897	6.108	8.755	11.258
1.660	5.345	7.661	9.851
1.475	4.751	6.810	8.756
1.328	4.276	6.129	7.881
1.059	3.563	5.107	6.567
778	3.054	4.378	5.629
596	2.672	3.830	4.925
471	2.375	3.405	4.378
381	2.138	-	-
301	1.900	-	-
244	1.576	-	-
202	1.302	-	-
169	1.094	-	-
144	932	-	-
124	804	-	-
108	700	-	-
95	615	-	-
84	545	-	-
75	486	-	-
68	436	-	-
61	394	-	-
55	357	-	-
50	326	-	-
46	298	-	-
42	274	-	-

**Max payload in N. Suspension for point (F)**

**The values reported are only valid for the fixing rail.  
The maximum payload of all the other construction parts must be verified.**

# CorSTRUT fixing rail

## 3 equal loads

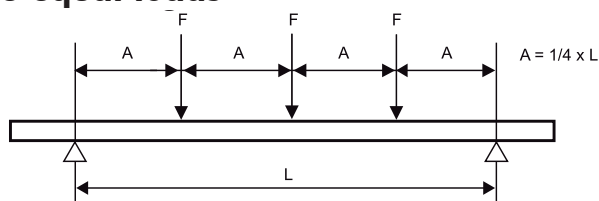

L (mm)	single						
	41x21 1,5	41x21 2,0	41x41 1,5	41x41 2,0	41x41 2,5	41x62 2,5	41x82 2,5
250	924	1,190	2,714	3,278	3,805	7,365	11,517
300	770	992	2,261	2,732	3,171	6,138	9,598
350	660	850	1,938	2,341	2,718	5,261	8,227
400	578	744	1,696	2,049	2,378	4,603	7,198
450	513	661	1,508	1,821	2,114	4,092	6,399
500	462	595	1,357	1,639	1,903	3,683	5,759
600	385	496	1,131	1,366	1,586	3,069	4,799
700	306	396	969	1,171	1,359	2,630	4,113
800	234	303	848	1,024	1,189	2,302	3,599
900	185	239	754	911	1,057	2,046	3,199
1,000	150	194	678	820	951	1,841	2,879
1,200	104	135	565	683	793	1,534	2,399
1,400	77	99	437	524	613	1,315	2,057
1,600	59	76	335	401	469	1,151	1,800
1,800	46	60	264	317	371	1,023	1,600
2,000	38	48	214	257	300	865	1,440
2,250	30	38	169	203	237	684	1,280
2,500	24	31	137	164	192	554	1,146
2,750	20	26	113	136	159	458	947
3,000	17	22	95	114	133	385	796
3,250	14	18	81	97	114	328	678
3,500	12	16	70	84	98	283	585
3,750	11	14	61	73	85	246	509
4,000	-	12	54	64	75	216	448
4,250	-	11	47	57	67	192	397
4,500	-	-	42	51	59	171	354
4,750	-	-	38	45	53	153	317
5,000	-	-	34	41	48	138	287
5,250	-	-	31	37	44	126	260
5,500	-	-	28	34	40	114	237
5,750	-	-	26	31	36	105	217
6,000	-	-	24	29	33	96	199

double			
41x21D	41x41D	41x62D	41x82D
3,540	11,402	16,343	21,015
2,950	9,502	13,619	17,513
2,529	8,144	11,674	15,011
2,213	7,126	10,214	13,134
1,967	6,335	9,079	11,675
1,770	5,701	8,172	10,508
1,475	4,751	6,810	8,756
1,264	4,072	5,837	7,505
1,106	3,563	5,107	6,567
983	3,167	4,540	5,838
885	2,851	4,086	5,254
738	2,375	3,405	4,378
558	2,036	2,918	3,753
427	1,782	2,554	3,284
338	1,584	2,270	2,919
274	1,425	-	-
216	1,267	-	-
175	1,130	-	-
145	934	-	-
122	785	-	-
104	669	-	-
89	577	-	-
78	502	-	-
68	441	-	-
61	391	-	-
54	349	-	-
48	313	-	-
44	283	-	-
40	256	-	-
36	234	-	-
33	214	-	-
30	196	-	-

**Max payload in N. Suspension for point (F)**

The values reported are only valid for the fixing rail.  
The maximum payload of all the other construction parts must be verified.

# CorSTRUT fixing rail

**Load distributed uniformly**

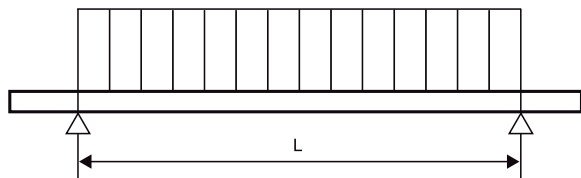

L (mm)	single						
	41x21 1,5	41x21 2,0	41x41 1,5	41x41 2,0	41x41 2,5	41x62 2,5	41x82 2,5
250	3.697	4.762	10.854	13.112	15.222	29.460	46.070
300	3.081	3.968	9.045	10.927	12.685	24.550	38.391
350	2.640	3.401	7.753	9.366	10.873	21.043	32.907
400	2.310	2.976	6.784	8.195	9.514	18.413	28.794
450	2.054	2.645	6.030	7.285	8.457	16.367	25.594
500	1.848	2.381	5.427	6.556	7.611	14.730	23.035
600	1.540	1.984	4.523	5.463	6.342	12.275	19.196
700	1.163	1.503	3.877	4.683	5.436	10.522	16.453
800	891	1.151	3.392	4.098	4.757	9.206	14.397
900	704	909	3.015	3.642	4.228	8.183	12.797
1.000	570	737	2.714	3.278	3.805	7.365	11.517
1.200	396	512	2.260	2.708	3.170	6.138	9.598
1.400	291	376	1.660	1.989	2.329	5.261	8.227
1.600	223	288	1.271	1.523	1.783	4.603	7.198
1.800	176	227	1.004	1.204	1.409	4.059	6.399
2.000	143	184	814	975	1.141	3.288	5.759
2.250	113	146	643	770	902	2.598	5.119
2.500	91	118	521	624	730	2.104	4.355
2.750	75	97	430	516	604	1.739	3.599
3.000	63	82	362	433	507	1.461	3.024
3.250	54	70	308	369	432	1.245	2.577
3.500	47	60	266	318	373	1.074	2.222
3.750	41	52	231	277	325	935	1.936
4.000	36	46	203	244	285	822	1.701
4.250	32	41	180	216	253	728	1.507
4.500	28	36	161	193	225	649	1.344
4.750	25	33	144	173	202	583	1.206
5.000	23	29	130	156	183	526	1.089
5.250	21	27	118	141	166	477	988
5.500	19	24	108	129	151	435	900
5.750	17	22	98	118	138	398	823
6.000	16	20	90	108	127	365	756

double			
41x21D	41x41D	41x62D	41x82D
14.162	45.609	65.372	84.060
11.802	38.007	54.477	70.050
10.116	32.578	46.694	60.043
8.851	28.506	40.858	52.538
7.868	25.338	36.318	46.700
7.081	22.804	32.686	42.030
5.901	19.004	27.238	35.025
5.058	16.289	23.347	30.021
4.426	14.253	20.429	26.269
3.934	12.669	18.159	23.350
3.540	11.402	16.343	21.015
2.887	9.502	13.619	17.513
2.121	8.144	11.674	15.011
1.624	7.126	10.214	13.134
1.283	6.335	9.079	11.675
1.039	5.701	-	-
821	5.068	-	-
665	4.295	-	-
550	3.549	-	-
462	2.983	-	-
394	2.541	-	-
339	2.191	-	-
296	1.909	-	-
260	1.678	-	-
230	1.486	-	-
205	1.326	-	-
184	1.190	-	-
166	1.074	-	-
151	974	-	-
137	887	-	-
126	812	-	-
115	746	-	-

**Max payload in N. Suspension for point (F)**

**The values reported are only valid for the fixing rail.  
The maximum payload of all the other construction parts must be verified.**

# CorSTRUT cantilever arm

## 1 point suspension

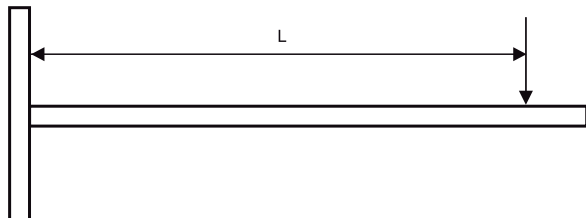

L (mm)	single						
	41x21 1,5	41x21 2,0	41x41 1,5	41x41 2,0	41x41 2,5	41x62 2,5	41x82 2,5
100	1.155	1.488	3.392	4.098	4.757	9.206	14.397
150	770	992	2.261	2.732	3.171	6.138	9.598
200	557	719	1.696	2.049	2.378	4.603	7.198
250	356	460	1.357	1.639	1.903	3.683	5.759
300	247	320	1.131	1.366	1.586	3.069	4.799
350	182	235	969	1.171	1.359	2.630	4.113
400	139	180	794	952	1.114	2.302	3.599
450	110	142	628	752	881	2.046	3.199
500	89	115	508	609	713	1.841	2.879
550	74	95	420	504	589	1.674	2.618
600	62	80	353	423	495	1.427	2.399
700	45	59	259	311	364	1.048	2.057
800	35	45	199	238	279	803	1.661
900	27	36	157	188	220	634	1.313
1.000	22	29	127	152	178	514	1.063
1.100	18	24	105	126	147	425	879
1.200	15	20	88	106	124	357	738
1.300	13	17	75	90	106	304	629
1.400	11	15	65	78	91	262	542
1.500	-	13	56	68	79	228	473

double			
41x21D	41x41D	41x62D	41x82D
4.426	14.253	20.429	26.269
2.950	9.502	13.619	17.513
2.213	7.126	10.214	13.134
1.770	5.701	8.172	10.508
1.475	4.751	6.810	8.756
1.264	4.072	5.837	7.505
1.015	3.563	5.107	6.567
802	3.167	4.540	5.838
650	2.851	4.086	5.254
537	2.591	3.714	4.776
451	2.375	3.405	4.378
331	2.036	2.918	3.753
254	1.638	2.554	3.284
200	1.295	2.270	2.919
162	1.049	2.043	2.627
134	867	1.857	2.388
113	728	1.702	2.189
96	620	1.571	2.021
83	535	1.459	1.876
72	466	1.362	1.751

**Max payload in N.**

**The values reported are only valid for the fixing rail.  
The maximum payload of all the other construction parts must be verified.**

## CorSTRUT cantilever arm

Load distributed uniformly

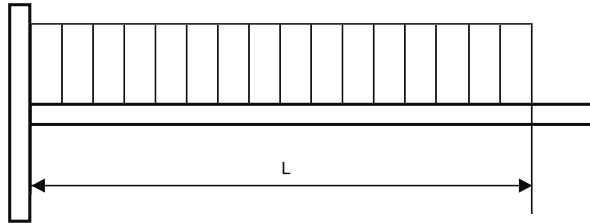

L (mm)	single						
	41x21 1,5	41x21 2,0	41x41 1,5	41x41 2,0	41x41 2,5	41x62 2,5	41x82 2,5
100	2,310	2,976	6,784	8,195	9,514	18,413	28,794
150	1,540	1,984	4,523	5,463	6,342	12,275	19,196
200	1,155	1,488	3,392	4,098	4,757	9,206	14,397
250	924	1,190	2,714	3,278	3,805	7,365	11,517
300	660	853	2,261	2,732	3,171	6,138	9,598
350	485	626	1,938	2,341	2,718	5,261	8,227
400	371	480	1,696	2,049	2,378	4,603	7,198
450	293	379	1,508	1,821	2,114	4,092	6,399
500	238	307	1,356	1,625	1,902	3,683	5,759
550	196	254	1,121	1,343	1,572	3,348	5,235
600	165	213	942	1,128	1,321	3,069	4,799
700	121	157	692	829	970	2,630	4,113
800	93	120	530	635	743	2,140	3,599
900	73	95	418	501	587	1,691	3,199
1,000	59	77	339	406	476	1,370	2,835
1,100	49	63	280	336	393	1,132	2,343
1,200	41	53	235	282	330	951	1,969
1,300	35	45	201	240	281	811	1,678
1,400	30	39	173	207	243	699	1,447
1,500	26	34	151	181	211	609	1,260

double			
41x21D	41x41D	41x61D	41x81D
8,851	28,506	40,858	52,538
5,901	19,004	27,238	35,025
4,426	14,253	20,429	26,269
3,540	11,402	16,343	21,015
2,950	9,502	13,619	17,513
2,529	8,144	11,674	15,011
2,213	7,126	10,214	13,134
1,967	6,335	9,079	11,675
1,732	5,701	8,172	10,508
1,432	5,183	7,429	9,552
1,203	4,751	6,810	8,756
884	4,072	5,837	7,505
677	3,563	5,107	6,567
535	3,167	4,540	5,838
433	2,796	4,086	5,254
358	2,311	3,714	4,776
301	1,942	3,405	4,378
256	1,655	3,143	4,041
221	1,427	2,918	3,753
192	1,243	2,724	3,503

**Max payload in N.**

**The values reported are only valid for the fixing rail.  
The maximum payload of all the other construction parts must be verified.**

## Technical details of square fixing rails

### Properties table

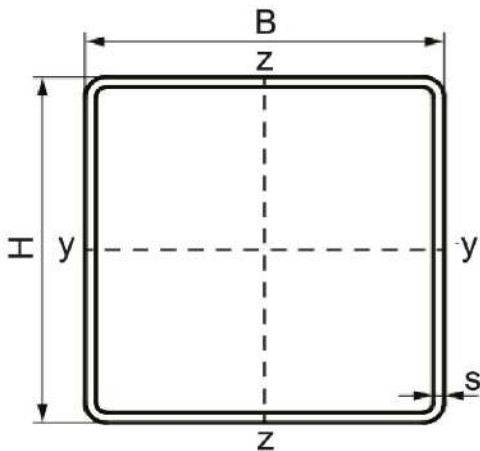

Type Fixing rail			Weight	Cross zone	Geometric moment of inertia		Geometric resistance moment	
H	B	s			A	$I_y$	$I_z$	$W_y$
mm	mm	mm	kg	mm <sup>2</sup>	cm <sup>4</sup>	cm <sup>4</sup>	cm <sup>3</sup>	cm <sup>3</sup>
80	80	3.0	6.64	809.02	80.92	80.92	20.2	20.2
100	100	3.0	8.16	1049.02	166.13	166.13	33.2	33.2

### Perforation type for fixing to wall fixing rails

The distance between the end of the fixing rail and the first hole is always the same.

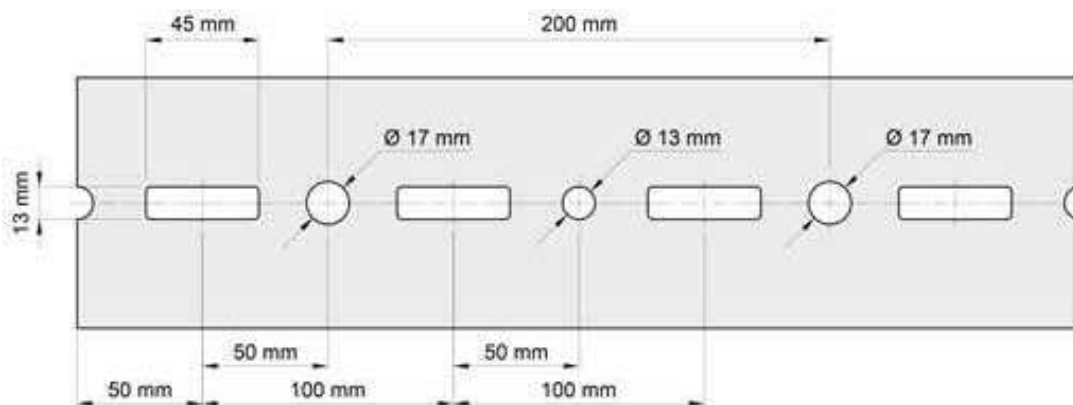



Art. 812590

Square fixing rail



*Technical specifications*

- Closed squared fixing rail
- Offers support for fixings on pipes and devices
- With continuous perforation on all sides
- Material: steel
- Hot dipped galvanised
- For heavy applications

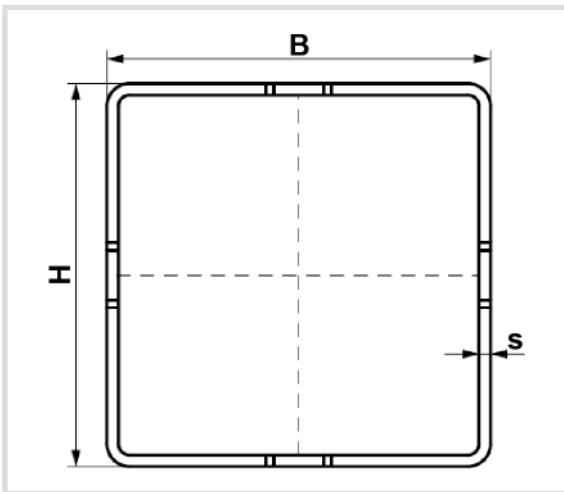

Code	Type	L [m]	B [mm]	H [mm]	s [mm]	Weight [kg/m]
<b>812580</b>	Galvanised	6	80	80	3	6,64
<b>812590</b>	Galvanised	6	100	100	3	8,16

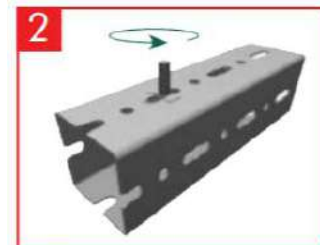
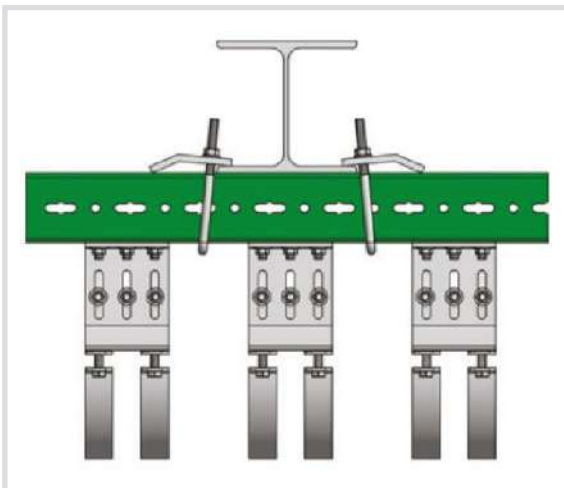

Art. 8651000 Wall plate for square fixing rail



*Technical specifications*

- U-fixing rail welded on wall plate
- For attachment of fixing rails to the wall or floor
- Allows attachment for cantilevered arms with fixing rail on heavy rail
- The slots are compatible with assembly fixing rails
- CO<sub>2</sub> welded
- Material: steel
- Hot dipped galvanised



Code	LxB [mm]	H [mm]	S [mm]	s [mm]	d1 [mm]	d2 [mm]	k [mm]	h [mm]
8650800	185x185	210	81	10	25x14	45x14	130	80
8651000	220x220	210	101	10	24x18	45x14	160	100

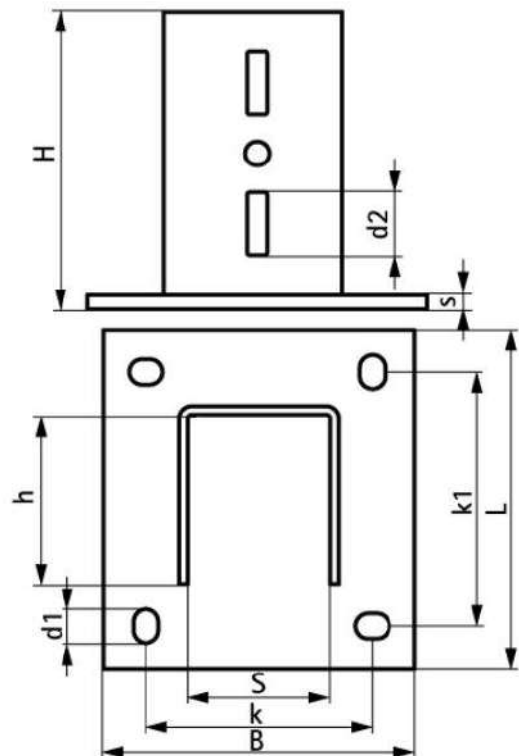

Art. 86512 Hammerfix for square fixing rail



*Technical specifications*

- Pre-assembled and ready to use for quick fixing in fixing rail drilling by pushing and turning 90°
- The hammer head is ideal to fit square fixing rail drilling
- After assembling the slide nut, it must be tightened with a spanner
- Max. torque is 80 Nm
- Material: steel, strength class 8.8
- Hot dipped galvanised
- To be used in combination with washers and hex nuts

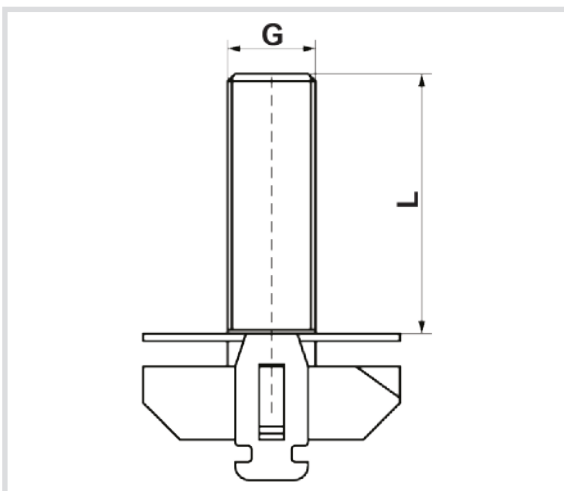

Code	G	L [mm]	Payload [N]
<b>8651240</b>	M12	40	10000
<b>8651275</b>	M12	75	10000

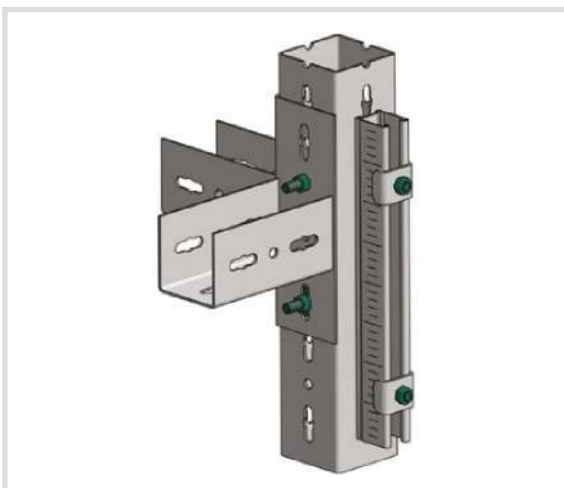

Art. 8651010 Beam Clamp for square fixing rail



*Technical specifications*

- For solid fixing on steel constructions without the need for welding or drilling
- Always use 2 beam clamps for fastening
- Material: steel
- Hot dipped galvanised

Code

**8651010**

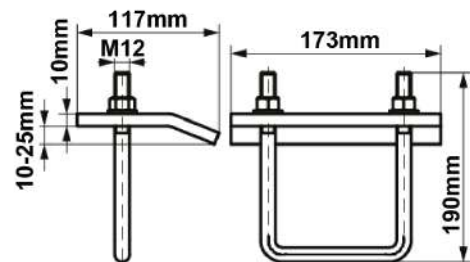
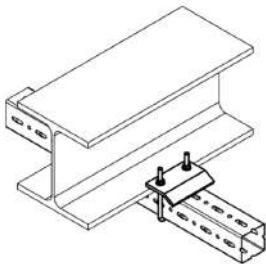

Art. 8655090 Profile Connector 90° for square fixing rail



*Technical specifications*

- For perpendicular connection to heavy rail fixing rails
- With slotted holes for easy attachment
- Material: steel
- Hot dipped galvanised

Code	Model	LxB [mm]	H [mm]	s [mm]	d1 [mm]	k [mm]	Weight [Kg]
<b>8655090</b>	3 fori	200x100	100	10	45x14	100	1,90

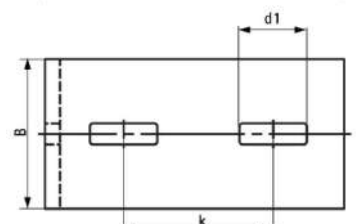
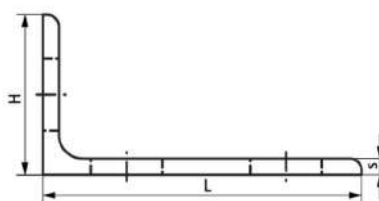

Art. 8652 Bolt for square fixing rail



*Technical specifications*

- For attachment in fixing rail drilling
- The bolt size is ideal to fit fixing rail holes
- Max. torque is 80 Nm
- Hex nut with clamp
- Material: steel, strength class 8.8
- Hot dipped galvanised
- It consists of: 1 bolt, 1 nut, 1 washer

Code	G	L [mm]
<b>8652260</b>	M12	160
<b>8652660</b>	M16	160

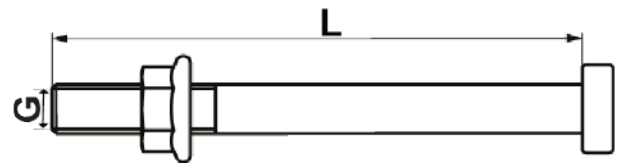

Art. 8650335 Front connection for square fixing rail



*Technical specifications*

- Corresponds to the shape and size of the square fixing rail
- The distance from the centre is compatible with the drilling of the square fixing rail
- Delivery and assembly always in pairs (1 piece = set of 2 halves)
- Material: steel
- Hot dipped galvanised

Code	Peso [Kg]	L [mm]
<b>8650335</b>	5,50	405

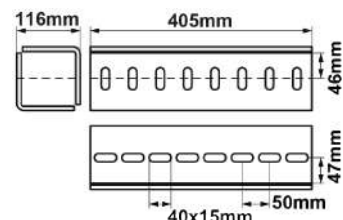

L (mm)	80x80	80x80	80x80	80x80
	1 x F	2 x F	3 x F	Continuous
2,000	6,109	4,587	3,054	12,218
2,250	5,415	4,067	2,707	10,830
2,500	4,858	3,650	2,429	9,716
2,750	4,400	3,099	2,200	8,449
3,000	4,018	2,588	1,856	7,055
3,250	3,693	2,188	1,570	5,966
3,500	3,186	1,870	1,341	5,099
3,750	2,747	1,612	1,156	4,396
4,000	2,386	1,400	1,004	3,818
4,250	2,085	1,223	877	3,336
4,500	1,830	1,074	770	2,929
4,750	1,614	947	679	2,582
5,000	1,427	838	601	2,284
5,250	1,266	743	533	2,025
5,500	1,124	660	473	1,799
5,750	999	586	420	1,599
6,000	888	521	374	1,422

**Max payload in N. for suspension point (F).**  
**The values reported are only valid for the fixing rail.**  
**The maximum payload of all the other construction parts must be verified.**

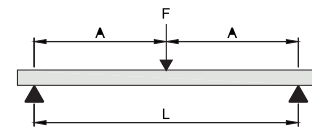

$$A=1/2xL$$

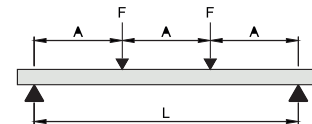

$$A=1/3xL$$

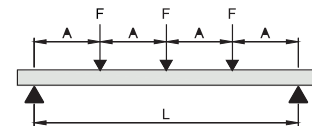

$$A=1/4xL$$

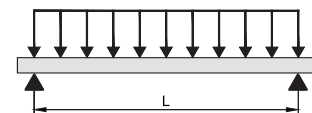

L (mm)	80x80	80x80
	1 x F	Continuous
500	4,877	9,770
550	4,430	8,878
600	4,058	8,135
650	3,742	7,506
700	3,472	6,967
750	3,237	6,499
800	3,032	6,090
850	2,850	5,729
900	2,689	5,407
950	2,544	5,119
1,000	2,414	4,860
1,050	2,286	4,626
1,100	2,079	4,412
1,200	1,740	4,038
1,300	1,476	3,721
1,400	1,266	3,376
1,500	1,096	2,923

**Max payload in N. for suspension point (F).**  
**The values reported are only valid for the fixing rail.**  
**The maximum payload of all the other construction parts must be verified.**

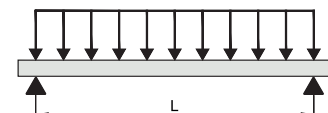

L (mm)	100x100	100x100	100x100	100x100
	1 x F	2 x F	3 x F	Continuous
2,000	10,056	7,549	5,028	20,112
2,250	8,919	6,697	4,459	17,838
2,500	8,007	6,014	4,003	16,014
2,750	7,259	5,453	3,629	14,518
3,000	6,633	4,985	3,316	13,267
3,250	6,103	4,552	3,051	12,206
3,500	5,647	3,903	2,800	10,641
3,750	5,250	3,378	2,423	9,210
4,000	4,901	2,947	2,114	8,035
4,250	4,411	2,589	1,857	7,058
4,500	3,897	2,287	1,641	6,236
4,750	3,460	2,031	1,457	5,536
5,000	3,085	1,811	1,299	4,936
5,250	2,761	1,620	1,162	4,417
5,500	2,477	1,454	1,043	3,964
5,750	2,229	1,308	938	3,566
6,000	2,009	1,179	846	3,215
6,500	1,639	962	690	2,622
7,000	1,339	786	564	2,143
7,500	1,093	641	460	1,748
8,000	886	520	373	1,418

**Max payload in N. for suspension point (F).**  
**The values reported are only valid for the fixing rail.**  
**The maximum payload of all the other construction parts must be verified.**

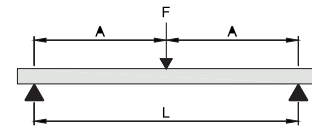

$$A=1/2xL$$

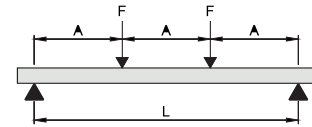

$$A=1/3xL$$

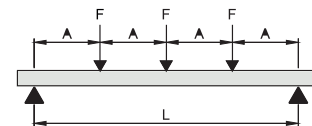

$$A=1/4xL$$

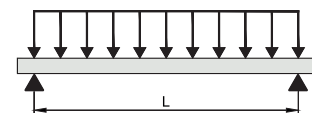

L (mm)	100x100	100x100
	1 x F	Continuous
500	6,963	13,947
550	6,325	12,675
600	5,794	11,614
650	5,344	10,717
700	4,959	9,947
750	4,624	9,280
800	4,331	8,696
850	4,072	8,180
900	3,842	7,722
950	3,635	7,311
1,000	3,449	6,941
1,050	3,281	6,607
1,100	3,128	6,302
1,200	2,859	5,769
1,300	2,631	5,317
1,400	2,435	4,929
1,500	2,264	4,592

**Max payload in N. for suspension point (F).**  
**The values reported are only valid for the fixing rail.**  
**The maximum payload of all the other construction parts must be verified.**

