

CorSTRUT fixing rail technical details

Table of properties

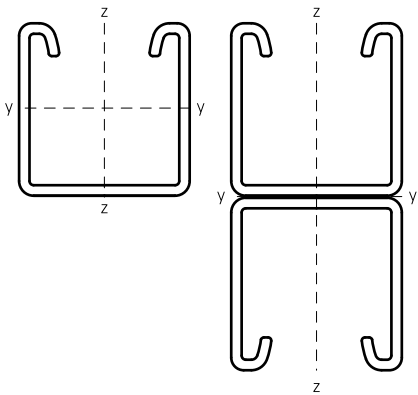

Type (3 m)	Weight [kg/m]	Moment of inertia		Static moment	
		I_y	I_z	W_y	W_z
41x21 - 1,5	1,15	0,78	3,70	0,72	1,80
41x41 - 1,5	1,65	4,46	6,20	2,12	3,00
41x21 - 2,0	1,78	1,01	5,40	0,93	2,61
41x41 - 2,0	2,35	5,34	7,79	2,56	3,77
41x41 - 2,5	2,45	6,26	9,30	2,97	4,50
41x62 - 2,5	3,33	18,03	13,20	5,75	6,39
41x82 - 2,5	4,08	37,31	16,89	9,00	8,18

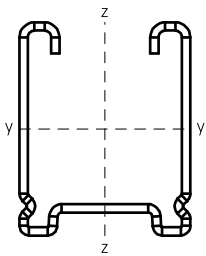

CorSTRUT - 1,5 mm

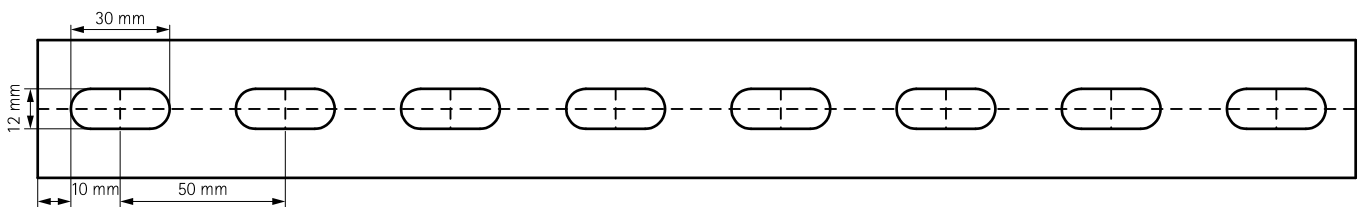

CorSTRUT - 2,0 / 2,5 mm

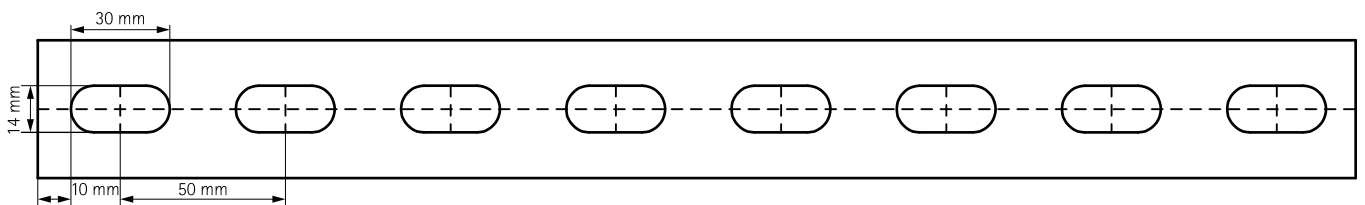

Art. 8125 CorSTRUT fixing rail



Technical specifications and advantages

- Made of pre-galvanised S235JR steel
- The distance between the end of the fixing rail and the first hole is always the same
- Available with hot-dip galvanisation (upon request)
- Tested for safety against fire
- Plasticity load: 240 N/mm²
- With notches on the inside for greater adhesion of the components
- For information on the maximum permitted loads, refer to the load tables

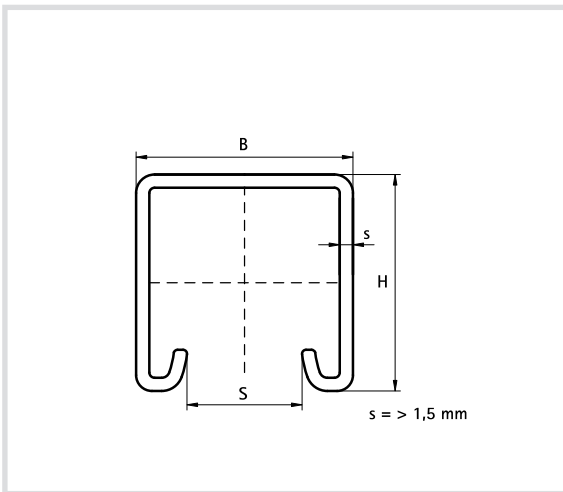

Code	Measurements B x H [mm]	Thickness (s) [mm]	Length [mm]	S [mm]
CorSTRUT Fixing rails				
812501	41 x 21	1,5	3000	22
812502	41 x 21	2,0	3000	22
812504	41 x 41	1,5	3000	22
812505	41 x 41	2,0	3000	22
812508	41 x 41	2,5	3000	22
812509	41 x 41	2,0	6000	22
812511	41 x 62	2,5	3000	22
812512	41 x 62	2,5	6000	22
812514	41 x 82	2,5	3000	22
Double CorSTRUT fixing rails				
812526	41 (2x41)	2,5	3000	22
812528	41 (2x62)	2,5	3000	22

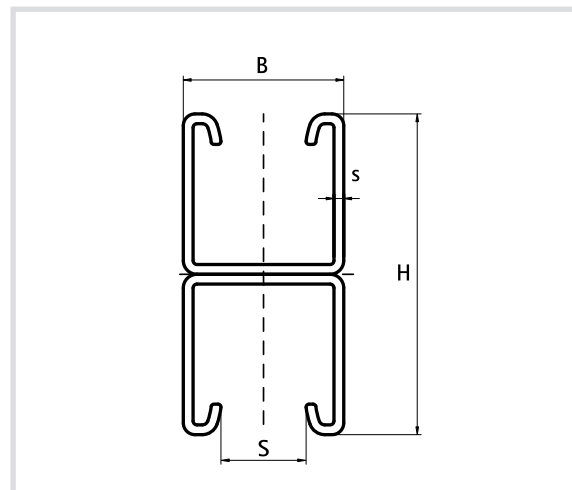

Art. 812520 Slotted CorSTRUT fixing rail



Technical specifications and advantages

- Made of pre-galvanised S235JR steel
- The distance between the end of the fixing rail and the first hole is always the same
- Available with hot-dip galvanisation (upon request)
- Tested for safety against fire
- With notches on the inside for greater adhesion of the components
- Slotted on all sides of the fixing rail

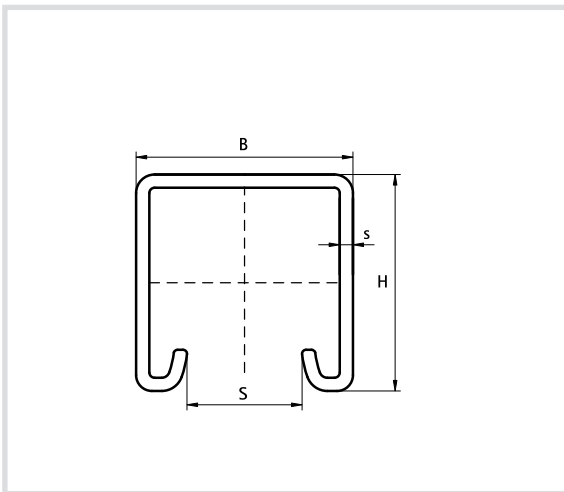

Code	Measurements B x H [mm]	Thickness (s) [mm]	Length [mm]	S [mm]
812520	41 x 41	2,5	3000	22

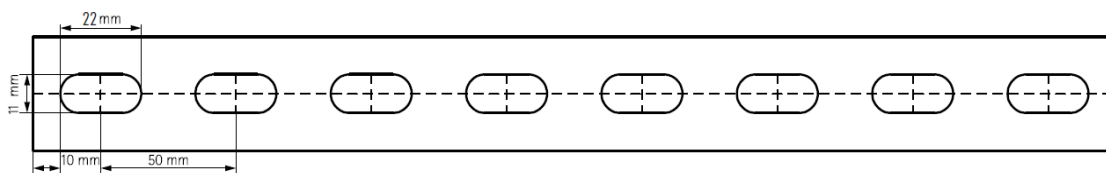

Art. 827 CorSTRUT cantilever arm



Technical characteristics and advantages

- Made of S235JR steel
- Galvanised
- CO₂ welding
- Slots on the plate at 90° to simplify assembly
- They can also be supplied hot-dip galvanised

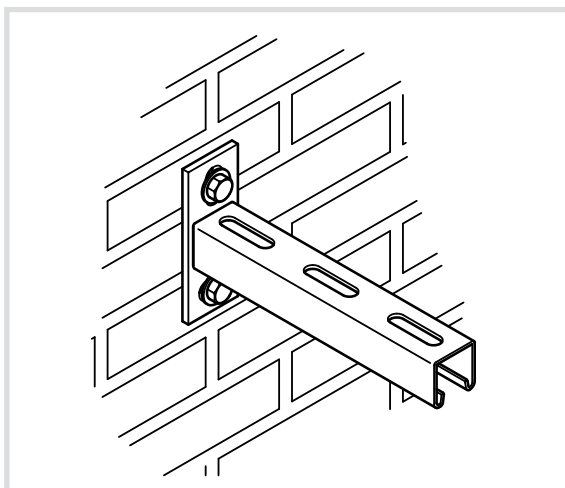
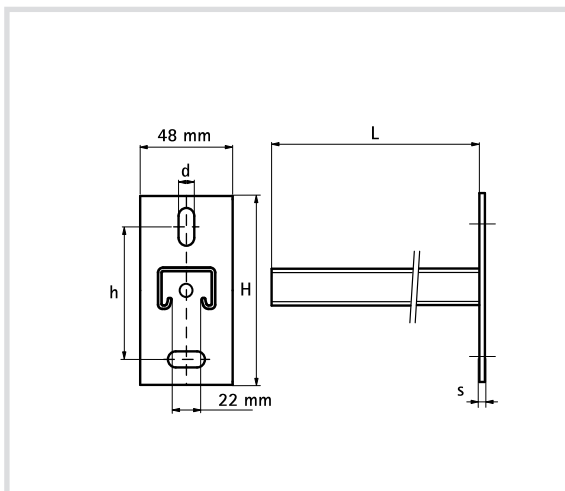

Code	L [mm]	H [mm]	h [mm]	Fixing rail	s [mm]	Holes [mm]
827220	200	110	70,0	41x21x2,5	5,0	25x11
827230	300	110	70,0	41x21x2,5	5,0	25x11
827330	300	130	87,5	41x41x2,0	7,0	30x13
827345	450	130	87,5	41x41x2,0	7,0	30x13
827360	600	130	87,5	41x41x2,0	7,0	30x13
827020	200	130	87,5	41x41x2,5	7,0	30x13
827030	300	130	87,5	41x41x2,5	7,0	30x13
827045	450	130	87,5	41x41x2,5	7,0	30x13
827060	600	130	87,5	41x41x2,5	7,0	30x13
827075	750	130	87,5	41x41x2,5	7,0	30x13
827100	1000	130	87,5	41x41x2,5	7,0	30x13
827120	1200	130	87,5	41x41x2,5	7,0	30x13

Art. 8692 CorSTRUT double cantilever arm



Technical specifications

- Made of steel
- Slots at 90° on the plate
- Hot galvanised

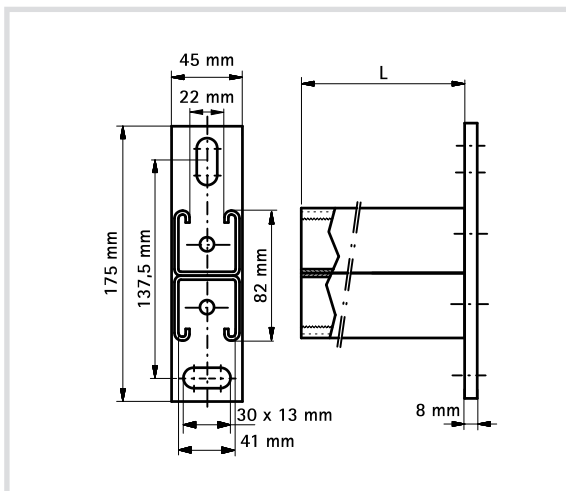

Code	L [mm]	Fixing rail
8692450	450	41 x (2x41) x2,5
8692600	600	41 x (2x41) x2,5
8692750	750	41 x (2x41) x2,5
8692999	1000	41 x (2x41) x2,5



Art. 8694 Hot-dip galvanised CorSTRUT cantilever arm with rail prop



Caratteristiche tecniche

- Made of 1.0332 steel
- Hot galvanised
- With CO₂ welded rail prop

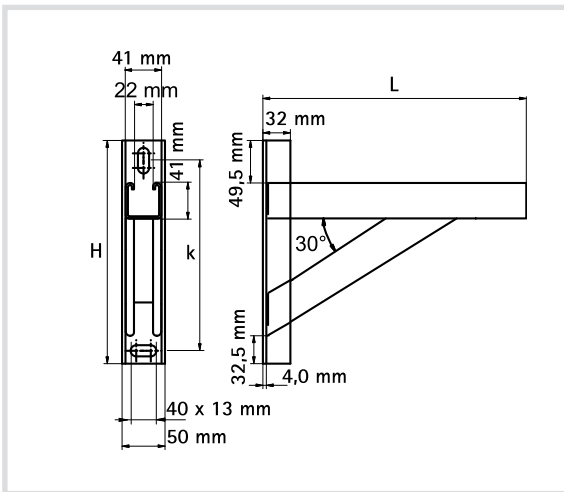

Code	L [mm]	H [mm]	Fixing rail	k [mm]
8694060	600	350	41 x 41	311,5

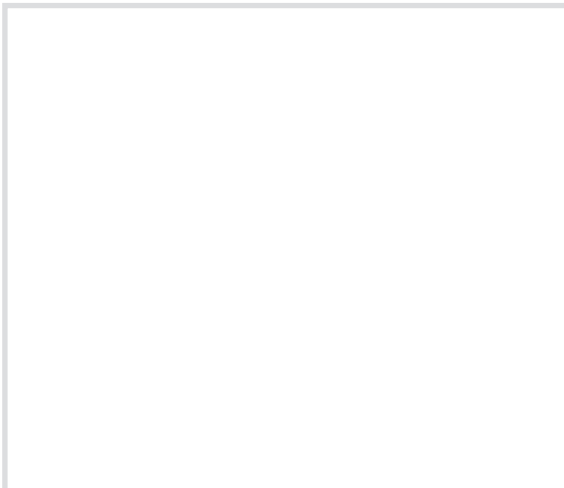

Art. 8693 Rail prop for CorSTRUT



Technical specifications and advantages

- Made with S235JR steel
- Galvanised
- CO₂ welding
- Made using Strut fixing rail
- To increase the load by fixing above or below the cantilever arm
- 45° inclination
- Very elongated slot to ensure the correct coupling is used with the holes of the cantilever arm

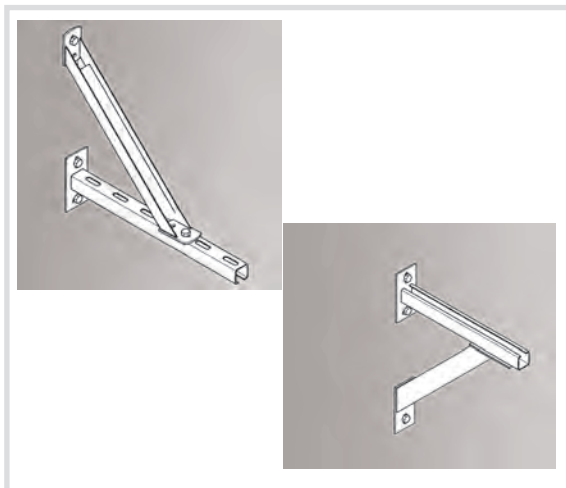
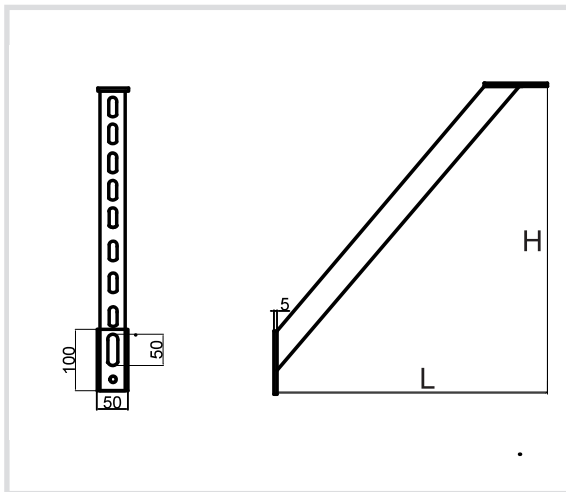

Code	L [mm]	H [mm]	Slotted hole [mm]
8693340	340	340	50x13
8693510	540	540	50x13

Art. 8691200 Angle bracket



Technical specifications and advantages

- Support in one piece
- To reinforce a cantilever arm by fixing it from below, above or to the side
- Material: steel, 1.0332

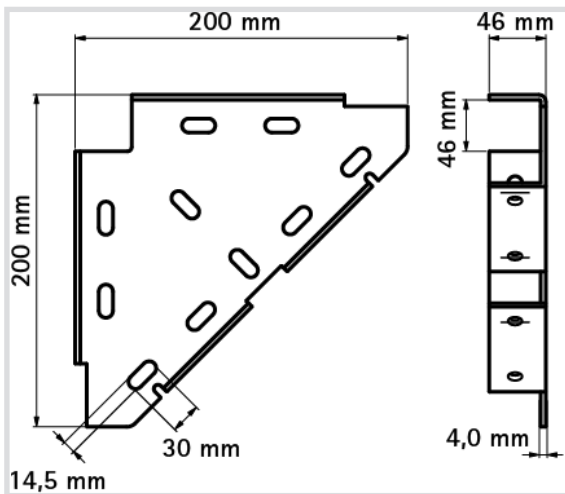

Code	Fixing rail	Dimensions [mm]
8691200	CorSTRUT and CH35	200x200

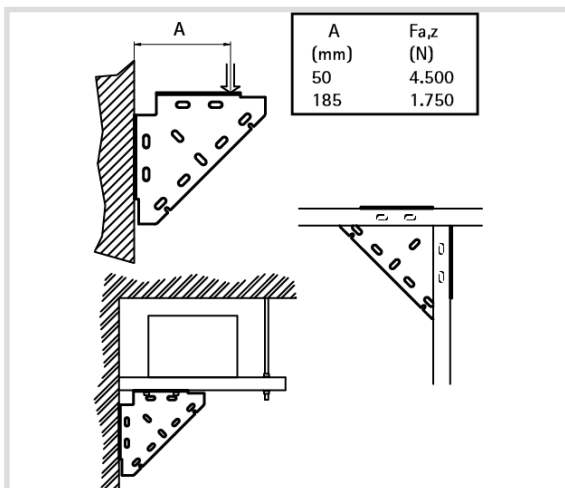

Art. 8630000 CorSTRUT wall plate with side holes and pre-assembled bolts



Technical specifications and advantages

- Made with 1.0332 steel
- Slots on the base at 90° to simplify assembly
- Hot-dip galvanised
- Tested for fire resistance
- With pre-fitted bolts

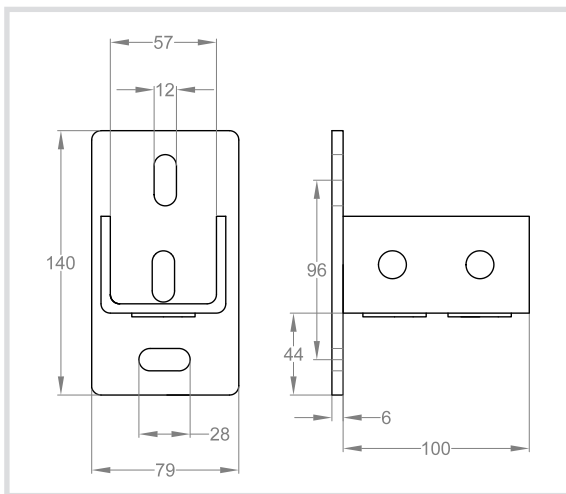

Code	Fixing rails
8630000	41x21 e 41x41

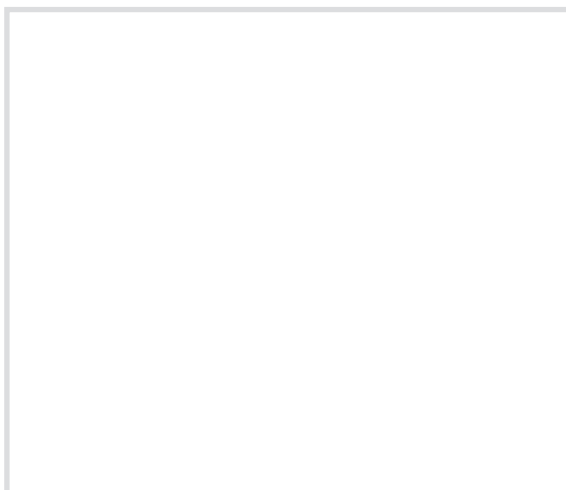

Art. 8630200 CorSTRUT wall plate, rail 41x62, 41x82 41x(2x41) with pre-assembled bolts



Technical specifications and advantages

- Made with 1.0332 steel
- CO₂ welding
- Hot-dip galvanised
- Suitable for CorSTRUT fixing rail 41x62, 41x82, 41x(2x41)
- With pre-assembled bolts
- Slots on the base at 90° to simplify assembly

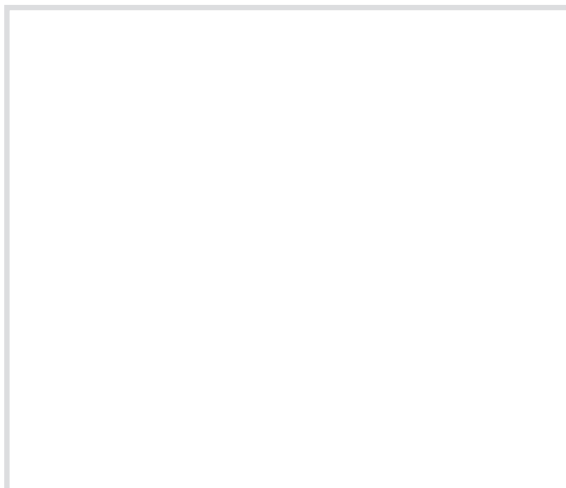
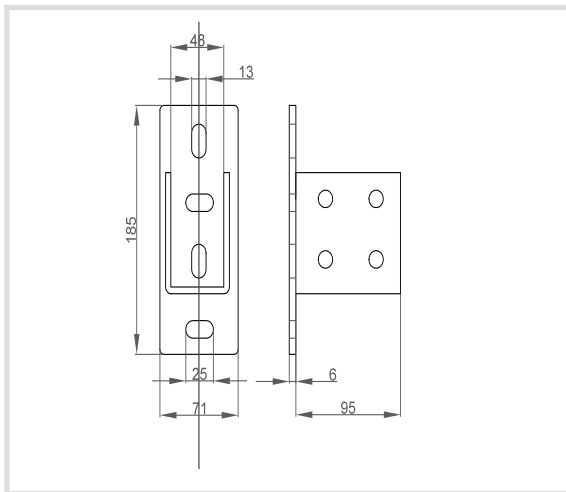

Code	Fixing rails
8630200	4x62, 41x82, 41x(2x41)

Art. 8634 Wall plate for CorSTRUT structures



Technical specifications and advantages

- Made with 1.0332 steel
- CO₂ welding
- Slots on the base at 90° to simplify assembly
- Hot-dip galvanised

Code	Fixing rail
8634041	41x41
8634062	41x62
8634082	41x82

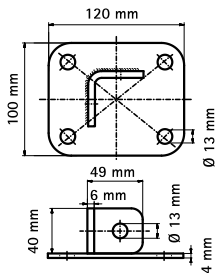

8634041

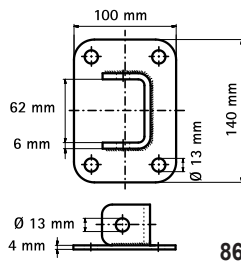

8634062

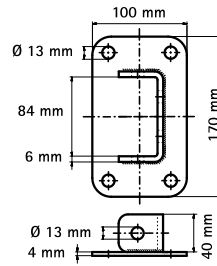

8634082

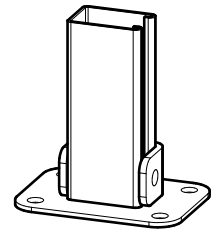

Art. 8634141 CorSTRUT wall plate with square base

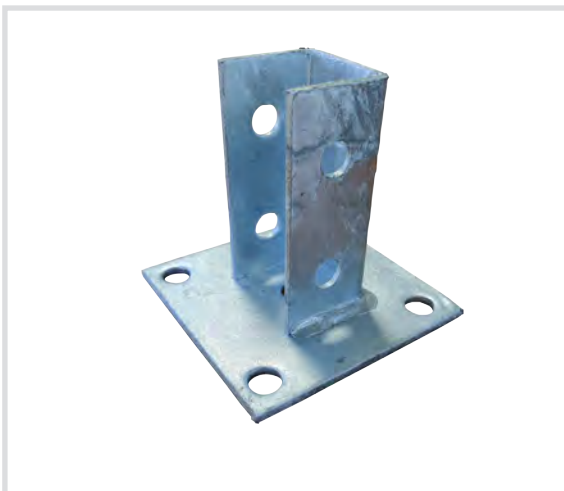

Technical specifications and advantages

- Made with 1.0332 steel
- Hot-dip galvanised
- Base with 4 holes
- The lateral holes allow assembly of the CorSTRUT fixing rail in any orientation
- CO₂ welding

Code	Fixing rail
8634141	41x41

Art. 8633 Wall plate for double CorSTRUT fixing rail



Technical specifications and advantages

- Made with 1.0332 steel
- Hot-dip galvanised
- CO₂ welding
- Slots on the base at 90° to simplify assembly

Code	Fixing rail
8633041	41x41
8633082	41x82

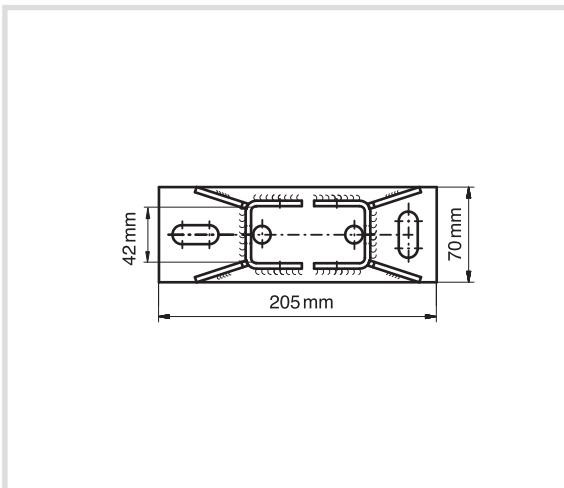
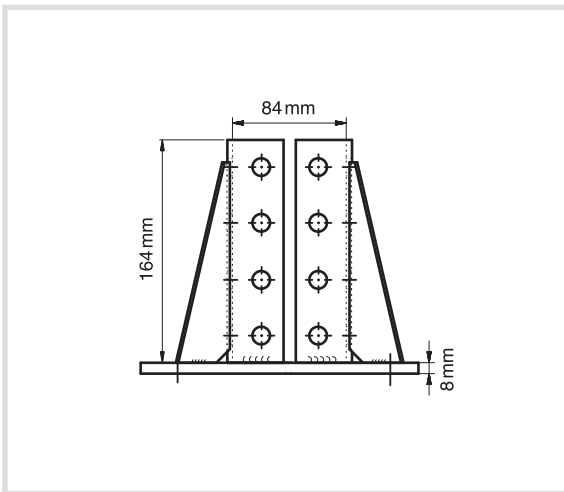

Art. 86320 Open fixing rail support for CorSTRUT with pre-assembled bolts

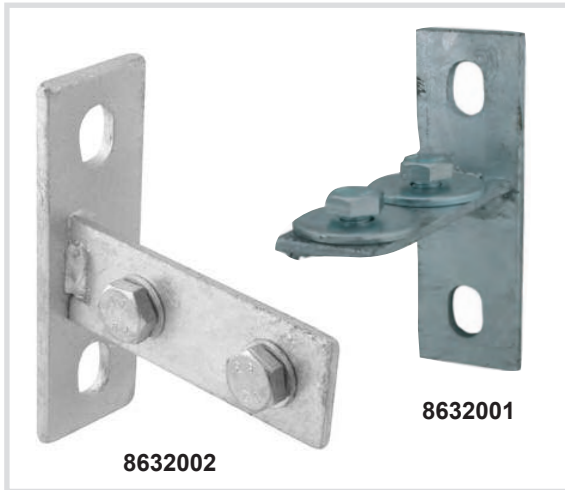

Technical specifications

- With pre-assembled nuts
- Material: 1.0332 steel
- Hot-dip galvanised

Code	Fixing rail
8632001	41x41
8632002	41x41

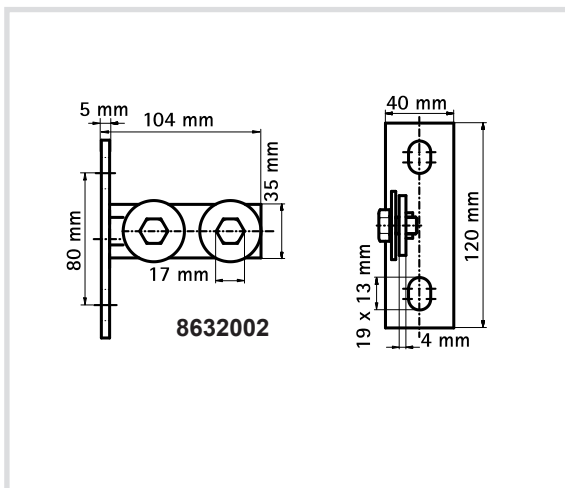
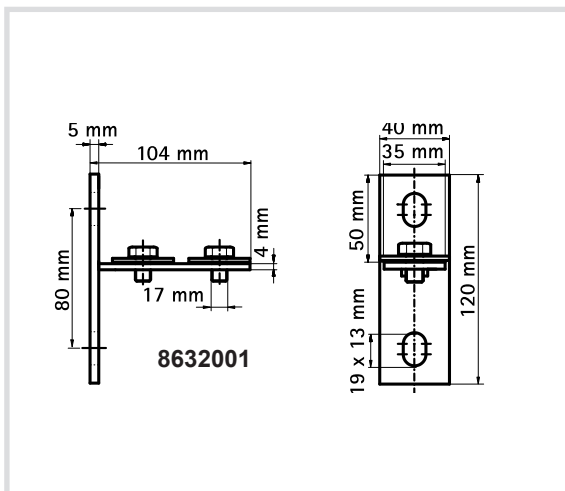

Art. 861 Slide nut for CorSTRUT

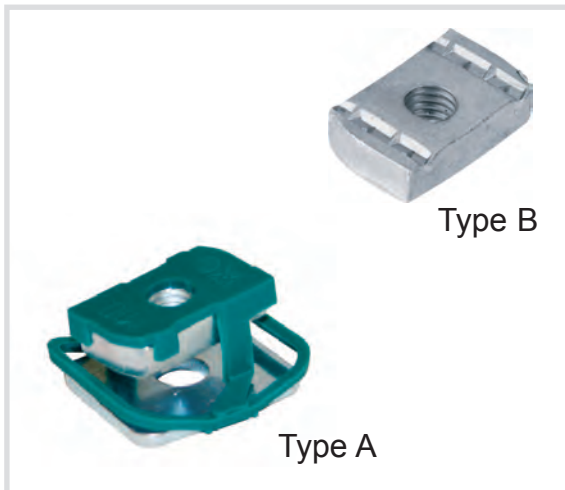

Technical specifications and advantages

- Made with 1.0332 steel
- With pre-assembled plastic spring for easy assembly
- Spring in polyoxymethylene (POM), green (RAL 6026)
- Tested for fire resistance

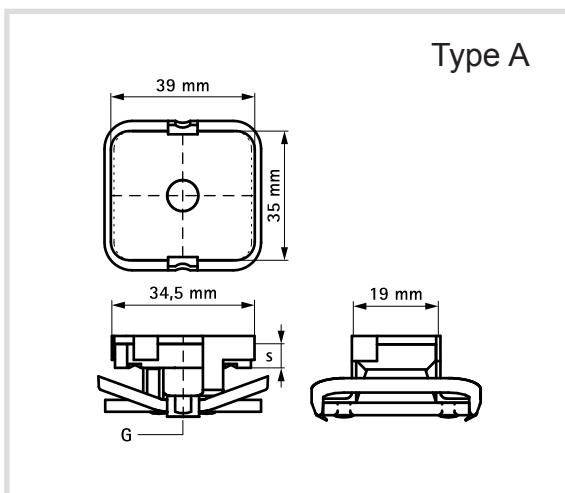

Code	G	Type	s [mm]	Payload [N]
8610006	M6	A	6,0	6000
8610008	M8	A	6,0	6000
8610010	M10	A	8,0	9500
8610012	M12	A	9,0	10000
8611006	M6	B	5,0	5300
8611008	M8	B	6,0	6000
8611010	M10	B	8,0	9500
8611012	M12	B	9,0	10000

HOT GALVANISED

8612006	M6	B	5,0	5300
8612008	M8	B	6,0	6000
8612010	M10	B	8,0	9500
8612012	M12	B	9,0	10000

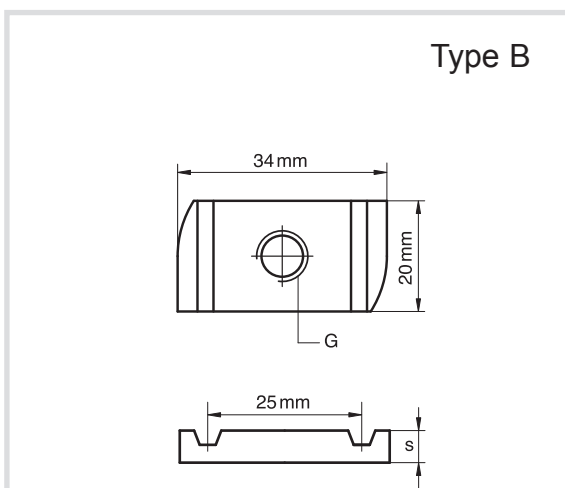

Art. 86111 Slide nut for CorSTRUT with steel spring and washer



Technical specifications

- Made with 1.0332 steel
- With pre-assembled steel spring for easy assembly
- Tested for fire resistance

Code	G	H [mm]
8611106	M6	6
8611108	M8	6
8611110	M10	8
8611112	M12	9

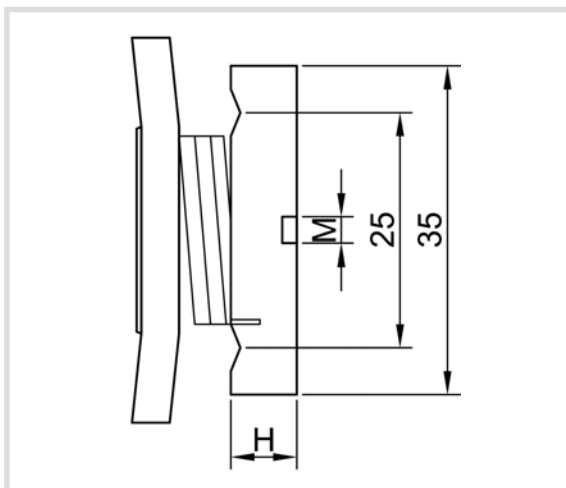
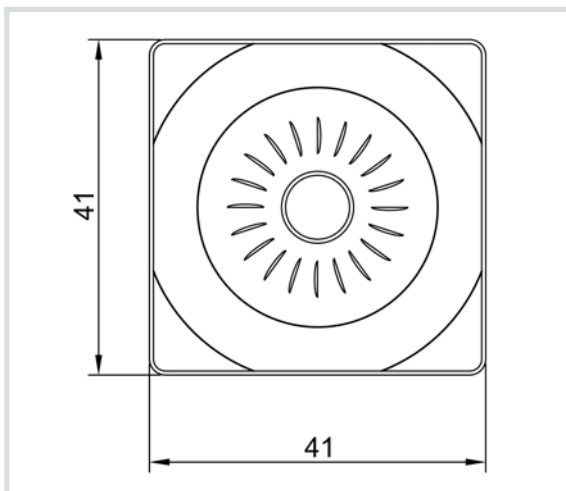

Art. 862 CorSTRUT slide nut with spring



Technical specifications and advantages

- Material: steel slide nut 1.0332;
steel spring DIN 17223 (class A)
- Galvanised

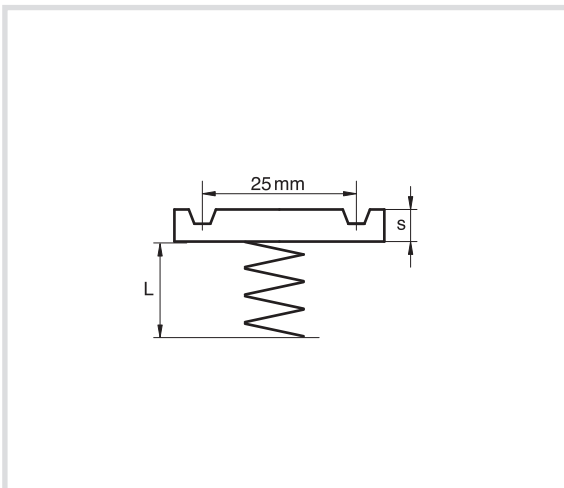
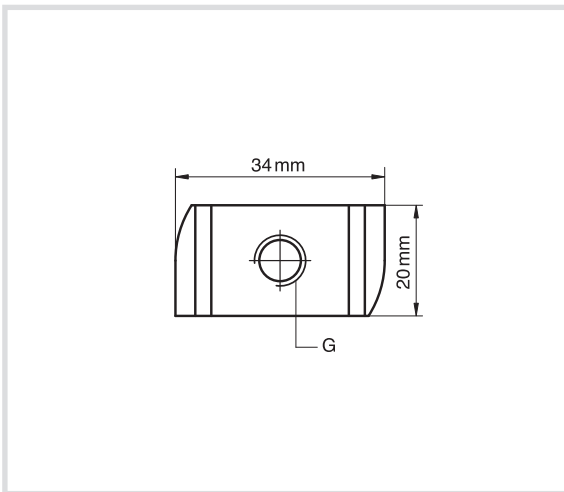

Code	G	For	L [mm]	s [mm]	Payload [N]
8620006	M6	CorSTRUT 41x21	13	5,0	5300
8620008	M8	CorSTRUT 41x21	13	6,0	6000
8620010	M10	CorSTRUT 41x21	13	8,0	9500
8620012	M12	CorSTRUT 41x21	13	9,0	10000
8621006	M6	CorSTRUT 41x41	13	5,0	5300
8621008	M8	CorSTRUT 41x41	33	6,0	6000
8621010	M10	CorSTRUT 41x41	33	8,0	9500
8621012	M12	CorSTRUT 41x41	33	9,0	10000
HOT GALVANISED					
8622006	M6	CorSTRUT 41x21	13	5,0	5300
8622008	M8	CorSTRUT 41x21	13	6,0	6000
8622010	M10	CorSTRUT 41x21	13	8,0	9500
8622012	M12	CorSTRUT 41x21	13	9,0	10000
HOT GALVANISED					
8623006	M6	CorSTRUT 41x41	33	5,0	5300
8623008	M8	CorSTRUT 41x41	33	6,0	6000
8623010	M10	CorSTRUT 41x41	33	8,0	9500
8623012	M12	CorSTRUT 41x41	33	9,0	10000

Art. 6527 Slide nut with threaded pin for CorSTRUT



Technical specifications and advantages

- Slide nut with threaded pin, square washer and plastic spring
- Made with S235JR steel
- Galvanised
- Spring in POM (polyoxymethylene), green
- With a plastic spring that keeps the piece fixed in the desired position until final tightening
- Possibility of height adjustment of the pin
- Tested for fire resistance

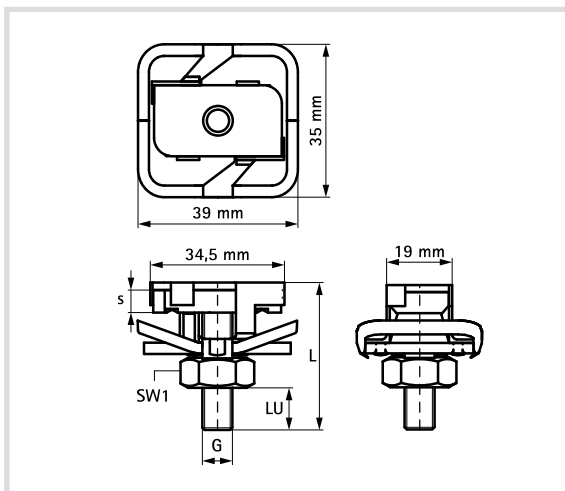

Code	G	L [mm]	s [mm]	SW1 [mm]	LU [mm]	Fa,z [N]
652785804	M8	40	6,0	13	16	6000
652785806	M8	60	6,0	13	36	6000
652785808	M8	80	8,0	13	56	6000
652785810	M8	100	8,0	13	76	6000
652785004	M10	40	8,0	17	12	6000
652785006	M10	60	8,0	17	32	6000
652785008	M10	80	8,0	17	52	6000
652785204	M12	40	10,0	19	10	10000
652785206	M12	60	10,0	19	30	10000
6527208	M12	80	10,0	19	50	10000

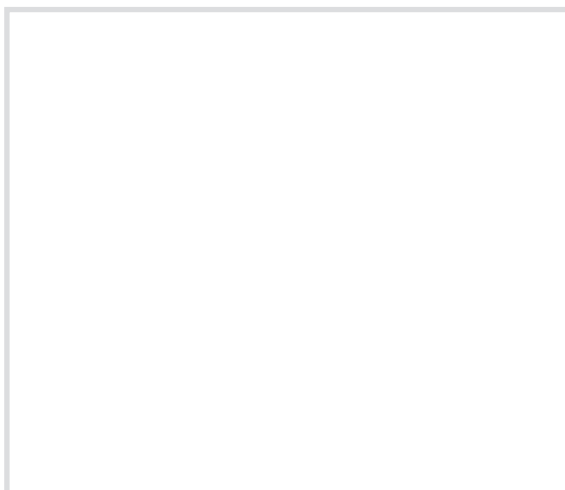

Art. 6653 Ball swivel hangers CorSTRUT with height adjuster



Technical specifications and advantages

- Made with 1.0332 galvanised steel
- Spring: POM (polyoxymethylene), green
- With inspection hole to check the adjustment
- With pre-assembled plastic spring
- Recommended for metal pipes up to DN 50, for plastic pipes up to DN 100

Code	G	L [mm]	s [mm]	SW1 [mm]	SW2 [mm]	LU [mm]
66530805	M8	50	6,0	13	10	37,5
66530005	M10	50	8,0	13	12	34,5
66530206	M12	94	10,0	-	-	32,0

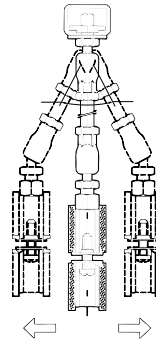
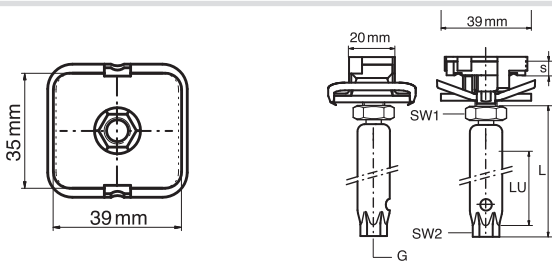

Art. 86351 Adjustable universal brace



Technical specifications and advantages

- To create braces, struts, inclined installations up to 180°
- Fully adjustable angle
- With 2 through holes diam. 13 mm
- Material: steel

Code	Diameter of holes [mm]
8635180	13

Art. 86010

Universal brace for M10/M12 threaded rods



Technical specifications and advantages

- In galvanised steel
- To reinforce a fixing rail structure with the help of M10-M12 threaded rods
- It is also suitable to reinforce cantilever arms
- Suitable to create seismic fixings

Code	R	Hole [mm]
8601012	M10-M12	13

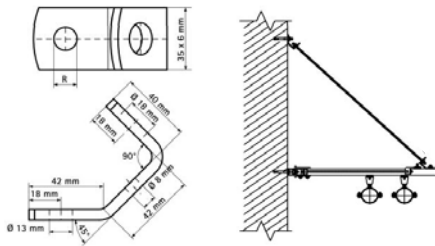

Art. 901816 CorSTRUT square slide nut



Technical specifications and advantages

- Material: 1.0332 steel
- Hot-dip galvanised
- Tested for fire resistance



Code	G
901816	M16

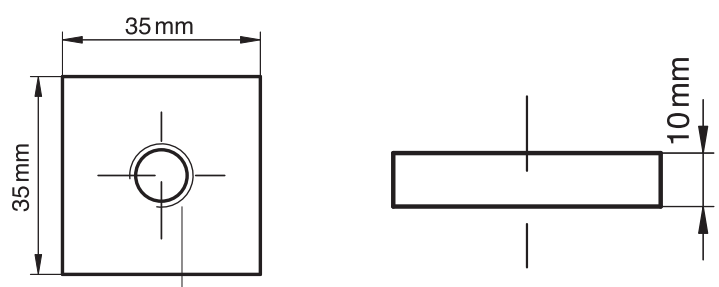

Art. 9015 Washer for CorSTRUT

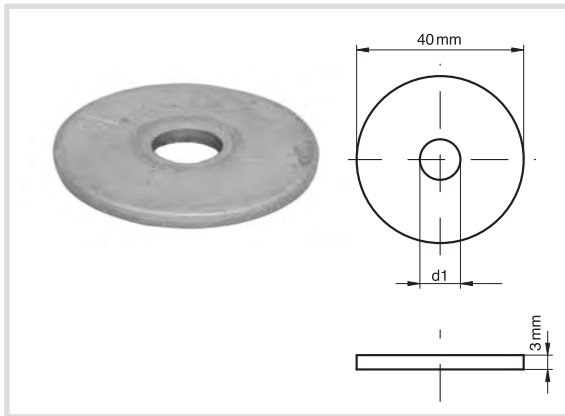

Technical specifications and advantages

- Flat washer
- Material: 1.0332 steel
- Hot galvanised

Code	d1 [mm]
901506	Ø 6,5
901508	Ø 8,5
901510	Ø 10,5
901512	Ø 12,5
901516	Ø 17

Art. 9016 U-shaped complement (washer) for CorSTRUT

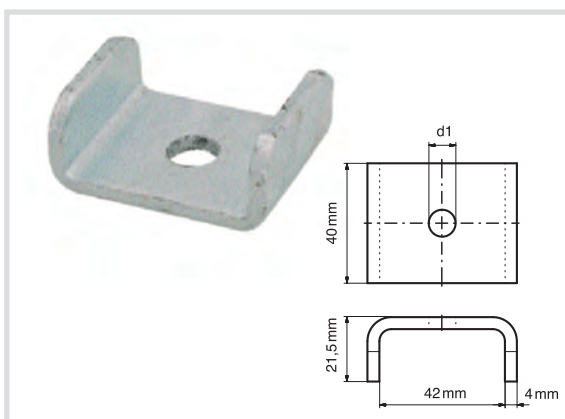

Technical specifications and advantages

- Made with 1.0332 steel
- Hot dipped galvanised

Code	Ø Hole [mm]
901608	9,0
901610	11,0
901612	13,0
901616	17,0



Art. 9017 Square washer for CorSTRUT

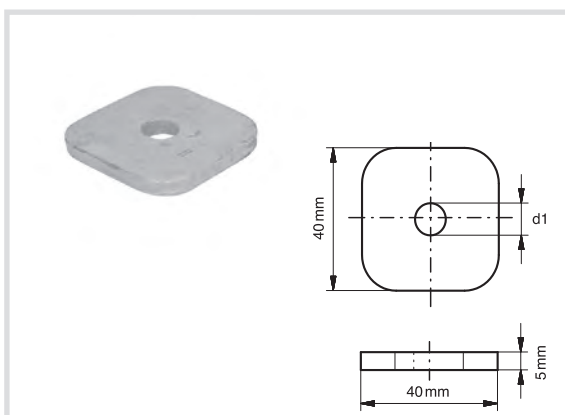

Technical specifications and advantages

- Made with 1.0332 steel
- Hot-dip galvanised

Code	d1 [mm]
901708	Ø 9,0
901710	Ø 11,0
901712	Ø 13,0

Art. 6658 90° and 45° angle brackets including slide nuts and bolts



Technical specifications and advantages

- Made with 1.0332 galvanised steel
- Spring: POM (polyoxymethylene), green
- To build supports or suspension elements
- Includes pre-assembled slide nuts to hold the piece in place until tightened
- Guaranteed adjustment



Code	Type	α (°)	Nuts
665885205	long / long	90	4
665885235	long / long	135	4
665885203	short / long	90	3

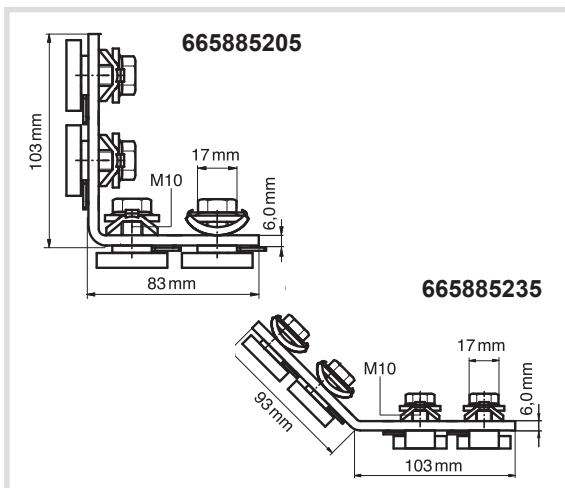

Art. 8600 90° angle brackets with two holes



Technical specifications and advantages

- Made with S235JR steel
- Hot-dip galvanised

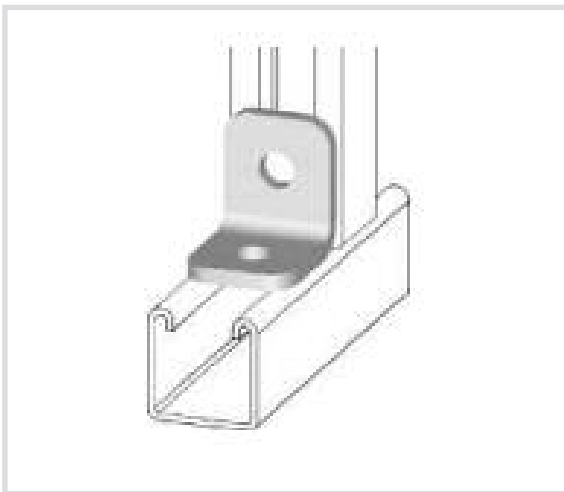

Code	Dimensions [mm]	Thickness S [mm]	Diameter of holes [mm]
8600049	49x49	6,0	13
8600057	57x41	6,0	13

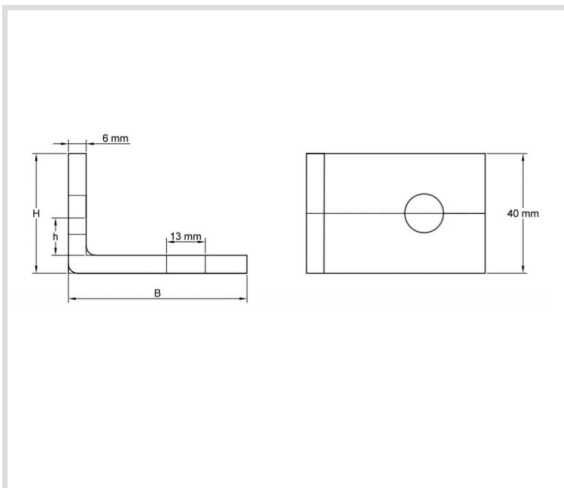

Art. 8600903 90° angle brackets with three holes



Caratteristiche tecniche e vantaggi

- Made with S235JR steel
- Hot-dip galvanised
- Slotted hole to simplify attachment

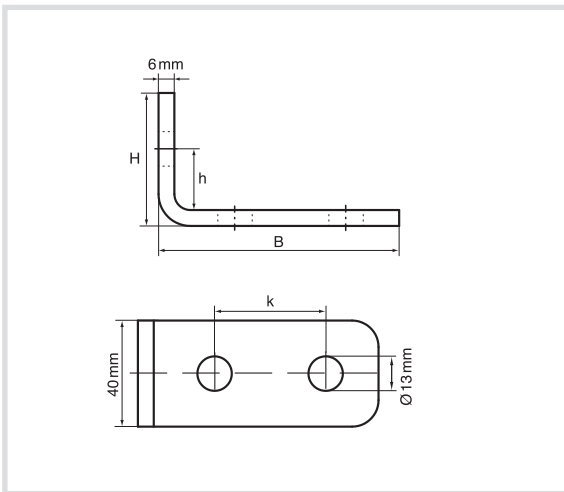

Code	BxH [mm]	Thickness S [mm]	Diameter of holes [mm]	Slotted hole [mm]
8600903	95x57	6,0	13	22x10

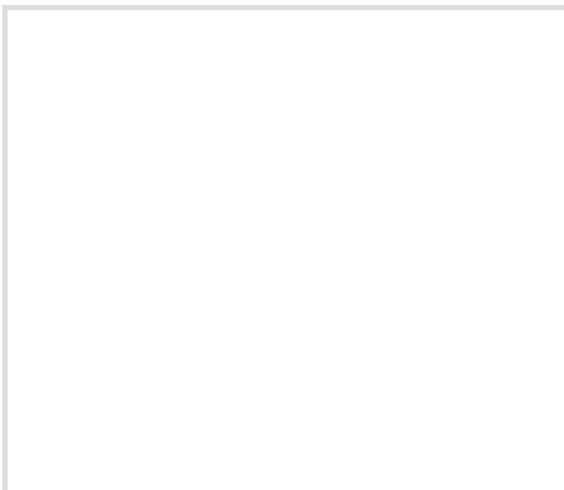

Art. 8615 Angle brackets with 3 and 4 holes at 90°



Technical specifications and advantages

- Made with S235JR steel
- Hot-dip galvanised

Code	Holes	B [mm]	H [mm]	k [mm]	h [mm]	α [°]	s [mm]
8615041	3	99	41	41	15	90	6
8615049	3	91	49	41	23	90	6
8615091	4	100	100	50	29	90	7

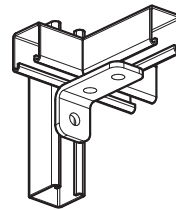
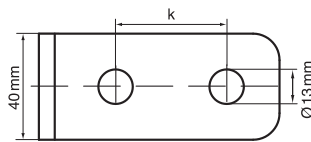
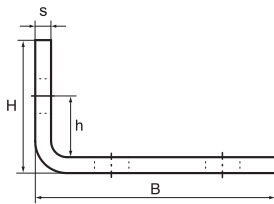

Art. 8618 Reinforced 90° angle bracket



Technical specifications

- Material: S235JR steel
- Hot-dip galvanised

Code	Measurements [mm]
8618090	102 x 86

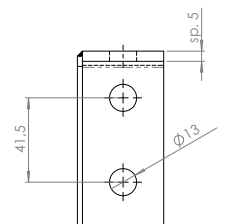
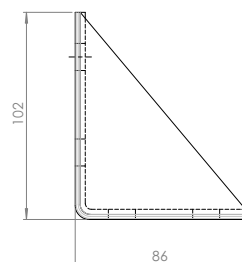
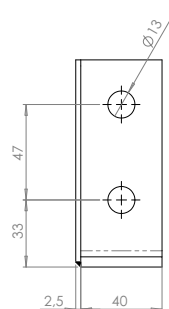
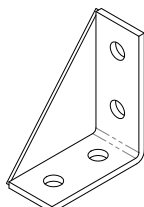

Art. 8600045 45° slotted angle bracket



Technical specifications and advantages

- Made with S235JR steel
- Hot-dip galvanised
- To create connections between fixing rails

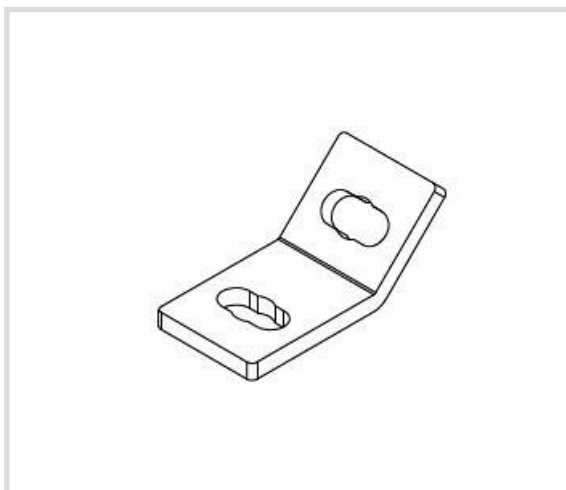
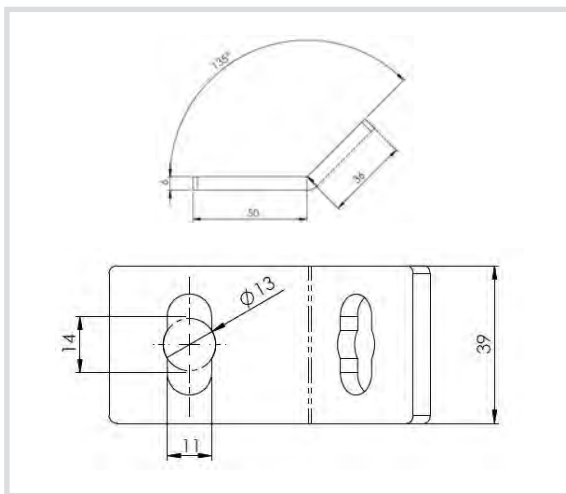

Code	Dimensions [mm]	Thickness S [mm]	Ø Holes [mm]
8600045	50x36	6,0	13

Art. 8645 CorSTRUT rail connector including slide nuts and bolts



Technical specifications and advantages

- Made with 1.0332 steel
- Includes pre-assembled slide nuts to hold the piece in place before final tightening
- Spring: POM (polyoxymethylene), green

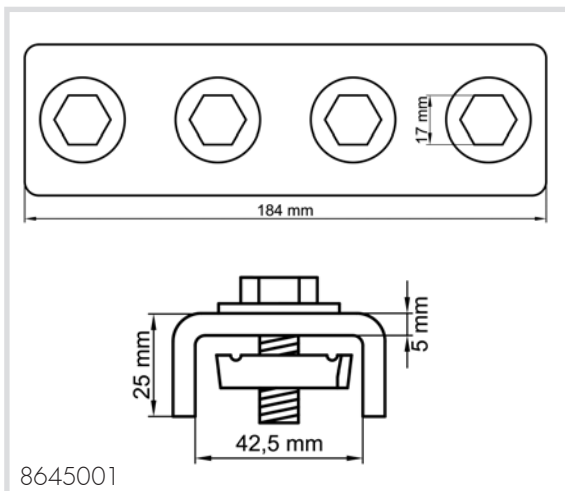

Code	L [mm]	Thickness S [mm]	Bolts
8645001	184	5,0	M10 x 20
8645002	188	6,0	M10x20

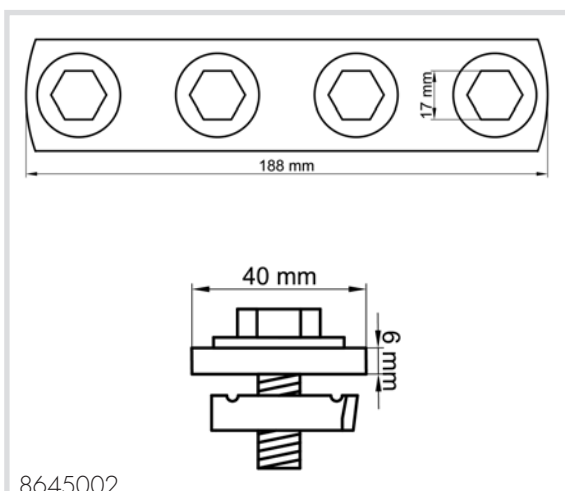

Art. 8636 CorSTRUT rail beam clamp



Technical specifications and advantages

- Made with S235JR steel
- Hot galvanised
- Always use 2 plates for each beam
- To attach fixing rails to a beam without welding or drilling

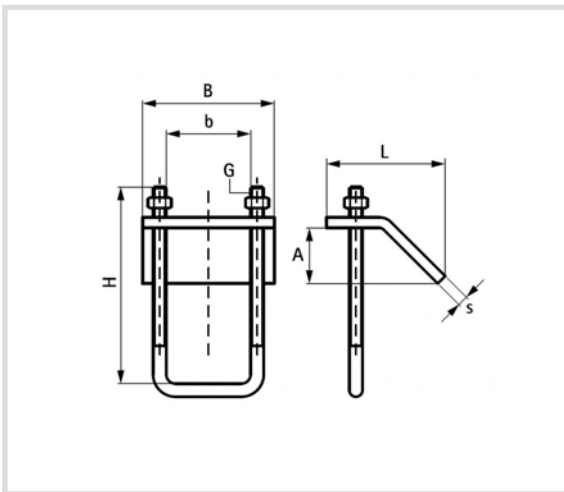

Code	A [mm]	H [mm]	B [mm]	L [mm]	G	S [mm]	Fixing rails	Payload [N]
8636001	<20	85	80	83	M10	5	41x21 e 41x41	5700
8636002	<20	115	80	83	M10	6	41x62 e 41x82	5700

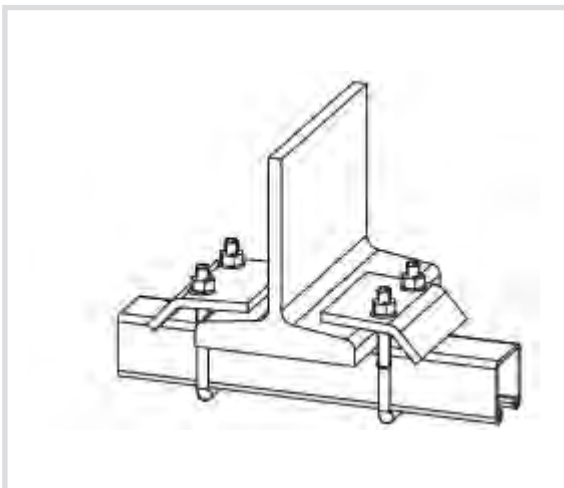

Art. 8637 Clamp for fixing to beams



Technical specifications and advantages

- To connect heavy components
- Material: hot-dip galvanised steel
- For fixing of double Strut 41x(2x21) and 41x(2x41) to beams of up to 35mm thick

Code	T [Nm]	Fa,z [N]	Fa,x [N]
8637000	15	8000	1500

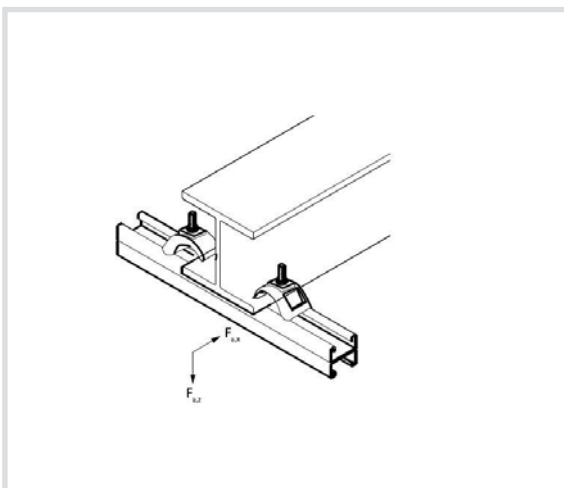
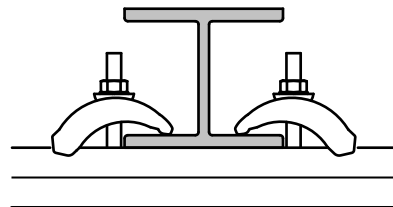
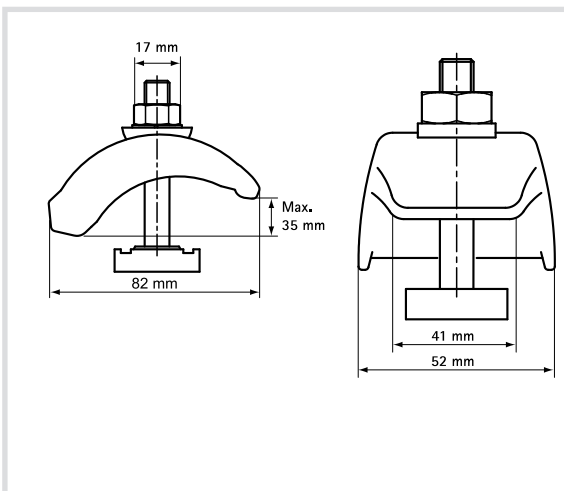

Art. 8619 Clamp for fixing to beams



Technical specifications and advantages

- For fixing to beam without drilling or welding
- Always use 2 clamps to fix
- Material: 1.0332 steel
- Hot-dip galvanised

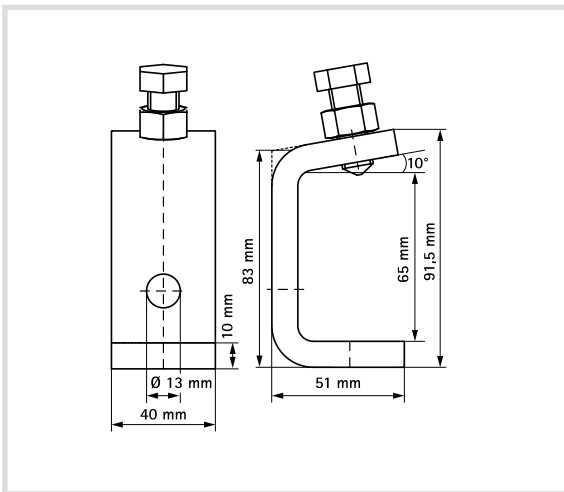

Code	Fixing rail
8619000	41x41

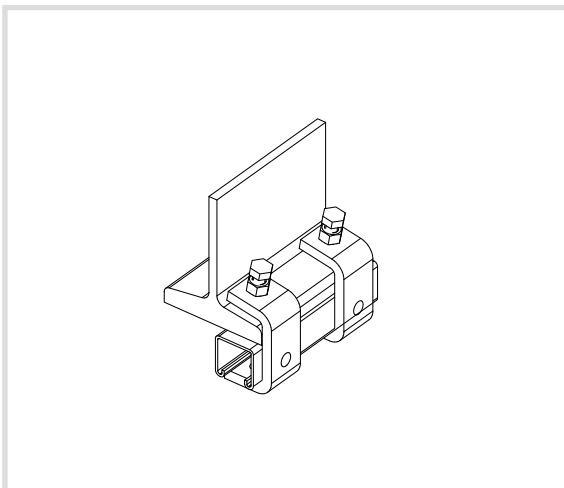

Art. 8616 CorSTRUT straight connection

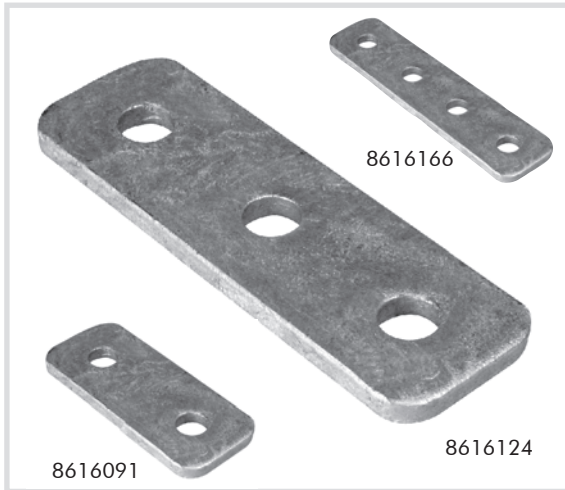

Technical specifications and advantages

- Flat connection
- Material: S235JR steel
- Hot galvanised

Code	L [mm]	Holes
8616091	91	2
8616124	140	3
8616166	166	4

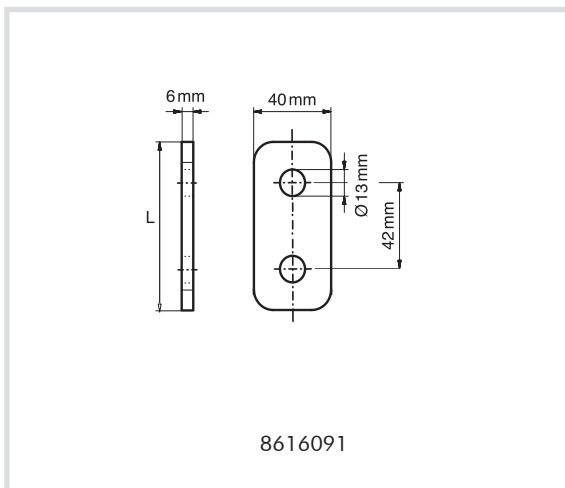
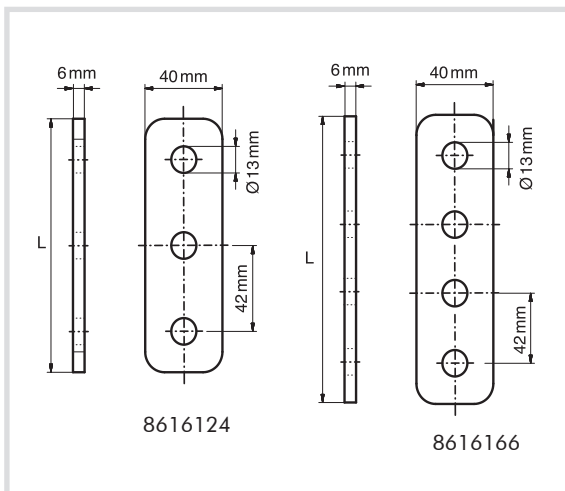

Art. 8614 Angle bracket with 3 holes



Caratteristiche tecniche e vantaggi

- Made with S235JR steel
- Hot-dip galvanised

Code	α (°)
8614030	30
8614045	45
8614060	60

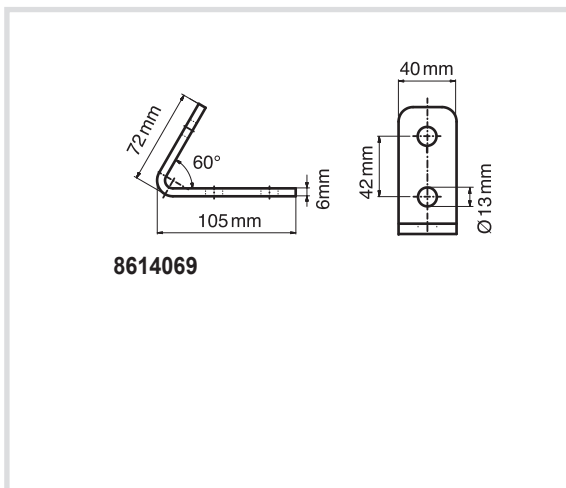
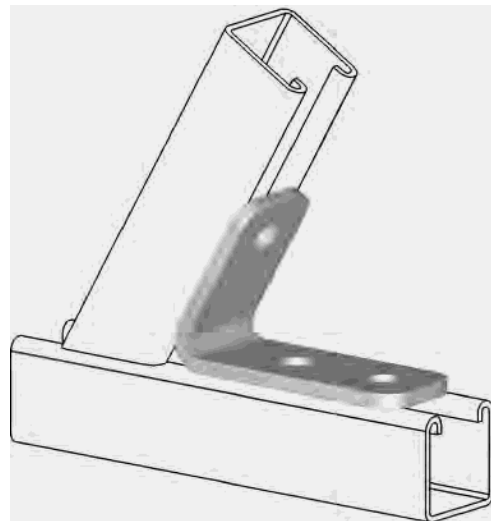
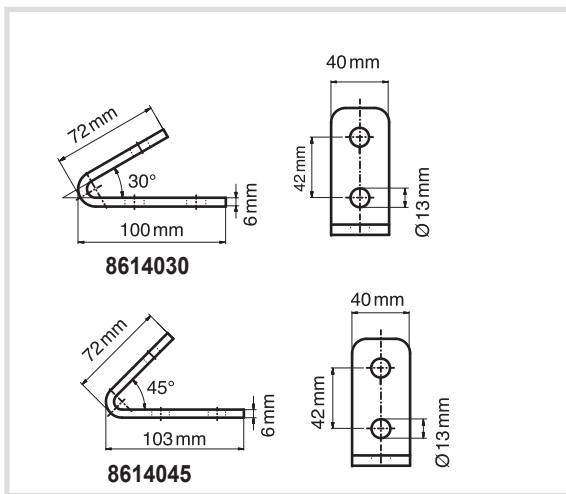

Art. 8638 90° connections



Technical specifications and advantages

- To build structures in CorSTRUT fixing rail
- Easy to assemble, rounded corners
- Material: S235JR steel
- Hot-dip galvanised

Code	Type
8638001	90°
8638002	90°

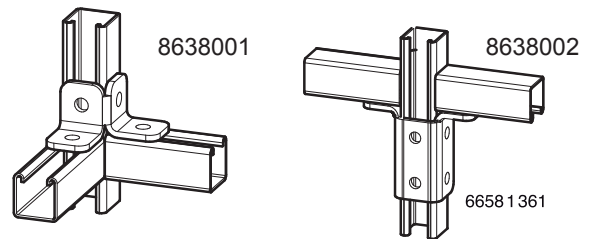
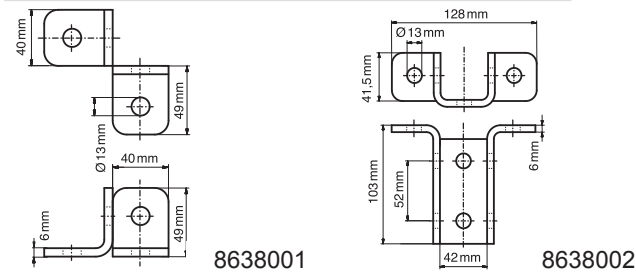

Art. 8639 Open connector



Technical specifications and advantages

- To build structures in CorSTRUT fixing rail
- Material: S235JR steel
- Hot-dip galvanised

Code	Type	
8639150	150°	3 fori
8639151	135°	3 fori
8639152	120°	4 fori
8639153	135°	4 fori

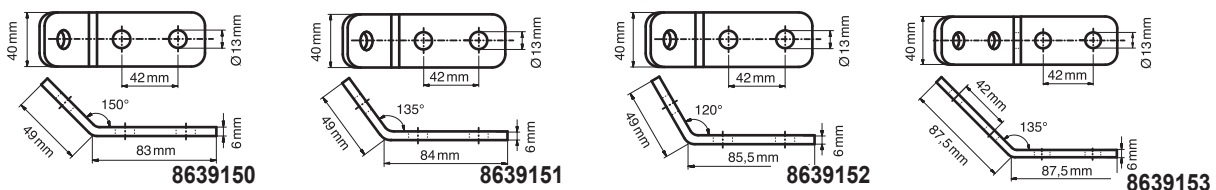

Art. 8640 135° and 90° angled T-connection



Technical specifications and advantages

- To build structures in CorSTRUT fixing rail
- Material: steel
- Hot-dip galvanised

Code	Type
8640135	135°
8640090	90°

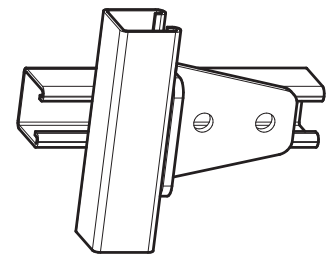
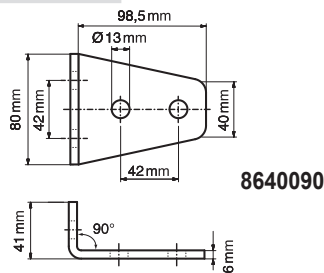
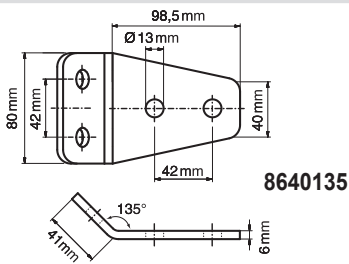

Art. 8641 Z connection



Technical specifications and advantages

- To build structures in CorSTRUT fixing rail
- Material: steel
- Hot-dip galvanised

Code	Fixing rail	H [mm]	h [mm]
8641027	41x21	27,5	21,5
8641047	41x41	47,0	41,0
8641068	41x62	68,0	62,0
8641089	41x82	89,0	83,0

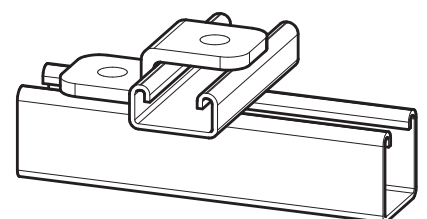
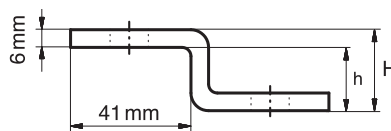
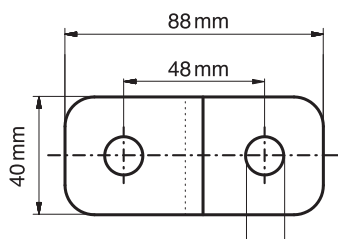

Art. 8643 T and X connections

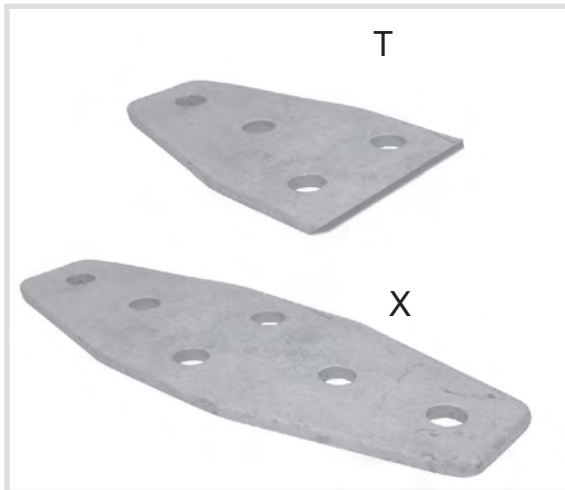

Technical specifications and advantages

- To build structures in CorSTRUT fixing rail
- Material: steel
- Hot-dip galvanised

Code	Type	For
8643001	T	CorSTRUT
8643002	X	CorSTRUT

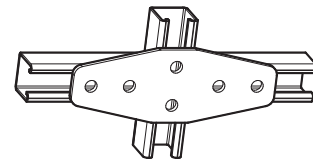
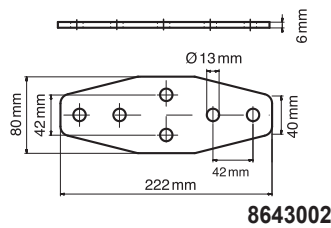
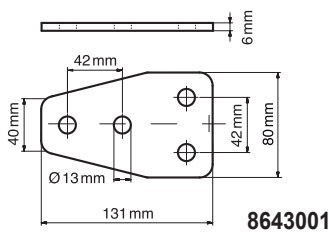

Art. 8642 Rail connector

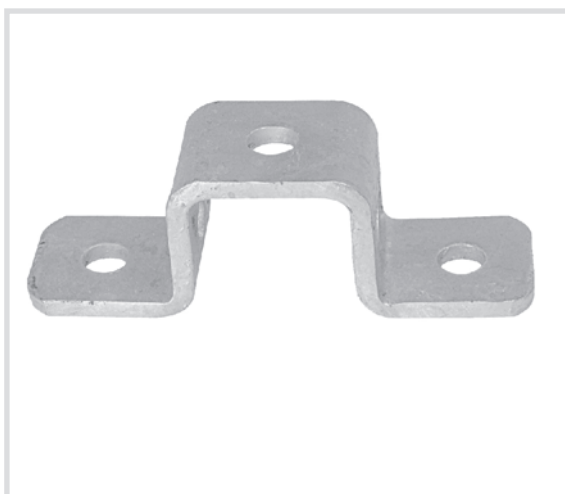

Technical specifications and advantages

- To build structures in CorSTRUT fixing rail
- Material: S235JR steel
- Hot-dip galvanised

Code	Type	H [mm]	h [mm]
8642021	To CorSTRUT 41x21	26	20
8642041	To CorSTRUT 41x41	46	40
8642062	To CorSTRUT 41x62	66	60
8642082	To CorSTRUT 41x82	87	81

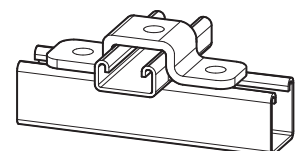
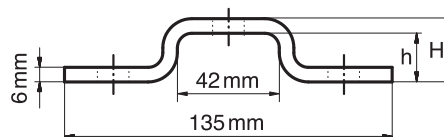
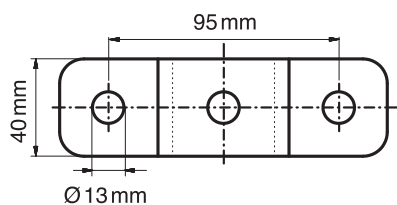

Art. 8626 Angle brackets



Technical specifications and advantages

- To build structures in CorSTRUT fixing rail
- Material: steel
- Hot-dip galvanized

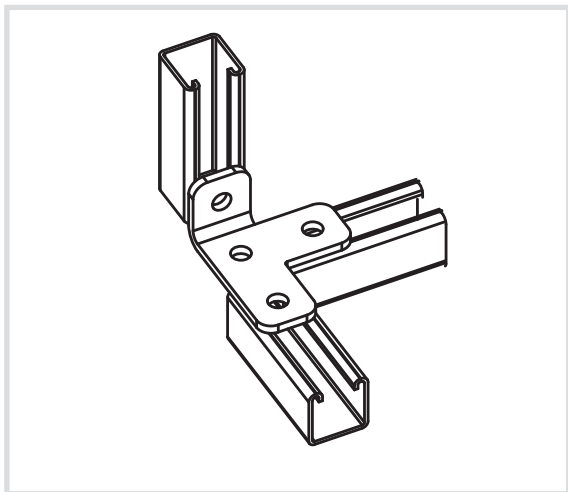
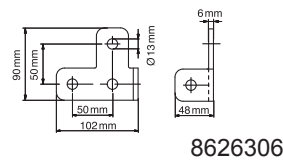

Code	For	α [°]
8626300	CorSTRUT	-
8626305	CorSTRUT	90
8626306	CorSTRUT	90
8626307	CorSTRUT	90

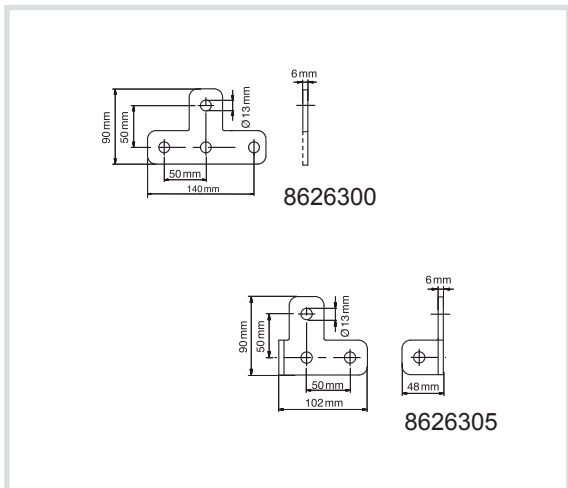

Art. 8644 Rail connectors



Technical specifications and advantages

- To build structures in CorSTRUT fixing rail
- Material: steel
- Hot-dip galvanised



Code	For	α [°]
8644001	CorSTRUT	-
8644002	CorSTRUT	90°
8644003	CorSTRUT	90°

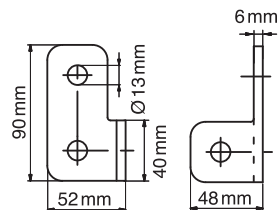

8644002

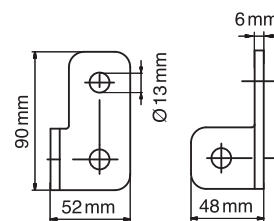

8644003

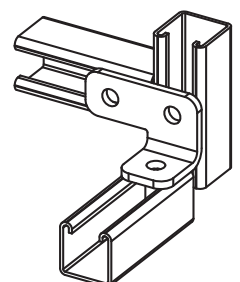

Art. 8627 Fixing for CorSTRUT fixing rails



Technical specifications and advantages

- For connection to a steel structure without drilling or welding
- Material: S235JR steel
- Hot-dip galvanised

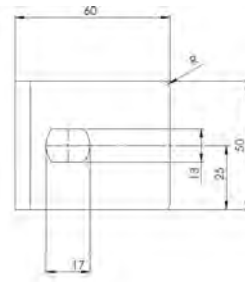
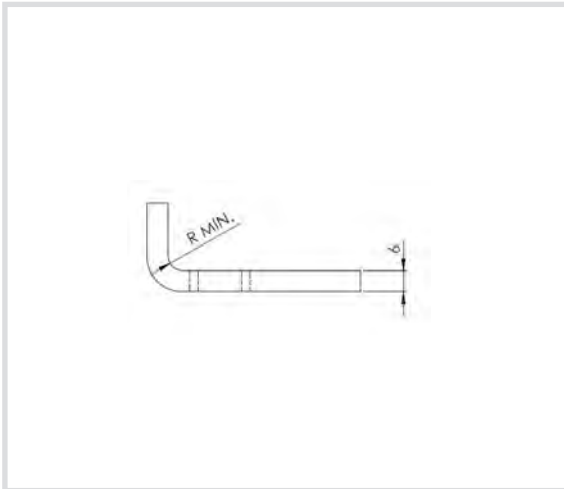

Code	A [mm]
8627001	< 10
8627002	< 15

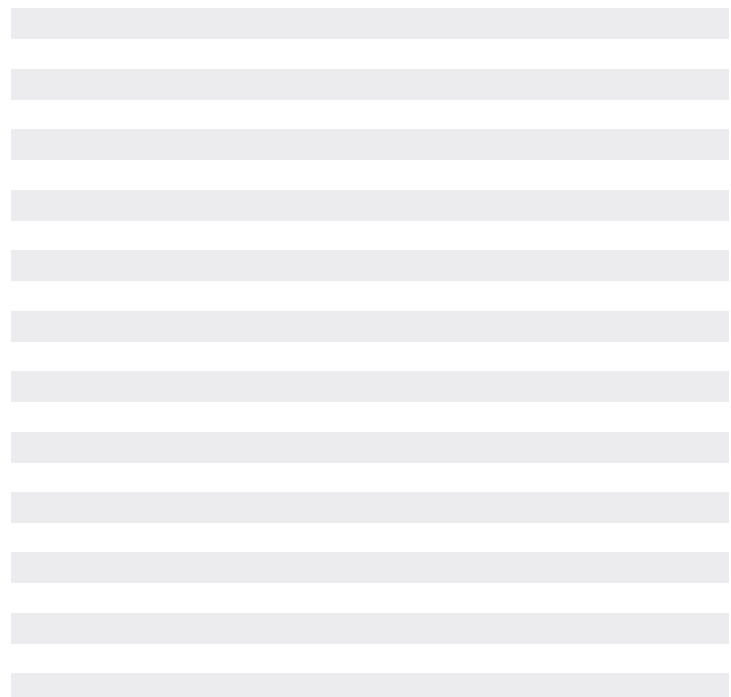
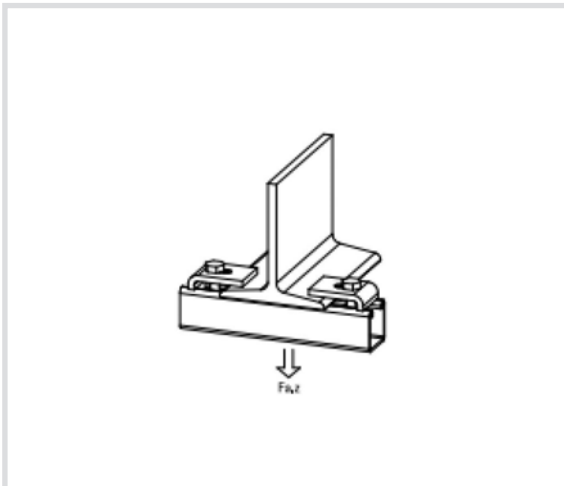

Art. 8628 Fixing with insert for CorSTRUT fixing rails



Technical specifications and advantages

- For connection to a steel structure without drilling or welding
- Material: 1.0332 steel
- Hot-dip galvanised

Code	A [mm]	Payload [N]
8628001	< 10	8000
8628002	< 15	8300

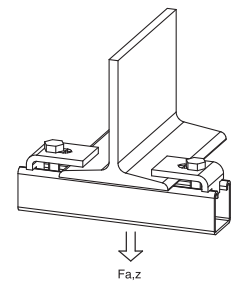
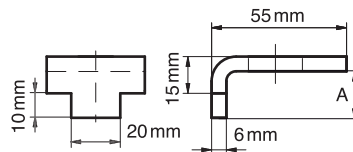
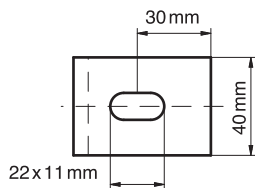

Art. 8126 End cap for CorSTRUT fixing rails



Technical specifications and advantages

- Made with PE (polyethylene)
- Colour: Black
- The function of the cap is decorative and protective: the sharp edges generated by the fixing rail cut are completely covered

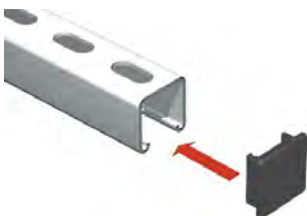

Code	Depth [mm]	For fixing rail	Fixing rail
812621	6	CorSTRUT	41 x 21
812641	12	CorSTRUT	41 x 41

Art. 8629 EPDM sheath for soundproofing of fixing rails and threaded rods



Technical specifications and advantages

- Made of EPDM rubber, black
- Also suitable for M6, M8, M10 threaded rods
- Noise insulation according to DIN 4109
- Resistant to ageing

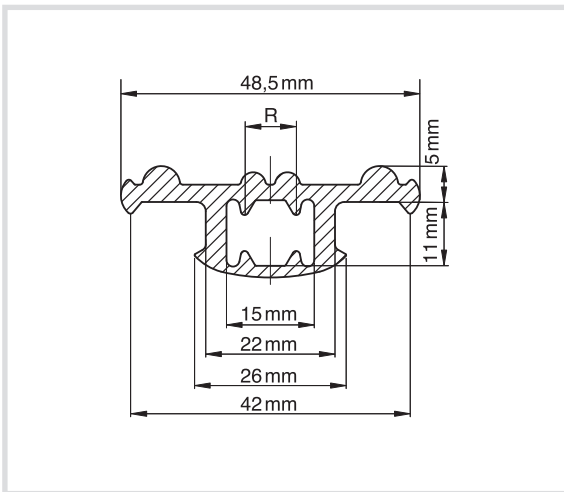

Code	R	Length [m]	Fixing rails
8629000	M6-M10	30	CorSTRUT



Art. 976 Downpipe bracket



Technical specifications and advantages

- Possibility of adjusting the distance
- It is possible to insert bracing to increase the axial resistance
- In galvanised steel
- Components for standard downpipe bracket:
 2 CorSTRUT cantilever arms, 2 special 90° angle brackets, 1 heavy clamp
- In case of downpipe, a heavy clamp may be sufficient as the structure has a guiding function
- Clamp, with or without rubber, not included in the package

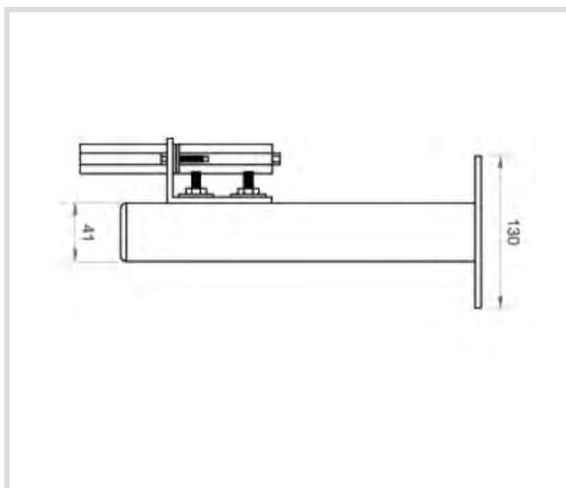
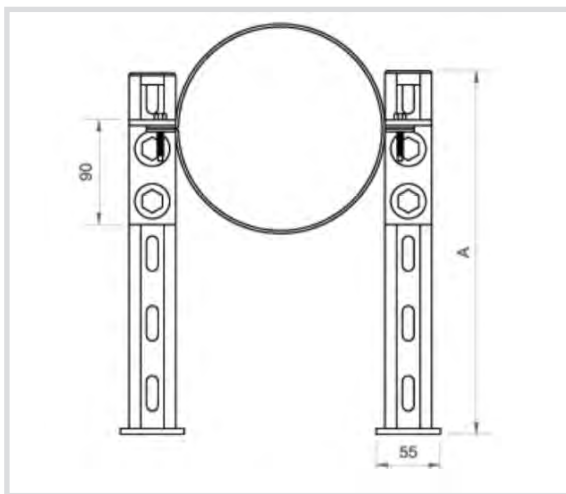

Code	A [mm]
976300	300
976450	450
976600	600

Calculation method

The published payloads are based on tests with perforated fixing rails. For non-perforated fixing rails, the payload is 20% higher than reported.

The loads are calculated considering a maximum deflection (f) of a value equal to $1/200 \times L$ and a maximum bending load of 160 N/mm^2 .

Example: for a length of 500 mm the maximum payload is 1400 N;
 the maximum deflection will be $(1/200 \times 500 \text{ mm}) = 2.5 \text{ mm}$
 $1 \text{ N (Newton)} = 0.102 \text{ kg}$ $1 \text{ kg} = 9.8 \text{ N (Newton)}$

Attaching of the fixing rail to walls or partitions

The anchoring force of the fixing rail has not been taken into consideration.

The installer must check that the screws and anchors used to attach the fixing rail to the wall or ceiling are suitable for the maximum load permitted by the fixing rail.

Loading methods

Where loads are suspended on the fixing rails, the load must not exceed the safe payload of the attachment to the fixing rail. To increase the rigidity of the installation we recommend the use of pre-shaped U washers.

When loading is from above the fixing rail, the possible load is greater than that shown in the tables.

How to read load tables

Where the box is empty, the fixing rail selected for that application cannot be used but one with a higher range must be used.

Special conditions

In case of uncertainty or special conditions not shown in the load tables, do not hesitate to contact our technical department for suggestions and advice.

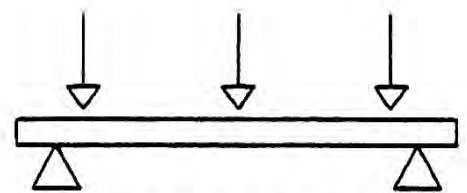
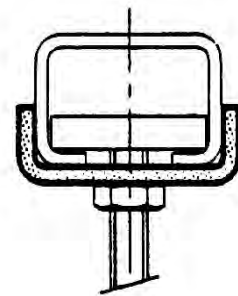
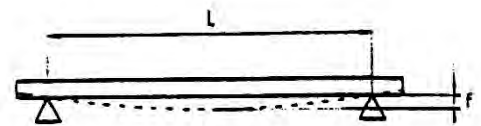

Top loading

CorSTRUT fixing rail

1 point suspension

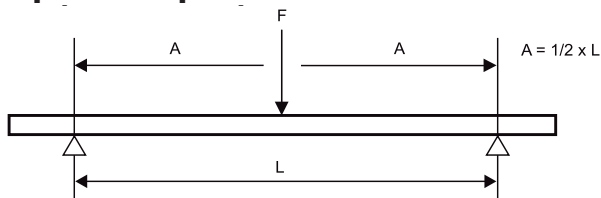

L (mm)	single						
	41x21 1,5	41x21 2,0	41x41 1,5	41x41 2,0	41x41 2,5	41x62 2,5	41x82 2,5
250	1.848	2.381	5.427	6.556	7.611	14.730	23.035
300	1.540	1.984	4.523	5.463	6.342	12.275	19.196
350	1.320	1.701	3.877	4.683	5.436	10.522	16.453
400	1.155	1.488	3.392	4.098	4.757	9.206	14.397
450	1.027	1.323	3.015	3.642	4.228	8.183	12.797
500	924	1.190	2.714	3.278	3.805	7.365	11.517
600	770	992	2.261	2.732	3.171	6.138	9.598
700	660	850	1.938	2.341	2.718	5.261	8.227
800	557	719	1.696	2.049	2.378	4.603	7.198
900	440	568	1.508	1.821	2.114	4.092	6.399
1.000	356	460	1.357	1.639	1.903	3.683	5.759
1.200	247	320	1.131	1.366	1.586	3.069	4.799
1.400	182	235	969	1.171	1.359	2.630	4.113
1.600	139	180	794	952	1.114	2.302	3.599
1.800	110	142	628	752	881	2.046	3.199
2.000	89	115	508	609	713	1.841	2.879
2.250	70	91	402	481	564	1.624	2.559
2.500	57	74	325	390	456	1.315	2.303
2.750	47	61	269	322	377	1.087	2.094
3.000	40	51	226	271	317	913	1.890
3.250	34	44	193	231	270	778	1.611
3.500	29	38	166	199	233	671	1.389
3.750	25	33	145	173	203	584	1.210
4.000	22	29	127	152	178	514	1.063
4.250	20	25	113	135	158	455	942
4.500	18	23	100	120	141	406	840
4.750	16	20	90	108	126	364	754
5.000	14	18	81	97	114	329	680
5.250	13	17	74	88	104	298	617
5.500	12	15	67	81	94	272	562
5.750	11	14	62	74	86	249	515
6.000	-	13	56	68	79	228	473

double			
41x21D	41x41D	41x62D	41x82D
7.081	22.804	32.686	42.030
5.901	19.004	27.238	35.025
5.058	16.289	23.347	30.021
4.426	14.253	20.429	26.269
3.934	12.669	18.159	23.350
3.540	11.402	16.343	21.015
2.950	9.502	13.619	17.513
2.529	8.144	11.674	15.011
2.213	7.126	10.214	13.134
1.967	6.335	9.079	11.675
1.770	5.701	8.172	10.508
1.475	4.751	6.810	8.756
1.264	4.072	5.837	7.505
1.015	3.563	5.107	6.567
802	3.167	4.540	5.838
650	2.851	-	-
513	2.534	-	-
416	2.280	-	-
344	2.073	-	-
289	1.864	-	-
246	1.588	-	-
212	1.370	-	-
185	1.193	-	-
162	1.049	-	-
144	929	-	-
128	828	-	-
115	744	-	-
104	671	-	-
94	609	-	-
86	555	-	-
79	507	-	-
72	466	-	-

Maximum payload in N.

**The values reported are only valid for the fixing rail.
The maximum payload of all the other construction parts must be verified.**

CorSTRUT fixing rail

2 equal loads

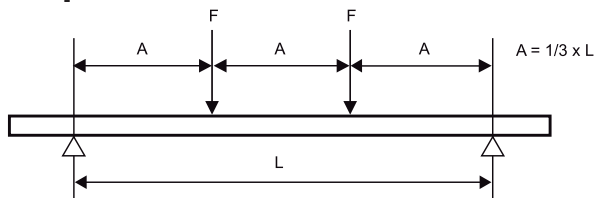

L (mm)	single						
	41x21 1,5	41x21 2,0	41x41 1,5	41x41 2,0	41x41 2,5	41x62 2,5	41x82 2,5
250	1.386	1.786	4.070	4.917	5.708	11.048	17.276
300	1.155	1.488	3.392	4.098	4.757	9.206	14.397
350	990	1.275	2.907	3.512	4.077	7.891	12.340
400	866	1.116	2.544	3.073	3.568	6.905	10.798
450	770	992	2.261	2.732	3.171	6.138	9.598
500	693	893	2.035	2.459	2.854	5.524	8.638
600	578	744	1.696	2.049	2.378	4.603	7.198
700	427	552	1.454	1.756	2.039	3.946	6.170
800	327	422	1.272	1.537	1.784	3.452	5.399
900	258	334	1.131	1.366	1.586	3.069	4.799
1.000	209	270	1.018	1.229	1.427	2.762	4.319
1.200	145	188	829	993	1.163	2.302	3.599
1.400	107	138	609	730	854	1.973	3.085
1.600	82	106	466	559	654	1.726	2.699
1.800	65	83	368	442	517	1.489	2.399
2.000	52	68	298	358	419	1.206	2.160
2.250	41	53	236	283	331	953	1.920
2.500	33	43	191	229	268	772	1.598
2.750	28	36	158	189	221	638	1.320
3.000	23	30	133	159	186	536	1.109
3.250	20	26	113	135	159	457	945
3.500	17	22	97	117	137	394	815
3.750	15	19	85	102	119	343	710
4.000	13	17	75	89	105	302	624
4.250	12	15	66	79	93	267	553
4.500	10	13	59	71	83	238	493
4.750	-	12	53	63	74	214	443
5.000	-	11	48	57	67	193	399
5.250	-	-	43	52	61	175	362
5.500	-	-	39	47	55	159	330
5.750	-	-	36	43	51	146	302
6.000	-	-	33	40	47	134	277

double			
41x21D	41x41D	41x62D	41x82D
5.311	17.103	24.515	31.523
4.426	14.253	20.429	26.269
3.793	12.217	17.510	22.516
3.319	10.690	15.322	19.702
2.950	9.502	13.619	17.513
2.655	8.552	12.257	15.761
2.213	7.126	10.214	13.134
1.897	6.108	8.755	11.258
1.660	5.345	7.661	9.851
1.475	4.751	6.810	8.756
1.328	4.276	6.129	7.881
1.059	3.563	5.107	6.567
778	3.054	4.378	5.629
596	2.672	3.830	4.925
471	2.375	3.405	4.378
381	2.138	-	-
301	1.900	-	-
244	1.576	-	-
202	1.302	-	-
169	1.094	-	-
144	932	-	-
124	804	-	-
108	700	-	-
95	615	-	-
84	545	-	-
75	486	-	-
68	436	-	-
61	394	-	-
55	357	-	-
50	326	-	-
46	298	-	-
42	274	-	-

Max payload in N. Suspension for point (F)

**The values reported are only valid for the fixing rail.
The maximum payload of all the other construction parts must be verified.**

CorSTRUT fixing rail

3 equal loads

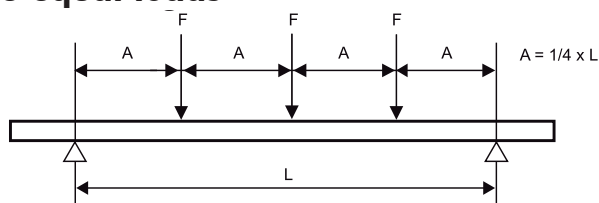

L (mm)	single						
	41x21 1,5	41x21 2,0	41x41 1,5	41x41 2,0	41x41 2,5	41x62 2,5	41x82 2,5
250	924	1,190	2,714	3,278	3,805	7,365	11,517
300	770	992	2,261	2,732	3,171	6,138	9,598
350	660	850	1,938	2,341	2,718	5,261	8,227
400	578	744	1,696	2,049	2,378	4,603	7,198
450	513	661	1,508	1,821	2,114	4,092	6,399
500	462	595	1,357	1,639	1,903	3,683	5,759
600	385	496	1,131	1,366	1,586	3,069	4,799
700	306	396	969	1,171	1,359	2,630	4,113
800	234	303	848	1,024	1,189	2,302	3,599
900	185	239	754	911	1,057	2,046	3,199
1,000	150	194	678	820	951	1,841	2,879
1,200	104	135	565	683	793	1,534	2,399
1,400	77	99	437	524	613	1,315	2,057
1,600	59	76	335	401	469	1,151	1,800
1,800	46	60	264	317	371	1,023	1,600
2,000	38	48	214	257	300	865	1,440
2,250	30	38	169	203	237	684	1,280
2,500	24	31	137	164	192	554	1,146
2,750	20	26	113	136	159	458	947
3,000	17	22	95	114	133	385	796
3,250	14	18	81	97	114	328	678
3,500	12	16	70	84	98	283	585
3,750	11	14	61	73	85	246	509
4,000	-	12	54	64	75	216	448
4,250	-	11	47	57	67	192	397
4,500	-	-	42	51	59	171	354
4,750	-	-	38	45	53	153	317
5,000	-	-	34	41	48	138	287
5,250	-	-	31	37	44	126	260
5,500	-	-	28	34	40	114	237
5,750	-	-	26	31	36	105	217
6,000	-	-	24	29	33	96	199

double			
41x21D	41x41D	41x62D	41x82D
3,540	11,402	16,343	21,015
2,950	9,502	13,619	17,513
2,529	8,144	11,674	15,011
2,213	7,126	10,214	13,134
1,967	6,335	9,079	11,675
1,770	5,701	8,172	10,508
1,475	4,751	6,810	8,756
1,264	4,072	5,837	7,505
1,106	3,563	5,107	6,567
983	3,167	4,540	5,838
885	2,851	4,086	5,254
738	2,375	3,405	4,378
558	2,036	2,918	3,753
427	1,782	2,554	3,284
338	1,584	2,270	2,919
274	1,425	-	-
216	1,267	-	-
175	1,130	-	-
145	934	-	-
122	785	-	-
104	669	-	-
89	577	-	-
78	502	-	-
68	441	-	-
61	391	-	-
54	349	-	-
48	313	-	-
44	283	-	-
40	256	-	-
36	234	-	-
33	214	-	-
30	196	-	-

Max payload in N. Suspension for point (F)

The values reported are only valid for the fixing rail.
The maximum payload of all the other construction parts must be verified.

CorSTRUT fixing rail

Load distributed uniformly

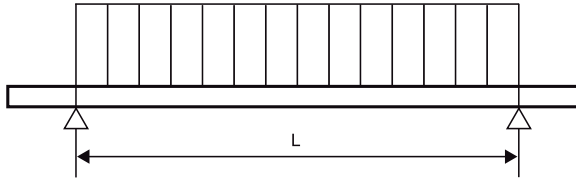

L (mm)	single						
	41x21 1,5	41x21 2,0	41x41 1,5	41x41 2,0	41x41 2,5	41x62 2,5	41x82 2,5
250	3.697	4.762	10.854	13.112	15.222	29.460	46.070
300	3.081	3.968	9.045	10.927	12.685	24.550	38.391
350	2.640	3.401	7.753	9.366	10.873	21.043	32.907
400	2.310	2.976	6.784	8.195	9.514	18.413	28.794
450	2.054	2.645	6.030	7.285	8.457	16.367	25.594
500	1.848	2.381	5.427	6.556	7.611	14.730	23.035
600	1.540	1.984	4.523	5.463	6.342	12.275	19.196
700	1.163	1.503	3.877	4.683	5.436	10.522	16.453
800	891	1.151	3.392	4.098	4.757	9.206	14.397
900	704	909	3.015	3.642	4.228	8.183	12.797
1.000	570	737	2.714	3.278	3.805	7.365	11.517
1.200	396	512	2.260	2.708	3.170	6.138	9.598
1.400	291	376	1.660	1.989	2.329	5.261	8.227
1.600	223	288	1.271	1.523	1.783	4.603	7.198
1.800	176	227	1.004	1.204	1.409	4.059	6.399
2.000	143	184	814	975	1.141	3.288	5.759
2.250	113	146	643	770	902	2.598	5.119
2.500	91	118	521	624	730	2.104	4.355
2.750	75	97	430	516	604	1.739	3.599
3.000	63	82	362	433	507	1.461	3.024
3.250	54	70	308	369	432	1.245	2.577
3.500	47	60	266	318	373	1.074	2.222
3.750	41	52	231	277	325	935	1.936
4.000	36	46	203	244	285	822	1.701
4.250	32	41	180	216	253	728	1.507
4.500	28	36	161	193	225	649	1.344
4.750	25	33	144	173	202	583	1.206
5.000	23	29	130	156	183	526	1.089
5.250	21	27	118	141	166	477	988
5.500	19	24	108	129	151	435	900
5.750	17	22	98	118	138	398	823
6.000	16	20	90	108	127	365	756

double			
41x21D	41x41D	41x62D	41x82D
14.162	45.609	65.372	84.060
11.802	38.007	54.477	70.050
10.116	32.578	46.694	60.043
8.851	28.506	40.858	52.538
7.868	25.338	36.318	46.700
7.081	22.804	32.686	42.030
5.901	19.004	27.238	35.025
5.058	16.289	23.347	30.021
4.426	14.253	20.429	26.269
3.934	12.669	18.159	23.350
3.540	11.402	16.343	21.015
2.887	9.502	13.619	17.513
2.121	8.144	11.674	15.011
1.624	7.126	10.214	13.134
1.283	6.335	9.079	11.675
1.039	5.701	-	-
821	5.068	-	-
665	4.295	-	-
550	3.549	-	-
462	2.983	-	-
394	2.541	-	-
339	2.191	-	-
296	1.909	-	-
260	1.678	-	-
230	1.486	-	-
205	1.326	-	-
184	1.190	-	-
166	1.074	-	-
151	974	-	-
137	887	-	-
126	812	-	-
115	746	-	-

Max payload in N. Suspension for point (F)

**The values reported are only valid for the fixing rail.
The maximum payload of all the other construction parts must be verified.**

CorSTRUT cantilever arm

1 point suspension

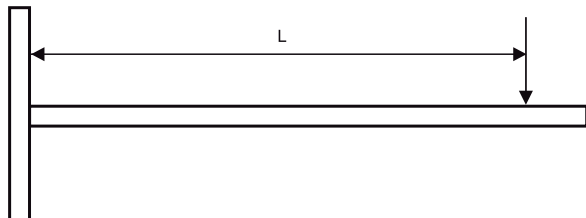

L (mm)	single						
	41x21 1,5	41x21 2,0	41x41 1,5	41x41 2,0	41x41 2,5	41x62 2,5	41x82 2,5
100	1.155	1.488	3.392	4.098	4.757	9.206	14.397
150	770	992	2.261	2.732	3.171	6.138	9.598
200	557	719	1.696	2.049	2.378	4.603	7.198
250	356	460	1.357	1.639	1.903	3.683	5.759
300	247	320	1.131	1.366	1.586	3.069	4.799
350	182	235	969	1.171	1.359	2.630	4.113
400	139	180	794	952	1.114	2.302	3.599
450	110	142	628	752	881	2.046	3.199
500	89	115	508	609	713	1.841	2.879
550	74	95	420	504	589	1.674	2.618
600	62	80	353	423	495	1.427	2.399
700	45	59	259	311	364	1.048	2.057
800	35	45	199	238	279	803	1.661
900	27	36	157	188	220	634	1.313
1.000	22	29	127	152	178	514	1.063
1.100	18	24	105	126	147	425	879
1.200	15	20	88	106	124	357	738
1.300	13	17	75	90	106	304	629
1.400	11	15	65	78	91	262	542
1.500	-	13	56	68	79	228	473

double			
41x21D	41x41D	41x62D	41x82D
4.426	14.253	20.429	26.269
2.950	9.502	13.619	17.513
2.213	7.126	10.214	13.134
1.770	5.701	8.172	10.508
1.475	4.751	6.810	8.756
1.264	4.072	5.837	7.505
1.015	3.563	5.107	6.567
802	3.167	4.540	5.838
650	2.851	4.086	5.254
537	2.591	3.714	4.776
451	2.375	3.405	4.378
331	2.036	2.918	3.753
254	1.638	2.554	3.284
200	1.295	2.270	2.919
162	1.049	2.043	2.627
134	867	1.857	2.388
113	728	1.702	2.189
96	620	1.571	2.021
83	535	1.459	1.876
72	466	1.362	1.751

Max payload in N.

**The values reported are only valid for the fixing rail.
The maximum payload of all the other construction parts must be verified.**

CorSTRUT cantilever arm

Load distributed uniformly

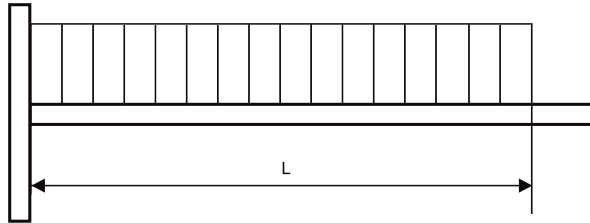

L (mm)	single						
	41x21 1,5	41x21 2,0	41x41 1,5	41x41 2,0	41x41 2,5	41x62 2,5	41x82 2,5
100	2,310	2,976	6,784	8,195	9,514	18,413	28,794
150	1,540	1,984	4,523	5,463	6,342	12,275	19,196
200	1,155	1,488	3,392	4,098	4,757	9,206	14,397
250	924	1,190	2,714	3,278	3,805	7,365	11,517
300	660	853	2,261	2,732	3,171	6,138	9,598
350	485	626	1,938	2,341	2,718	5,261	8,227
400	371	480	1,696	2,049	2,378	4,603	7,198
450	293	379	1,508	1,821	2,114	4,092	6,399
500	238	307	1,356	1,625	1,902	3,683	5,759
550	196	254	1,121	1,343	1,572	3,348	5,235
600	165	213	942	1,128	1,321	3,069	4,799
700	121	157	692	829	970	2,630	4,113
800	93	120	530	635	743	2,140	3,599
900	73	95	418	501	587	1,691	3,199
1,000	59	77	339	406	476	1,370	2,835
1,100	49	63	280	336	393	1,132	2,343
1,200	41	53	235	282	330	951	1,969
1,300	35	45	201	240	281	811	1,678
1,400	30	39	173	207	243	699	1,447
1,500	26	34	151	181	211	609	1,260

double			
41x21D	41x41D	41x61D	41x81D
8,851	28,506	40,858	52,538
5,901	19,004	27,238	35,025
4,426	14,253	20,429	26,269
3,540	11,402	16,343	21,015
2,950	9,502	13,619	17,513
2,529	8,144	11,674	15,011
2,213	7,126	10,214	13,134
1,967	6,335	9,079	11,675
1,732	5,701	8,172	10,508
1,432	5,183	7,429	9,552
1,203	4,751	6,810	8,756
884	4,072	5,837	7,505
677	3,563	5,107	6,567
535	3,167	4,540	5,838
433	2,796	4,086	5,254
358	2,311	3,714	4,776
301	1,942	3,405	4,378
256	1,655	3,143	4,041
221	1,427	2,918	3,753
192	1,243	2,724	3,503

Max payload in N.

**The values reported are only valid for the fixing rail.
The maximum payload of all the other construction parts must be verified.**