

Art. 865X100 Pre-assembled universal seismic brace hot-dip galvanised

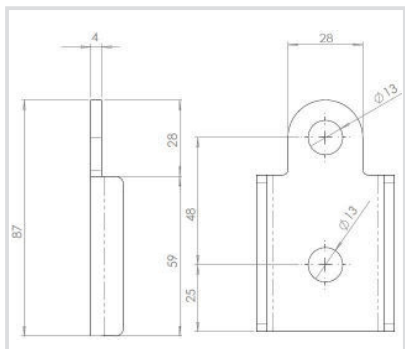

Technical features and advantages

- Anti-seismic hinge with pre-assembled reinforcement, suitable for anti-seismic support of systems
- Can be used to create bracing with profiles
- Adjustable angle
- Meets the requirements of anti-seismic reinforcements
- Material: AISI 304 stainless steel
- Easy installation
- Suitable for all CorSTRUT profiles

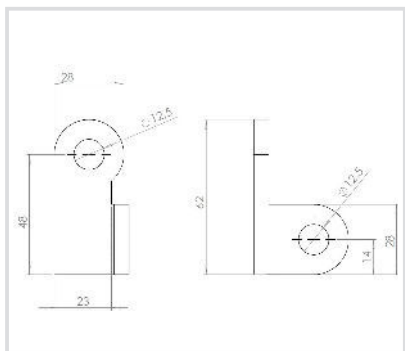

Code	Profiles
865X100	CorSTRUT

